

LSC Plug-in lighting system

Easy installation
for pluggable
lighting power
distribution



EATON

Powering Business Worldwide

Eaton's LSC Plug-in lighting system

Luminaire Supporting Couplers (LSC) complying with BS7001 are recognised as the industry standard interface, offering complete interchangeability with other manufacturers' products to this standard. Eaton offers both 3 and 4 pin LSC units, with or without cables, and a choice of either Heat Resistant PVC (HR), or Low Smoke and Fume (LSF) cables fitted.

Both versions provide considerable benefits for the specifier, contractor and end user. LSC represents a significant advance in the safety and ease of installation of lighting points.

Simple. Quick. Easy.

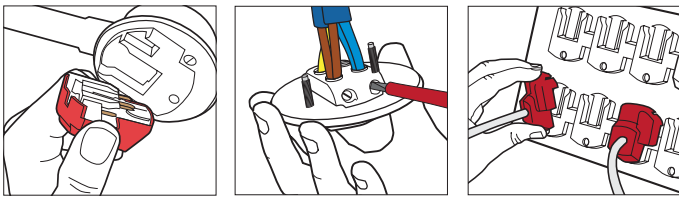

Back to the Future

The LSC range is already an established product within the plug-in lighting arena. Most recent improvements centre on the back of the product, making it even easier to install. Large back facing terminals are supplied with the screws withdrawn ready to accept the conductors. Designed to take 2 x 4mm² cables easily, the terminals are supplied with large screwheads enabling complete installation using just one screwdriver.

The Industry Standard

The BS 7001 LSC (Luminaire Supporting Coupler) system is recognised as the industry standard interface, offering complete interchangeability with many other manufacturers' products. Look to the future and insist on a system complying with BS6972 and BS7001.

Pre-wired products

Eaton LSC products can be supplied complete pre-fitted with either Heat Resisting PVC (HR) or Low Smoke and Fume (LSF) cables to meet the increasing customer demand for the added protection and safety provided by LSF cable. LSC products are available with 1, 2 or 3 meter leads in 0.75 mm² and 1.00 mm² CSA.

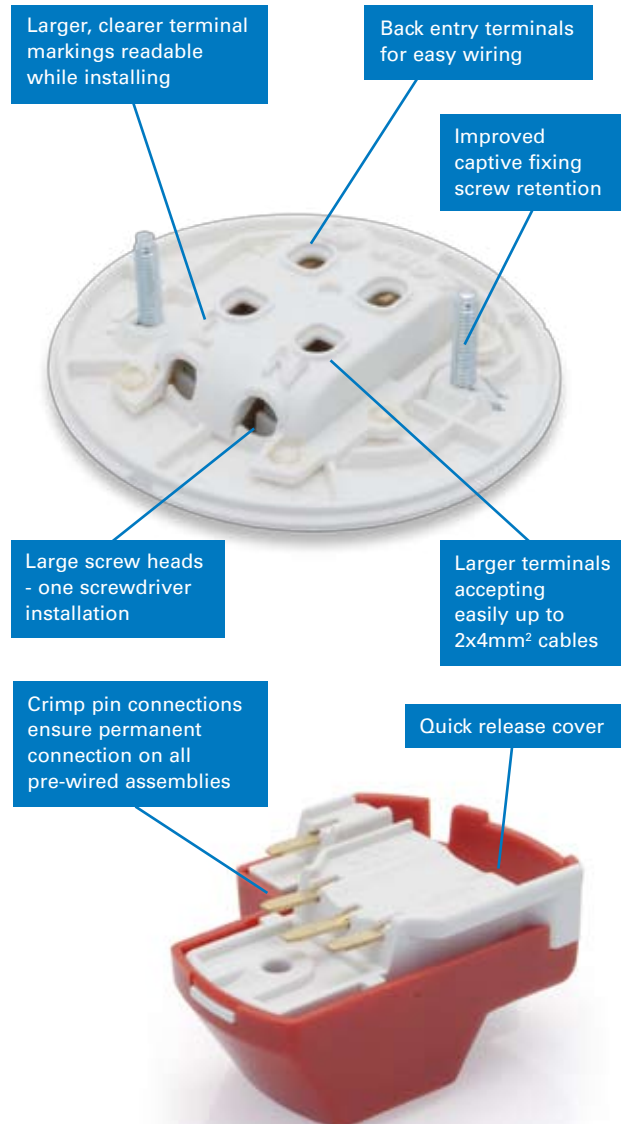

LSC Plug-in lighting system



3 Pin System

This version has a wide range of applications in many domestic, commercial and industrial environments. Its technical and design features are supplemented with a full range of plug and outlet assemblies, pendants and multi-outlet boxes. In use, it provides flexibility for the specifier, easy installation for the contractor and convenience for the end users.

- 3 pin plugs can also be used safely in 4 pin outlets
- LSC pre-wired ceiling assembly with 2 or 3m of cable, ideal for suspended ceiling lighting
- Spacious easy wire plug with quick cover release screws
- Outlets will take up to 2 x 4.00mm² cables
- Complies with BS6972 and BS7001

4 Pin System

This version has been specifically designed for applications where an extra live conductor is required e.g. maintained live for emergency lighting. It has all the benefits of the 3 pin system, but the auxiliary live conductor gives greater flexibility in switching capabilities and offers greater control over multi lamp luminaires.

- Red plug top and cover ensures easy identification of 4 pin circuit
- Complies with BS6972 and BS7001
- Large outlet terminals will take up to 2 x 4.00mm² cable
- Terminal access designed to aid cable installation

LDU Multi-outlet Box

The LDU Multi-outlet boxes utilise the LSC 'plug-in' lighting interface allowing luminaires to be plugged in, providing safety without isolation of the circuit. The LDU (Lighting Distribution Unit) incorporates LSC outlets which accept both Eaton's 3 and 4 pin plugs.

The 4 pin plug uses the fourth auxiliary socket contact for emergency lighting requirements.

- 6, 8, 10 and 12 way Lighting Distribution Units (LDU) available
- Will accommodate 3 or 4 pin applications
- Separate back box to enable first fix with simple plug connectors for front cover
- Complies with BS5733 and the recognised industry interface BS7001
- Extensive range of pre-wired plugs available in both HR (Heat Resistant) and LSF (Low Smoke and Fume) cable
- Mounting options – wall, ceiling, trunking or suspension
- Makes life easy – no need for on-site wiring of individual fittings
- Steel box for harsh environments
- Interchangeable front covers (6/8 way and 10/12 way) to enable, if required, expansion at a later date

LSC Plug-in lighting system

3 and 4 pin system

F8501



LSC ceiling assembly

- BS 6972: 1988 and BS 7001: 1998.
- Rated 6A with outlets capable of installation on a 16A lighting circuit.
- Coupler supports loads up to 5kg.
- Base terminals will accept 2 x 4.0mm² incoming cables.
- Heat resisting cable is to BS 6141.
- Fixing centres 50.8mm.

F8570



Description

Eaton list number

Description	Eaton list number
3 pin LSC ceiling assembly (ceiling outlet, plug, cover)	F8501
3 pin assembly c/w 2 mtrs 0.75mm ² HR (heat resistant) cable	F8570
3 pin assembly c/w 2 mtrs 1.00mm ² HR (heat resistant) cable	F8571
3 pin assembly c/w 3 mtrs 0.75mm ² HR (heat resistant) cable	F8572
3 pin assembly c/w 3 mtrs 1.00mm ² HR (heat resistant) cable	F8573
3 pin assembly c/w 2 mtrs 0.75mm ² LSF (low smoke and fume) cable	F8580
3 pin assembly c/w 2 mtrs 1.00mm ² LSF (low smoke and fume) cable	F8581
3 pin assembly c/w 3 mtrs 0.75mm ² LSF (low smoke and fume) cable	F8582
3 pin assembly c/w 3 mtrs 1.00mm ² LSF (low smoke and fume) cable	F8583
3 pin assembly c/w 1 mtr 1.00mm ² LSF (low smoke and fume) cable	F8584

F8502



LSC ceiling outlet

- To BS 6972: 1988 and BS 7001: 1988.
- Large outlet terminals will take up to 2 x 4.0mm² cable.
- Flush mounting box for F8502 is a standard BESA circular box (27mm deep).

Description

Eaton list number

Description	Eaton list number
3 pin LSC ceiling outlet	F8502

F8540



3 pin system LSC plug

- To BS 6972: 1988 and BS 7001: 1988.

Description

Eaton list number

Description	Eaton list number
3 pin LSC re-wireable plug	F8540

F8534



Ceiling LSC covers

- Ceiling cover provide extra protection for the outlets.
- Red covers allow for easy identification of a 4 pin circuit.

Description

Eaton list number

Description	Eaton list number
Ceiling rose cover – white	F8534
Ceiling rose cover – red	F8635

LDU6



LDU multi-outlet boxes

- To BS 5733.
- Large outlet terminals will take up to 2 x 2.5mm² incoming cables.
- Dimensions: 6/8 LDU Length: 255mm, width: 168mm, depth: 58mm.
10/12 LDU Length: 255mm, width: 247mm, depth: 58mm.
- Removable links allow each row to be switched separately.

Description

Eaton list number

Description	Eaton list number
6G LSC outlet unit – 4 pin	LDU6
8G LSC outlet unit – 4 pin	LDU8
10G LSC outlet unit – 4 pin	LDU10
12G LSC outlet unit – 4 pin	LDU12

F8602



4 pin LSC ceiling outlets

- Red plug allows easy identification of a 4 pin circuit.
- Height: 46mm, diameter 85mm.
- Rated 6A with outlets capable of installation on a 16A lighting circuit.
- Coupler supports loads up to 5kg.
- Outlet terminals will accept 2 x 4.0mm² incoming cables.
- Heat resisting cable attached is to BS 6141.
- Fixing centres 50.8mm.

F8671



Description

Description	Eaton list number
4 pin LSC ceiling assembly (ceiling outlet, plug, cover)	F8601
4 pin LSC ceiling outlet	F8602
4 pin LSC ceiling assembly with red ceiling rose cover	F8603
4 pin assembly c/w 2 mtrs 1.00mm ² HR (heat resistant) cable	F8671
4 pin assembly c/w 3 mtrs 1.00mm ² HR (heat resistant) cable	F8672
4 pin assembly c/w 2 mtrs 1.00mm ² LSF (low smoke and fume) cable	F8681
4 pin assembly c/w 3 mtrs 1.00mm ² LSF (low smoke and fume) cable	F8682
4 pin assembly c/w 1 mtr 1.00mm ² LSF (low smoke and fume) cable	F8684

F8641



4 pin system LSC plugs

- To BS 6972: 1988 and BS 7001: 1988.

Description

Description	Eaton list number
4 pin LSC re-wireable plug – white cover	F8641
4 pin LSC re-wireable plug – red cover	F8640

F8640



FP320



3 pin plugs c/w cable

- 3 pin = live, neutral and earth.

Description

Description	Eaton list number
3 pin plug c/w 2 mtrs HR (heat resistant) 0.75mm ² cable	FP320
3 pin plug c/w 3 mtrs HR (heat resistant) 0.75mm ² cable	FP330
3 pin plug c/w 4 mtrs HR (heat resistant) 0.75mm ² cable	FP340
3 pin plug c/w 2 mtrs HR (heat resistant) 1.00mm ² cable	FP321
3 pin plug c/w 3 mtrs HR (heat resistant) 1.00mm ² cable	FP331
3 pin plug c/w 4 mtrs HR (heat resistant) 1.00mm ² cable	FP341
3 pin plug c/w 5 mtrs HR (heat resistant) 1.00mm ² cable	FP351
3 pin plug c/w 2 mtrs LSF (low smoke and fume) 1.00mm ² cable	FL321
3 pin plug c/w 3 mtrs LSF (low smoke and fume) 1.00mm ² cable	FL331
3 pin plug c/w 4 mtrs LSF (low smoke and fume) 1.00mm ² cable	FL341
3 pin plug c/w 5 mtrs LSF (low smoke and fume) 1.00mm ² cable	FL351

FP421



4 pin plugs c/w cable

- 4 pin = live, neutral, earth and separate live connection for emergency pack equipped luminaires.

Description

Description	Eaton list number
4 pin plug c/w 2 mtrs HR (heat resistant) 1.00mm ² cable	FP421
4 pin plug c/w 3 mtrs HR (heat resistant) 1.00mm ² cable	FP431
4 pin plug c/w 4 mtrs HR (heat resistant) 1.00mm ² cable	FP441
4 pin plug c/w 5 mtrs HR (heat resistant) 1.00mm ² cable	FP451
4 pin plug c/w 2 mtrs LSF (low smoke and fume) 1.00mm ² cable	FL421
4 pin plug c/w 3 mtrs LSF (low smoke and fume) 1.00mm ² cable	FL431
4 pin plug c/w 4 mtrs LSF (low smoke and fume) 1.00mm ² cable	FL441
4 pin plug c/w 5 mtrs LSF (low smoke and fume) 1.00mm ² cable	FL451

Eaton's Electrical Sector is a global leader in power distribution, power quality, control and automation, and monitoring products. When combined with Eaton's full-scale engineering services, these products provide customer-driven PowerChain™ solutions to serve the power system needs of the data center, industrial, institutional, public sector, utility, commercial, residential, IT, mission critical, alternative energy and OEM markets worldwide.

PowerChain™ solutions help enterprises achieve sustainable and competitive advantages through proactive management of the power system as a strategic, integrated asset throughout its life cycle, resulting in enhanced safety, greater reliability and energy efficiency. For more information, visit www.eaton.com/electrical.

Eaton Electric Limited
Grimshaw Lane
Middleton
Manchester M24 1GQ
United Kingdom
Customer Support Centre
Tel: +44 (0)8700 545 333
Fax: +44 (0)8700 540 333
email: ukcommorders@eaton.com

© 2013 Eaton Corporation
All Rights Reserved
Printed in UK
Form No. BR144001EN
February 2013



Powering Business Worldwide

www.eaton.com/uk