



SIGNALLING COLUMN STEADY LIGHT LED BLUE,  
24V AC/DC

General technical details:		
<b>product brand name</b>		SIRIUS
<b>product designation</b>		signaling columns element, optical
<b>Product component / fluorescent materials</b>		Yes
<b>Design of the optical signal</b>		continous light
<b>Type of voltage</b>		
<ul style="list-style-type: none"> <li>• of the operating voltage</li> <li>• of the supply voltage</li> <li>• of the fluorescent material</li> </ul>		AC/DC
		AC/DC
<b>Operating frequency</b>		
<ul style="list-style-type: none"> <li>• 1 / rated value</li> <li>• 2 / rated value</li> </ul>	Hz	50
	Hz	60
<b>Operating voltage</b>		
<ul style="list-style-type: none"> <li>• 1 / for DC / rated value</li> <li>• 1 / at 50 Hz / for AC / rated value</li> <li>• 1 / at 60 Hz / for AC / rated value</li> </ul>	V	24
	V	24
	V	24
<b>Consumed current / for rated value of supply voltage</b>	mA	45
<b>Supply voltage</b>		
<ul style="list-style-type: none"> <li>• 1 / of the fluorescent material / at 50 Hz / for AC / rated value</li> <li>• 1 / of the fluorescent material / at 60 Hz / for AC / rated value</li> </ul>	V	24
	V	24

• 1 / of the fluorescent material / for DC / rated value	V	24
<b>Item designation</b>		
• according to DIN 40719 extendable after IEC 204-2 / according to IEC 750		H
• according to DIN EN 61346-2		P

**Mechanical design:**

<b>Color / of the optical signal element</b>		blue
<b>External diameter / of the signal column element</b>	mm	70

**Lamp:**

<b>Nature of fluorescent material</b>		LED
---------------------------------------	--	-----

**Ambient conditions:**

<b>Ambient temperature</b>		
• during operating	°C	-20 ... +50
<b>Protection class IP</b>		IP65
<b>Depth</b>	mm	70
<b>Height</b>	mm	56
<b>Width</b>	mm	70

**Certificates/approvals:**

General Product Approval	Declaration of Conformity	Shipping Approval
 GOST	 UL	 EG-Konf.
		 BUREAU VERITAS
		 DNV

**Further information:**

- Information- and Downloadcenter (Catalogs, Brochures,...)**  
<http://www.siemens.com/industrial-controls/catalogs>
- 
- Industry Mall (Online ordering system)**  
<http://www.siemens.com/industrial-controls/mall>
- 
- Cax online generator:**  
<http://www.siemens.com/cax>
- 
- Service&Support (Manuals, Certificates, Characteristics, FAQs,...)**  
<http://support.automation.siemens.com/WWW/view/en/8WD4420-5AF/all>
- 
- Image database (product images, 2D dimension drawings, 3D models, device circuit diagrams, ...)**  
[http://www.automation.siemens.com/bilddb/cax\\_en.aspx?mlfb=8WD4420-5AF](http://www.automation.siemens.com/bilddb/cax_en.aspx?mlfb=8WD4420-5AF)

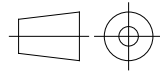
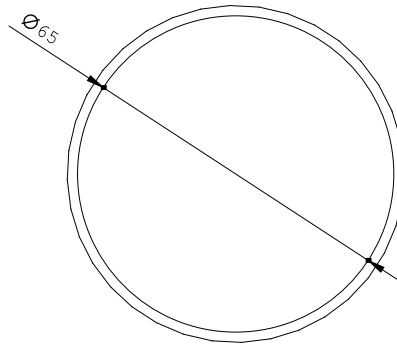
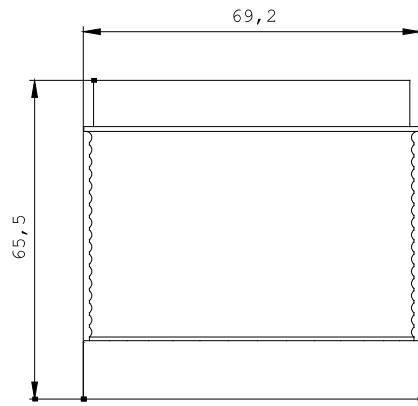

\W9.4444;  
\W6.8333; 8WD44...-

last change:

Jan 30, 2012