



## Electro-mechanical safety switches Safety locking devices, i14 Lock

i14-M0213 Lock



**Model Name** > [i14-M0213 Lock](#)  
**Part No.** > [6025060](#)



**At a glance**

- Compact plastic housing
- 3 M20 x 1.5 cable entry glands
- Locked with spring force
- Lock monitoring
- LED locking indicator
- Mechanical unlocking mechanism on three sides

**Your benefits**

- Cost-effective solution for all standard safety applications
- LED status indicator offers improved diagnostics
- Flexible electrical connectivity due to three cable entry glands
- Easy access to wiring for installation and maintenance due to a hinged cover - access to the unlocking mechanism from three sides
- Small housing saves space and can be mounted in tight areas



**Technical data**

Housing material:	Plastic
Enclosure rating:	IP 65
Ambient operating temperature from ... to:	-20 °C ... 60 °C
B10d parameter:	2* 1E 06 switching cycles, with small load
Locking type:	Mechanical
Maximum locking force:	1,200 N
Number of actuation directions:	3
Approach speed:	10 m/min
Actuation force:	12 N
Switching principle:	Slow action switching element
Number of positive action N/C solenoid monitoring contacts:	2
Number of N/O solenoid monitoring contacts:	1
Number of positive action N/C door monitoring contacts:	0
Number of N/O door monitoring contacts:	0
Number of N/C door monitoring contacts:	0
Mechanical life:	1* 1E 06 switching cycles
Usage category in compliance with IEC/EN 60947-5-1:	AC-15/DC-13

Rated operating current (voltage): 3 A (240 V AC)  
 2 A (24 V DC)

Solenoid operating voltage: 24 V DC

Connection type: Cable gland

Weight: 0.37 kg

### Actuator travel diagram

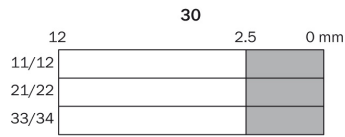
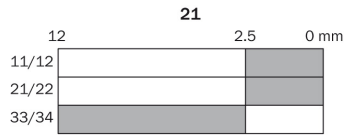

□ Contacts open  
 ■ Contacts closed

### Dimensional drawing

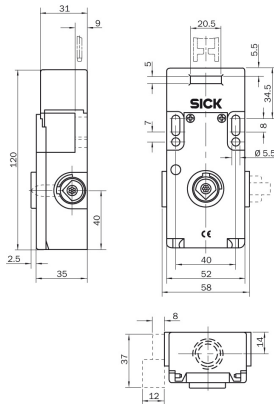

### Switching elements

	Actuator inserted		Actuator removed
	locked	unlocked	
Switching element 21			
	□ 11 ↔ 12 □ 21 ↔ 22 □ 33 ↔ 34	□ 11 ↔ 12 □ 21 ↔ 22 □ 33 ↔ 34	□ 11 ↔ 12 □ 21 ↔ 22 □ 33 ↔ 34
Switching element 30	□ 11 ↔ 12 □ 21 ↔ 22 □ 31 ↔ 32	□ 11 ↔ 12 □ 21 ↔ 22 □ 31 ↔ 32	□ 11 ↔ 12 □ 21 ↔ 22 □ 31 ↔ 32

**Switching element 21:**  
 2 positive action N/C contacts + 1 N/O contact

**Switching element 30:**  
 3 positive action N/C contacts

**Australia**

Phone +61 3 9457 0600  
1800 334 802 – tollfree  
E-Mail sales@sick.com.au

**Belgium/Luxembourg**

Phone +32 (0)2 466 55 66  
E-Mail info@sick.be

**Brasil**

Phone +55 11 3215-4900  
E-Mail sac@sick.com.br

**Canada**

Phone +1(952) 941-6780  
1 800-325-7425 – tollfree  
E-Mail info@sickusa.com

**Ceská Republika**

Phone +420 2 57 91 18 50  
E-Mail sick@sick.cz

**China**

Phone +852-2763 6966  
E-Mail ghk@sick.com.hk

**Danmark**

Phone +45 45 82 64 00  
E-Mail sick@sick.dk

**Deutschland**

Phone +49 211 5301-301  
E-Mail kundenservice@sick.de

**España**

Phone +34 93 480 31 00  
E-Mail info@sick.es

**France**

Phone +33 1 64 62 35 00  
E-Mail info@sick.fr

**Great Britain**

Phone +44 (0)1727 831121  
E-Mail info@sick.co.uk

**India**

Phone +91-22-4033 8333  
E-Mail info@sick-india.com

**Israel**

Phone +972-4-6801000  
E-Mail info@sick-sensors.com

**Italia**

Phone +39 02 27 43 41  
E-Mail info@sick.it

**Japan**

Phone +81 (0)3 3358 1341  
E-Mail support@sick.jp

**Magyarország**

Phone +36 1 371 2680  
E-Mail office@sick.hu

**Nederlands**

Phone +31 (0)30 229 25 44  
E-Mail info@sick.nl

**Norge**

Phone +47 67 81 50 00  
E-Mail austefjord@sick.no

**Österreich**

Phone +43 (0)22 36 62 28 8-0  
E-Mail office@sick.at

**Polska**

Phone +48 22 837 40 50  
E-Mail info@sick.pl

**România**

Phone +40 356 171 120  
E-Mail office@sick.ro

**Russia**

Phone +7-495-775-05-30  
E-Mail info@sick.ru

**Schweiz**

Phone +41 41 619 29 39  
E-Mail contact@sick.ch

**Singapore**

Phone +65 6744 3732  
E-Mail admin@sicksgp.com.sg

**South Africa**

Phone +27 11 472 3733  
E-Mail info@sickautomation.co.za

**South Korea**

Phone +82 2 786 6321/4  
E-Mail info@sickkorea.net

**Slovenija**

Phone +386 (0)1-47 69 990  
E-Mail office@sick.si

**Suomi**

Phone +358-9-25 15 800  
E-Mail sick@sick.fi

**Sverige**

Phone +46 10 110 10 00  
E-Mail info@sick.se

**Taiwan**

Phone +886-2-2375-6288  
E-Mail sales@sick.com.tw

**Türkiye**

Phone +90 (216) 528 50 00  
E-Mail info@sick.com.tr

**United Arab Emirates**

Phone +971 (0) 4 8865 878  
E-Mail info@sick.ae

**USA/México**

Phone +1(952) 941-6780  
1 800-325-7425 – tollfree  
E-Mail info@sickusa.com

More representatives and agencies  
at [www.sick.com](http://www.sick.com)