

PART NUMBER	ENGINEERING NO.	LENGTH
1300250322	DND91A-M010	1M
1300250324	DND91A-M030	3M
1300250326	DND91A-M050	5M

**PART NO. LEGEND (A1)**

DND91A-M010

FINISHED LENGTH  
M005= 0.5 METER  
M010= 1 METER  
M100= 10 METERS

- (A1) NOTES:**
1. MATERIAL: AS NOTED
  2. FINISHES: AS NOTED
  3. ELECTRICAL SPECIFICATIONS  
VOLTAGE RATING: 300V PER IEC60664  
300V PER UL2238  
CURRENT RATING: 4 AMPS
  4. PROTECTION: IP67 (WHEN MATED)
  5. TEMP RANGE: -20°C TO +80°C
  6. UL RECOGNIZED FILE: E152210  
CSA CERTIFICATION FILE: LR6837
  7. DIMS SHOWN ARE FOR REFERENCE UNLESS NOTED OTHERWISE

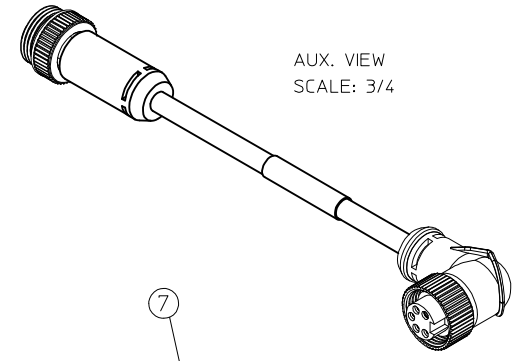

**CABLE LENGTH TOLERANCES**

>.3M (1FT): +19mm-0 [+;.75in-0]

.3 - .9M (1 - 3FT): +44.5mm-0 [+1.75in-0]

.9 - 1.8M (3 - 6FT): +55.6mm-0 [+2.19in-0]

1.8 - 3.7M (6 - 12FT): +88.9mm-0 [+3.50in-0]

3.7 - 7.3M (12 - 24FT): +165.1mm-0 [+6.50in-0]

7.3-14.6M (24 - 48FT): +317.5mm-0 [+12.50in-0]

14.6 - 30.5M (48-100FT): +622.3mm-0 [+24.50in-0]

OVER 30M (100FT) +2% OF FINISHED LENGTH

P1		S2
1	DRAIN	1
2	RED +V	2
3	BLACK -V	3
4	WHITE CAN H	4
5	BLUE CAN L	5

WIRING DIAGRAM

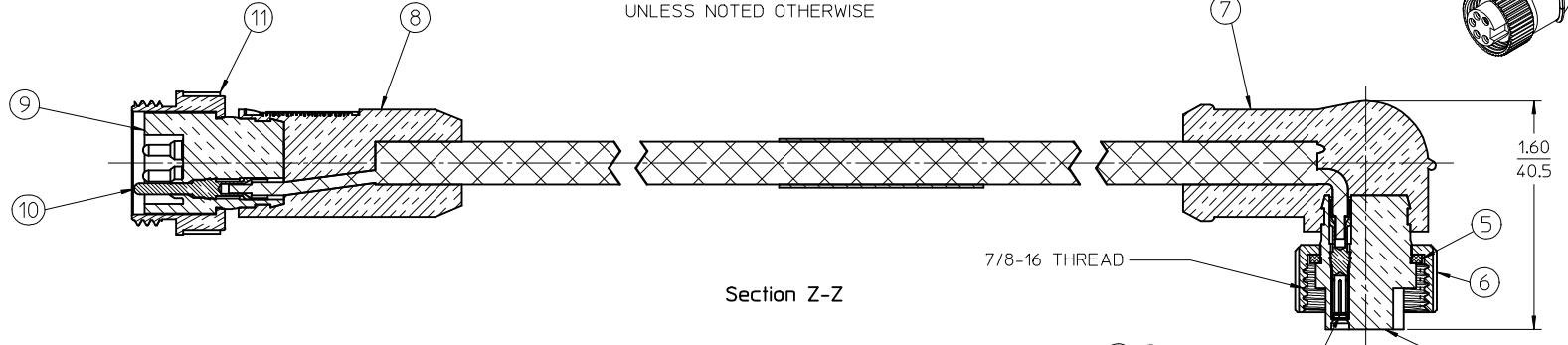

Section Z-Z

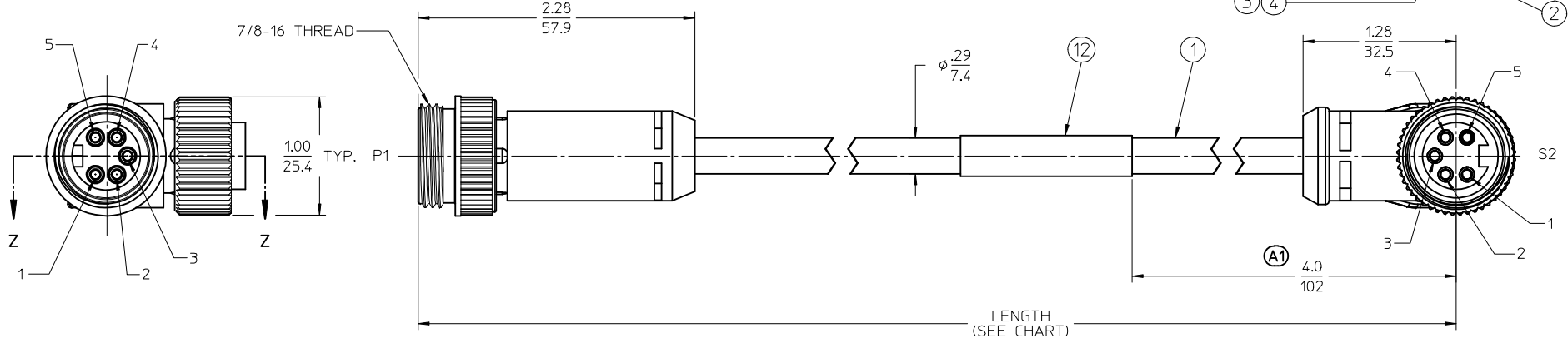

ITEM	DESCRIPTION	MATERIAL	FINISH
12	LABEL	VINYL	BLACK/YELLOW
11	COUPLING NUT, MALE	ZINC DIE CAST	BLACK
10	CONTACT PIN, 22 AWG	BRASS	GOLD PLATED
9	INSERT, MALE, 5 POLE	PVC	GRAY
8	OVERMOLD, STRAIGHT	PVC	GRAY
7	OVERMOLD, 90 DEG	PVC	GRAY
6	COUPLING NUT, FEMALE	ZINC DIE CAST	BLACK
5	FRICTION RING	NYLON	WHITE
4	SOCKET SLEEVE	ST. STEEL	
3	CONTACT SOCKET, 22 AWG	BRASS	GOLD PLATED
2	INSERT, FEMALE, 5 POLE	PVC	GRAY
1	CABLE, DEV-NET, DROP, 4/22	PVC JACKET	GRAY

<b>REV'D IEC VOLTS:</b> <b>NOTES: ADD P/N LEG</b> <b>EC NO: IPG2017-1047</b> DRAWN BY: DRWINRSTONE 2017/05/11 CHKD: APPR: BWOODMAN 2017/06/15	<b>QUALITY SYMBOLS</b> ▽=0 ▽=0	<b>GENERAL TOLERANCES (UNLESS SPECIFIED)</b> <table border="1"> <thead> <tr> <th></th> <th>mm</th> <th>INCH</th> </tr> </thead> <tbody> <tr> <td>4 PLACES ±</td> <td>---</td> <td>---</td> </tr> <tr> <td>3 PLACES ±</td> <td>---</td> <td>---</td> </tr> <tr> <td>2 PLACES ±</td> <td>---</td> <td>---</td> </tr> <tr> <td>1 PLACE ±</td> <td>---</td> <td>---</td> </tr> </tbody> </table>		mm	INCH	4 PLACES ±	---	---	3 PLACES ±	---	---	2 PLACES ±	---	---	1 PLACE ±	---	---	<b>DIMENSION STYLE</b> IN/MM	<b>SCALE</b> 1.5:1	<b>DESIGN UNITS</b> INCH	THIRD ANGLE PROJECTION
		mm	INCH																		
	4 PLACES ±	---	---																		
	3 PLACES ±	---	---																		
2 PLACES ±	---	---																			
1 PLACE ±	---	---																			
DRAWN BY: R.STONE 2009/07/30 CHECKED BY: B.WOODMAN 2009/07/31 APPROVED BY: J.MURPHY 2009/07/05	<b>MINI-CHANGE, CORD ASSY</b> <b>MALE STRT/FEM 90 DEG</b> <b>DEV-NET, DROP STD-THIN</b>			<b>MOLEX INCORPORATED</b>		SHEET NO. 1 OF 1															
<b>DRAFT WHERE APPLICABLE MUST REMAIN WITHIN DIMENSIONS</b>	<b>SEE CHART</b>			<b>DOCUMENT NO.</b> SD-130025-021		<b>THIS DRAWING CONTAINS INFORMATION THAT IS PROPRIETARY TO MOLEX INCORPORATED AND SHOULD NOT BE USED WITHOUT WRITTEN PERMISSION</b>															