

TP3-4131A024L024M (ORDER NO. 098403)

- ▶ Auxiliary release on the front
- ▶ With door monitoring contact
- ▶ Increased horizontal overtravel

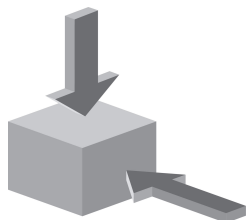

DESCRIPTION

Approach direction



Figure

Horizontal and vertical

Can be adjusted in 90° steps

Increased overtravel for horizontal approach direction

Solenoid operating voltage

- ▶ AC/DC 24 V +10%, -15%

LED function display

A function display (2 LEDs, red and green) is available for the following voltage range:

- ▶ AC/DC 24 V +10%, -15%

Guard locking type

TP3 Closed-circuit current principle, guard locking by spring force. Release by applying voltage to the guard locking solenoid.

Switching element

4131 Slow-action switching contact 2 NC (⊖) + 1 NO + 1 NO (door monitoring contact)

Auxiliary release

Is used for releasing the guard locking with the aid of a tool. To protect against tampering, the auxiliary release is sealed with sealing lacquer.

Dimension drawing

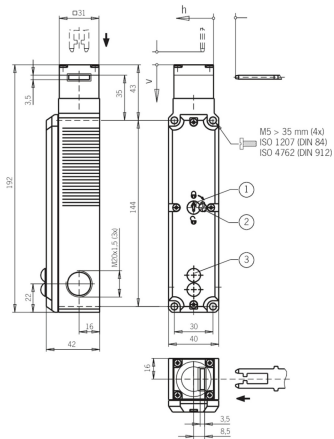

4131

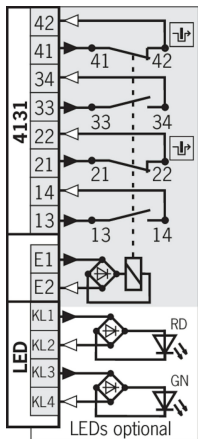

Switching functions

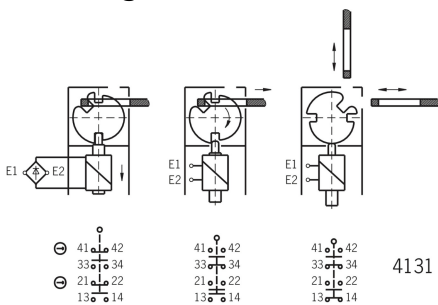

TECHNICAL DATA

Approvals



Mechanical values and environment

Housing material	Reinforced thermoplastic
Weight	
	Net 0,5 kg
Ambient temperature	-20 ... 55 °C
Degree of protection	IP67
Mechanical life	1 x 10 ⁶
Contact material	Silver alloy, gold flashed
Switching principle	Slow-action switching contact
Installation position	Any
Number of door position positively driven contacts	2
Number of NO contacts	2
Connection	
	3 x M20 x 1.5
Approach speed	
	max. 20 m/min
Actuation frequency	1200 1/h
Guard locking principle	Closed-circuit current principle
Locking force F _{max}	1300 N
Locking force F _{Zh}	1000 N
Retention force	10 N
Extraction force	20 N
Actuating force	10 N

Electrical connection ratings

Thermal rated current I _{th}	4 A
Utilization category according to EN 60947-5-1	
	AC-15 4A 230V
	DC-13 4A 24V
Solenoid operating voltage	
	AC/DC 24 V -15% ... +10%
Short circuit protection according to IEC 60269-1	
	(Fuse) 4A gG
Rated insulation voltage U _i	250 V
Rated impulse withstand voltage U _{imp}	2,5 kV
Switching voltage	
	Min. at 10mA 12 V
Switching current	
	Min. at 24V 1 mA
Power consumption	8 W
Solenoid duty cycle	100 %
Connection cross-section	0,34 ... 1,5 mm ²
Display module	
	AC/DC 24 V -15% ... +10%

Reliability values according to EN ISO 13849-1

	Monitoring of guard locking and the safety guard position
B10 _D	3 x 10 ⁶

In combination with Actuator BETAETIGER-P-GT

Mechanical values and environment

Overtravel A B C D E	2 mm
Overtravel K L M N	1,5 mm

In combination with Actuator BETAETIGER-P-GNT

Mechanical values and environment

Overtravel A B C D E	7 mm
----------------------	------

ACCESSORIES

Actuator

Actuators for safety switches NP/GP/TP



059226
BETAETIGER-P-G

- ▶ Actuators made of stainless steel
- ▶ Two stainless safety screws per actuator



070046
BETAETIGER-P-GT

- ▶ Actuators made of stainless steel
- ▶ Two stainless safety screws per actuator
- ▶ Actuators with rubber bushings

Actuators for safety switches NP/GP/TP, increased overtravel



074570
BETAETIGER-P-GN

- ▶ Actuators made of stainless steel
- ▶ Two stainless safety screws per actuator



074576
BETAETIGER-P-GNT

- ▶ Actuators made of stainless steel
- ▶ Two stainless safety screws per actuator
- ▶ Actuators with rubber bushings

Bent actuator for safety switches NP/GP/TP



059227
BETAETIGER-P-W

- ▶ Actuators made of stainless steel
- ▶ Two stainless safety screws per actuator



070038
BETAETIGER-P-WT

- ▶ Actuators made of stainless steel
- ▶ Two stainless safety screws per actuator
- ▶ Actuators with rubber bushings



▶ Actuators with rubber bushings

Bent actuator for safety switches NP/GP/TP, increased overtravel



074571
BETAETIGER-P-WN

- ▶ Actuators made of stainless steel
- ▶ Two stainless safety screws per actuator



074577
BETAETIGER-P-WNT

- ▶ Actuators made of stainless steel
- ▶ Two stainless safety screws per actuator
- ▶ Actuators with rubber bushings

Hinged actuator left/right for safety switches NP/GP/TP



059440
RADIUSBETAETIGER-P-LR

- ▶ Actuators made of stainless steel
- ▶ Two stainless safety screws per actuator
- ▶ For doors hinged on right and left

Hinged actuator left/right for safety switches NP/GP/TP, increased overtravel



074573
RADIUSBETAETIGER-P-LRN

- ▶ Actuators made of stainless steel
- ▶ Two stainless safety screws per actuator
- ▶ For doors hinged on right and left

Hinged actuator top/bottom for safety switches NP/GP/TP

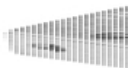

070050
RADIUSBETAETIGER-P-OU

- ▶ Actuators made of stainless steel
- ▶ Two stainless safety screws per actuator
- ▶ For doors hinged at top and bottom

Hinged actuator top/bottom for safety switches NP/GP/TP, increased overtravel



074572
RADIUSBETAETIGER-P-OUN

- ▶ Actuators made of stainless steel
- ▶ Two stainless safety screws per actuator
- ▶ For doors hinged at top and bottom

Bolt

Bolt 0 NP/TP for safety switches NP, GP and TP



073535
RIEGEL 0 NP/TP OHNE RASTUNG

- ▶ Steel bolt
- ▶ For doors hinged on the left or right
- ▶ Can be locked in open position with padlocks
- ▶ Actuator included

Bolt 1 NP/TP for safety switches NP, GP and TP



073536
RIEGEL 1 NP/TP 1X RASTUNG ZU

- ▶ Steel bolt
- ▶ For doors hinged on the left or right
- ▶ Can be locked in open position with padlocks
- ▶ Actuator included
- ▶ Detent mechanism closed position

Bolt BTC-T/GP... without escape release for safety switches GP and TP



106301
BTC-T/GP-S-TH-00-X

- ▶ Aluminum bolt
- ▶ For doors hinged on the left or right
- ▶ Can be locked in open position with padlocks
- ▶ Actuator included

Bolt TP-GFK for safety switches TP and GP



096616
RIEGEL TP-GFK

- ▶ Fiber glass reinforced plastic bolt
- ▶ For doors hinged on the left or right
- ▶ Can be locked in open position with padlocks
- ▶ Actuator included

Bolt TP/GP... for safety switches GP and TP



084430
RIEGEL TP-A

- ▶ Steel bolt
- ▶ For doors hinged on the right
- ▶ Can be locked in open position with padlocks
- ▶ Actuator included



084432
RIEGEL TP-C

- ▶ Steel bolt
- ▶ For doors hinged on the left
- ▶ Can be locked in open position with padlocks
- ▶ Actuator included

Connection material

Cable glands M20x1.5, cable Ø 6-12 mm



086233
EKPM20/06 086233

Function expansion

Built-in LED, light shines to front



095510
EINBAULEUCHTE LED-F M20X1,5

Built-in LED, light shines to side



087423
EINBAULEUCHTE LED M20X1,5

Emergency unlocking for safety switches CTP/TP/STP



099877
NOTENTSPERRUNG TP/STP

Handle for escape release for safety switches TP/STP/STA



105329
FE-GRIFF

Handle for wire front release



099795
AY-HDL-099795

► Suitable for all wire front releases

Insertion funnel for safety switches NP..A/GP/TP..A



086237
EINFUEHRTRICHTER-P

LED set

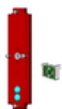

093752
TP LED SET

► LED set

Latch spring for increased retention force

Lock for auxiliary release for safety switches CTP/TP/STP



084177
SCHLOSS TP
VERSCHIEDENSCHLIESSEND

- ▶ Lock unique locking
- ▶ Key removable in "unlocked" and "locked" positions



086236
SCHLOSS TP GLEICHSCHLIESSEND

- ▶ Identical locking
- ▶ Key removable in "unlocked" and "locked" positions



109212
SCHLOSS TP GLEICHSCHLIESSEND
C2293

- ▶ Identical locking
- ▶ Key can be removed only in "locked" position

Lockout bar NP/GP/TP

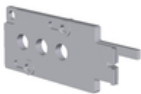

096105
SPERREINSATZ TP

- ▶ Prevents unintentional closing of the door
- ▶ Can be secured with padlocks

Release with automatic reset for safety switches CTP/TP/STP



103110
ENTRIEGELUNG RUECKSTELLEND
TP/STP

Wire front release



096230
AE-B-A1-02,0-096230

- ▶ Can be used as escape release or emergency unlocking
- ▶ No automatic return
- ▶ Sheath length 2 m (rope length 6 m)



098313
AE-B-A1-03,0-098313

- ▶ Can be used as escape release or emergency unlocking
- ▶ No automatic return
- ▶ Sheath length 3 m (rope length 6 m)



098314
AE-B-A1-04,0-098314

- ▶ Can be used as escape release or emergency unlocking
- ▶ No automatic return



- ▶ Sheath length 4 m (rope length 6 m)



097747
AE-B-A1-02,0-F-097747

- ▶ Can be used as escape release or emergency unlocking
- ▶ automatic return
- ▶ Sheath length 2 m (rope length 6 m)



111233
AE-B-A1-03,0-F-111233

- ▶ Can be used as escape release or emergency unlocking
- ▶ automatic return
- ▶ Sheath length 3 m (rope length 6 m)



124770
AE-B-A1-06,0-F-124770

- ▶ Can be used as escape release or emergency unlocking
- ▶ automatic return
- ▶ Rope length 6 m (without sheath)



125582
AE-B-A1-06,0-125582

- ▶ Can be used as escape release or emergency unlocking
- ▶ No automatic return
- ▶ Rope length 6 m (without sheath)

Mounting accessories

Mounting plates EMP-B1 for actuators for safety switches CTP, TP...A, STA, STP, TX and TZ



093457
EMP-B1

Mounting plates EMP-B2 for actuators for safety switches CTP, TP...A, STA, STP, TX and TZ



093458
EMP-B2

Mounting plates EMP-SB for safety switches CTP, TP...A, STA, STP and TX



093456
EMP-SB

- ▶ For vertical and horizontal mounting of safety switches TP...A, STA, STP and TX

Safety screws M4 x 14, large head

086232
M4X14-NIRO/V100

- ▶ Safety screws M4 x 14 (large head)
- ▶ Packaging unit 100 pieces

Safety screws M5 x 10

073455
M5X10-NIRO/V100 NZ/TZ

- ▶ Safety screws M5 x 10
- ▶ Packaging unit 100 pieces

Safety screws for actuators, M5 x 25

073457
M5X25/V100

- ▶ Safety screws M5 x 25
- ▶ Packaging unit 100 pieces

Switch bracket TP/STP GFK



096613
SCHALTERAUFNAHME TP/STP GFK

- ▶ Switch bracket made of fiber glass reinforced plastic
- ▶ For left or right hinged doors

Switch bracket for bolt NP/TP



073539
SCHALTERAUFNAHME TP

- ▶ Switch bracket made of steel
- ▶ For doors hinged on the left or right

Contacts

🏠 EUCHNER GmbH + Co. KG
Kohlhammerstraße 16
70771 Leinfelden-Echterdingen

☎ +49 711 7597-0

📠 +49 711 753316

✉ info(at)euchner.de