



CONTACTOR, 90KW/400V/AC-3,  
AC(40...60HZ)/DC OPERATION UC 220...240V AUXIL.  
CONTACTS 2NO+2NC 3-POLE,  
SIZE S6 BAR CONNECTIONS CONVENT. OPERATING  
MECHANISM SCREW TERMINAL

**General details:**

<b>Product brand name</b>		SIRIUS
<b>Product designation</b>		power contactor
<b>Size of the contactor</b>		S6
<b>Protection class IP / frontal/front side</b>		IP00
<b>Degree of pollution</b>		3
<b>Installation altitude / at a height over sea level / maximum</b>	m	2000
<b>Ambient temperature / during the operating phase</b>	°C	-25 ... 60
<b>Real loss power / per conductor / typical</b>	W	13
<b>Item designation</b>		
<ul style="list-style-type: none"> <li>• according to DIN EN 61346-2</li> </ul>		Q
<ul style="list-style-type: none"> <li>• according to DIN 40719 extendable after IEC 204-2 / according to IEC 750</li> </ul>		K
<b>Mechanical operating cycles as operating time</b>		
<ul style="list-style-type: none"> <li>• of the contactor / typical</li> </ul>		10000000
<ul style="list-style-type: none"> <li>• of the contactor with added auxiliary switch block / typical</li> </ul>		10000000
<ul style="list-style-type: none"> <li>• of the contactor with added electronics-compatible auxiliary switch block / typical</li> </ul>		5000000

**Main circuit:**

<b>Number of poles / for main current circuit</b>		3
---	--	---

<b>Number of NC contacts / for main contacts</b>		0
<b>Number of NO contacts / for main contacts</b>		3
<b>Operating current / at AC-1 / at 400 V / at 40 °C ambient temperature / rated value</b>	A	215
<b>Operating current / at AC-1 / at 400 V / at 60 °C ambient temperature / rated value</b>	A	185
<b>Operating current</b>		
• at AC-3 / at 400 V / rated value	A	185
• with 1 current path		
• at DC-1		
• at 24 V / rated value	A	160
• at 110 V / rated value	A	18
• at DC-3 / at DC-5		
• at 24 V / rated value	A	160
• at 110 V / rated value	A	2.5
• with 2 current paths in series		
• at DC-1		
• at 24 V / rated value	A	160
• at 110 V / rated value	A	160
• at DC-3 / at DC-5		
• at 24 V / rated value	A	160
• at 110 V / rated value	A	160
• with 3 current paths in series		
• at DC-1		
• at 24 V / rated value	A	160
• at 110 V / rated value	A	160
• at DC-3 / at DC-5		
• at 24 V / rated value	A	160
• at 110 V / rated value	A	160
<b>Service power</b>		
• at AC-1 / at 400 V / rated value	kW	121
• at AC-2 / at 400 V / rated value	kW	104
• at AC-3		
• at 400 V / rated value	kW	90
• at 500 V / rated value	kW	132
• at 690 V / rated value	kW	167
<b>Control circuit:</b>		
<b>Design of activation of the operating mechanism</b>		conventional
<b>Design of the surge suppressor</b>		with varistor
<b>Type of voltage / of the controlled supply voltage</b>		AC/DC

<b>Control supply voltage frequency</b>		
• 1 / rated value	Hz	40
• 2 / rated value	Hz	60
<b>Control supply voltage / 1</b>		
• for DC		
• initial rated value	V	220
• final rated value	V	240
• at 50 Hz / for AC		
• initial rated value	V	220
• final rated value	V	240
• at 60 Hz / for AC		
• initial rated value	V	220
• final rated value	V	240

#### Auxiliary circuit:

<b>Contact reliability / of the auxiliary contacts</b>		1 faulty switching per 100 million (17 V, 1 mA)
<b>Number of NC contacts / for auxiliary contacts</b>		
• instantaneous switching		2
• lagging switching		0
<b>Number of NO contacts / for auxiliary contact</b>		
• instantaneous switching		2
• leading switching		0
<b>Operating current / of the auxiliary contacts</b>		
• at AC-12 / maximum	A	10
• at AC-15		
• at 230 V	A	6
• at 400 V	A	3
• at DC-12		
• at 60 V	A	6
• at 110 V	A	3
• at 220 V	A	1
• at DC-13		
• at 24 V	A	10
• at 60 V	A	2
• at 110 V	A	1
• at 220 V	A	0.3

#### Short-circuit:

<b>Design of the fuse link</b>		
• for short-circuit protection of the auxiliary switch / required		fuse gL/gG: 10 A
• for short-circuit protection of the main circuit		

- at type of coordination 1 / required
- at type of coordination 2 / required

fuse gL/gG: 355 A  
fuse gL/gG: 315 A





### Installation/mounting/dimensions:

Type of mounting		screw fixing
series installation		Yes
Width	mm	120
Height	mm	172
Depth	mm	180
Distance, to be maintained, to earthed part / sideways	mm	10

### Connection type:

Design of the electrical connection		
<ul style="list-style-type: none"> <li>• for main current circuit</li> <li>• for auxiliary and control current circuit</li> </ul>		screw-type terminals screw-type terminals
Identification number and letter for switching elements		22 E

### Certificates/approvals:

General Product Approval		Functional Safety / Safety of Machinery	
<a href="#">CQC</a>		<a href="#">KETI</a>	
		<a href="#">ROSTEST</a>	<a href="#">SUVA</a>
Test Certificates		Shipping Approval	
<a href="#">Manufacturer</a>	<a href="#">other</a>	<a href="#">ABS</a>	
			
other			
<a href="#">Manufacturer</a>	<a href="#">other</a>		

### Further information:

#### Information- and Downloadcenter (Catalogs, Brochures,...)

<http://www.siemens.com/industrial-controls/catalogs>

#### Industry Mall (Online ordering system)

<http://www.siemens.com/industrial-controls/mall>

#### CAX-Online-Generator

<http://www.siemens.com/cax>

#### Service&Support (Manuals, Certificates, Characteristics, FAQs,...)

<http://support.automation.siemens.com/WW/view/en/3RT1056-6AP36/all>

#### Image database (product images, 2D dimension drawings, 3D models, device circuit diagrams, ...)

[http://www.automation.siemens.com/bilddb/cax\\_en.aspx?mlfb=3RT1056-6AP36](http://www.automation.siemens.com/bilddb/cax_en.aspx?mlfb=3RT1056-6AP36)

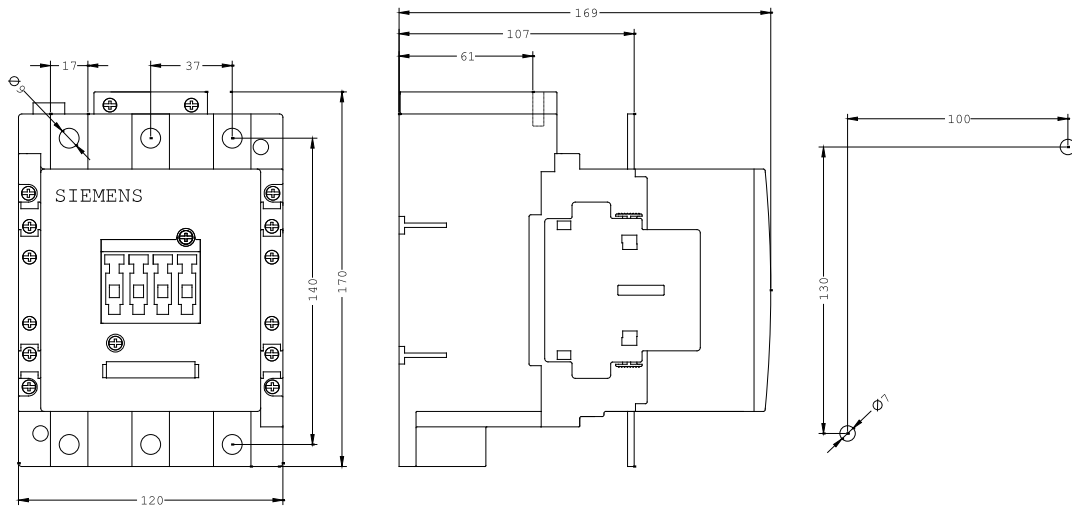

last change:

Sep 20, 2010