

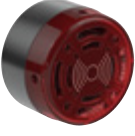





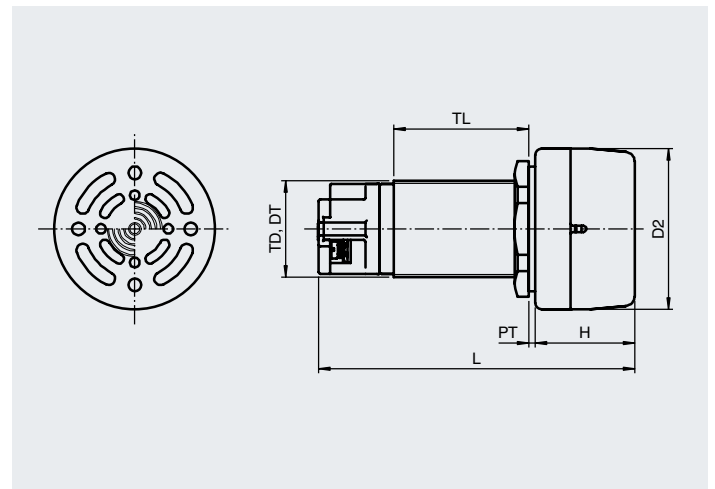

Buzzer and Accessories

Buzzer Modules				
Type	Function	Color	Rated operating voltage [V AC/DC]	Image
CFP.BUZR1	flashing buzzer	red	10 ... 28	
CFP.BUZR2	flashing buzzer	red	20 ... 250	
CFP.BUZR3	buzzer	black	10 ... 28	
CFP.BUZR4	buzzer	black	20 ... 250	



Buzzer—Dimensions									
Actuator head diameter [mm]	Panel wall thickness [mm]	Diameter thru-hole [mm]	Length outside enclosure [mm]	Total length [mm]	Thread size	Thread length [mm]	Mass [g]	Mounting	Enclosure type
D2	PT	DT	H	L	TD	TL			
50	1 ... 35	30.6	31	98.5	M30 x 1.5	42	125	cover-mounted	LC* GL*.CS GR.CS* FXL*.CS

Operating Elements Accessories								
Type	Description	Image	Type	Description	Image	Type	Description	Image
CFP.BK	Blanking plug		CFP.ZF	Emergency stop label, yellow, rectangular, adhesive		CFP.ZC	Protective shroud, stainless steel	
CFP.ZS	Small label holder with printed label as per specification		CFP.ZA	Protective lid, plastic		CFP.ZD	Protective shroud, stainless steel, padlockable	
CFP.ZL	Large label holder with printed label as per specification		CFP.ZH	Protective shroud for double pushbutton, stainless steel, padlockable		CFP.ZJ	Protective shroud for pushbutton continuous operation, plastic, padlockable	
CFP.ZE	Emergency stop label, yellow, round, adhesive		CFP.ZB	Protective shroud for small actuators, plastic, padlockable		CFP.ZP	Emergency stop shroud, plastic, padlockable	
CFP.TP	Locknut spanner, plastic	