

SURGE SUPPRESSOR, RC COUPLING, AC  
127...240V, DC 150...250V, F. CONT. RELAYS A.  
MOTOR CONT. SZ S00,



General technical data:		
product brandname		SIRIUS
Product designation		surge suppressor
Size of contactor		S00
Design of the surge suppressor		with RC elements
Ambient temperature		
<ul style="list-style-type: none"> <li>during storage</li> </ul>	°C	-40 ... +80
<ul style="list-style-type: none"> <li>during operation</li> </ul>	°C	-25 ... +60

Control circuit/ Control:		
Type of voltage of the control supply voltage		AC/DC
Control supply voltage frequency		
<ul style="list-style-type: none"> <li>1 rated value</li> </ul>	Hz	50
<ul style="list-style-type: none"> <li>2 rated value</li> </ul>	Hz	60
Control supply voltage 1		
<ul style="list-style-type: none"> <li>at DC</li> </ul>		
<ul style="list-style-type: none"> <li> <ul style="list-style-type: none"> <li>Initial rated value</li> </ul> </li> </ul>	V	150
<ul style="list-style-type: none"> <li> <ul style="list-style-type: none"> <li>Final rated value</li> </ul> </li> </ul>	V	250
<ul style="list-style-type: none"> <li>at AC</li> </ul>		

— at 50 Hz Initial rated value	V	127
— at 50 Hz Final rated value	V	240
— at 60 Hz Final rated value	V	240
— at 60 Hz Initial rated value	V	127

#### Installation/ mounting/ dimensions:

Mounting position		any
Mounting type		clip-on
Width	mm	28
Height	mm	46
Depth	mm	9

#### Certificates/ approvals:

Certificate of suitability	CE / UL / CSA / CCC	
----------------------------	---------------------	--

General Product Approval	Declaration of Conformity	Test Certificates
 CSA  UR  EAC	 CE EG-Konf.	<a href="#">Special Test Certificate</a> <a href="#">Type Test Certificates/Test Report</a>

#### Shipping Approval



Shipping Approval	other	Railway
-------------------	-------	---------



#### Further information

Information- and Downloadcenter (Catalogs, Brochures,...)

<http://www.siemens.com/industrial-controls/catalogs>

Industry Mall (Online ordering system)

<http://www.siemens.com/industrymall>

Cax online generator

<http://support.automation.siemens.com/WW/CAXorder/default.aspx?lang=en&mlfb=3RT2916-1CD00>

Service&Support (Manuals, Certificates, Characteristics, FAQs,...)

<https://support.industry.siemens.com/cs/ww/en/ps/3RT2916-1CD00>

Image database (product images, 2D dimension drawings, 3D models, device circuit diagrams, EPLAN macros, ...)

[http://www.automation.siemens.com/bilddb/cax\\_de.aspx?mlfb=3RT2916-1CD00&lang=en](http://www.automation.siemens.com/bilddb/cax_de.aspx?mlfb=3RT2916-1CD00&lang=en)

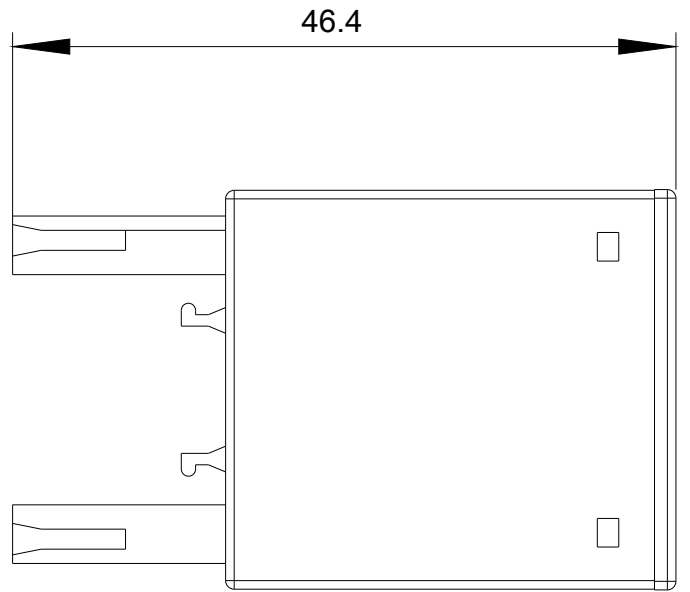
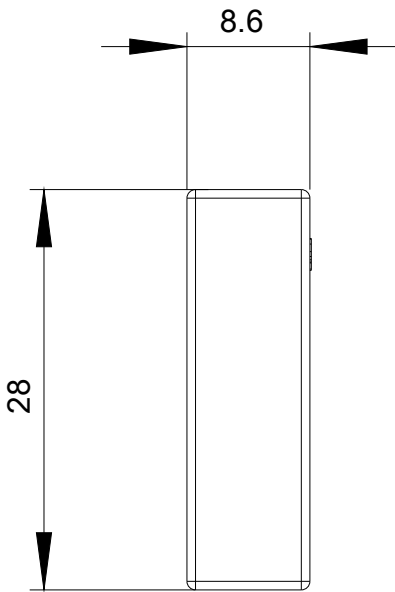

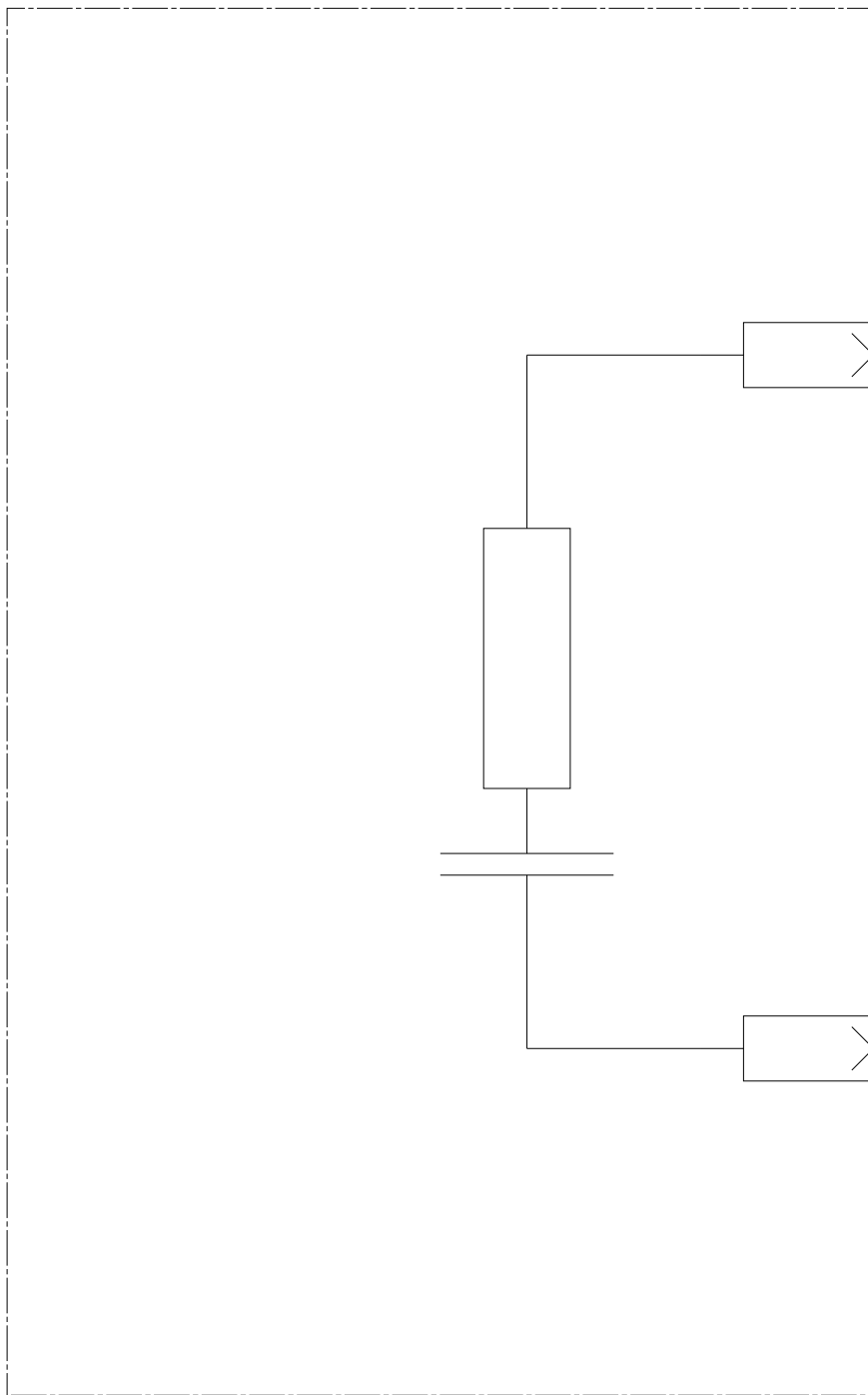

last modified:

07/19/2017