











## FAK complete unit emergency-stop

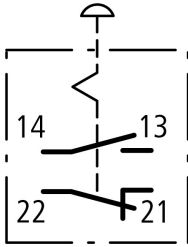
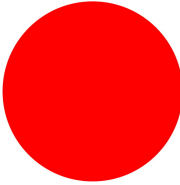

Powering Business Worldwide™

**Part no.** FAK-R/V/KC11/IY  
**Article no.** 229748  
**Catalog No.** FAK-R-V-KC11-IY

### Delivery programme

Product range			Foot and palm switches
Basic function			Basic devices
Single unit/Complete unit			Complete unit
Function			maintained
Description			Pull to release Emergency stop pushbutton tamper-proof to ISO 13850/EN 418
Contacts			
N/O = Normally open			1 N/O
N/C = Normally closed			1 NC 
Notes			 = safety function, by positive opening to IEC/EN 60947-5-1
Enclosure color			Enclosure base RAL 9005, black Operator only RAL 1004, yellow
Contact sequence			
Colour			
Button			Red
			
Cover			Yellow
Lower section			Black
Approval			    
Connection to SmartWire-DT			no

### Approvals

Product Standards	IEC/EN 60947-5; UL 508; CSA-C22.2 No. 14-05; CSA-C22.2 No. 94-91; CE marking
UL File No.	E29184
UL Category Control No.	NKCR
CSA File No.	012528
CSA Class No.	3211-03
North America Certification	UL listed, CSA certified

**General**

Lifespan, mechanical	Operations	x 10 <sup>6</sup>	> 0.1
Operating frequency	Operations/ h		≦ 600
Actuating force		N	40 - 60
Degree of protection, IEC/EN 60529			IP67, IP69K
Climatic proofing			Damp heat, constant, to IEC 60068-2-78 Damp heat, cyclic, to IEC 60068-2-30
Ambient temperature		°C	
Open		°C	- 25 - + 40
Mounting position			As required
Mechanical shock resistance		g	> 15 Shock duration 11 ms Sinusoidal according to IEC 60068-2-27

**Technical data ETIM 5.0**

Low-voltage industrial components (EG000017) / Foot-/palm switch complete (EC000231)

Electric engineering, automation, process control engineering / Low-voltage switch technology / Command and alarm device / Foot, palm switch (ecl@ss8-27-37-12-17 [AKF035010])

Unlocking method			Pull release
Colour cap			Red
Number of contacts as normally open contact			1
Number of contacts as normally closed contact			1
Switching function latching			Yes
Spring-return			No
Hole diameter		mm	0
Degree of protection (IP)			IP67

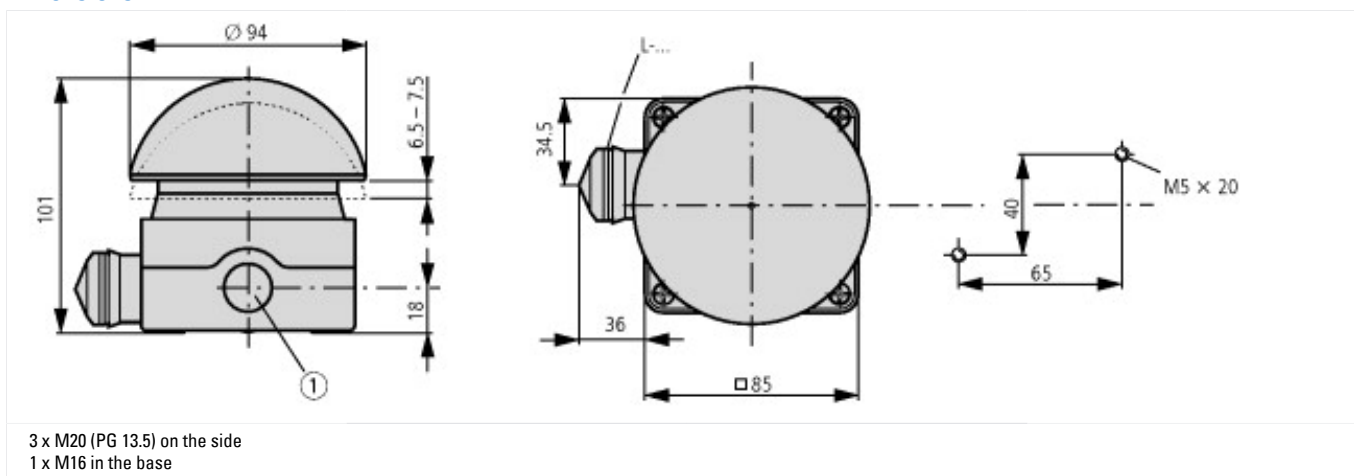
**Dimensions****Additional product information (links)**

<b>IL04716006Z (AWA1160-1696) Indicator light</b>	
IL04716006Z (AWA1160-1696) Indicator light	<a href="ftp://ftp.moeller.net/DOCUMENTATION/AWA_INSTRUCTIONS/IL04716006Z2011_02.pdf">ftp://ftp.moeller.net/DOCUMENTATION/AWA_INSTRUCTIONS/IL04716006Z2011_02.pdf</a>
<b>IL04716017Z (AWA1160-1467) Foot and palm switches</b>	
IL04716017Z (AWA1160-1467) Foot and palm switches	<a href="ftp://ftp.moeller.net/DOCUMENTATION/AWA_INSTRUCTIONS/IL04716017Z2011_02.pdf">ftp://ftp.moeller.net/DOCUMENTATION/AWA_INSTRUCTIONS/IL04716017Z2011_02.pdf</a>