

### FEATURES

- All products are covered by the Pressure Equipment Directive 97/23/EC and are suitable for group 1 and 2 fluids
- Reliable control in high pressure, high flow systems
- The valves are constructed packless with a one-piece deepdrawn stainless steel core tube, ensuring safe separation of electrical and wetted moving parts
- The valves have forged brass bodies, compact design, to minimize heat radiation loss
- Heavy duty piston designs for the more demanding and critical steam applications
- Valves require a minimum operating pressure of 0,35 bar
- The solenoid valves satisfy all relevant EC directives

### GENERAL

Differential pressure 0,35 - 9 bar [1 bar = 100 kPa]  
Response times 100 - 1.000 ms

fluids (*)	temperature range (TS)	disc (*)
hot water and steam	-20 to +184°C	PTFE

### MATERIALS IN CONTACT WITH FLUID

(\*) Ensure that the compatibility of the fluids in contact with the materials is verified

Body	Brass
Core tube	Stainless steel
Core and plugnut	Stainless steel
Springs	Stainless steel
Seat	Brass
Piston	Brass
Sealings	EPDM (ethylene propylene)
Piston rings	PTFE carbon filled
Discs	PTFE
Shading coil	Copper

### ELECTRICAL CHARACTERISTICS

Coil insulation class H  
Connector Spade plug (cable Ø 6-10 mm)  
Connector specification ISO 4400 / EN 175301-803, form A  
Electrical safety IEC 335  
Standard voltages DC (-) : not available  
(Other voltages and 60 Hz on request) AC (-) : 24V - 115V - 230V / 50 Hz

coil type	power ratings				ambient temperature range (TS) (°C)	protection
	inrush ~ (VA)	holding ~ (VA) (W)		= (W)		
		(VA)	(W)			
CMXX-HT	55	23	10,5	-	-20 to +40	moulded IP65

### SPECIFICATIONS

pipe size	orifice size (mm)	flow coefficient Kv (m³/h) (l/min)		operating pressure differential (bar)			max. fluid temp. (°C)	coil type	catalogue number	OPTIONAL			
				min.	maximum (PS)					FPM	EPDM	CR	PTFE
					steam (*)	water (1)							
Rp													
1	25	12	200	0,35	9	9	184	CMXX-HT	SCE222B004				
1 1/4	28	13	217	0,35	9	9	184	CMXX-HT	SCE222B008				
1 1/2	32	19	317	0,35	9	9	184	CMXX-HT	SCE222B082				

(1) Water temperature should not exceed 100°C

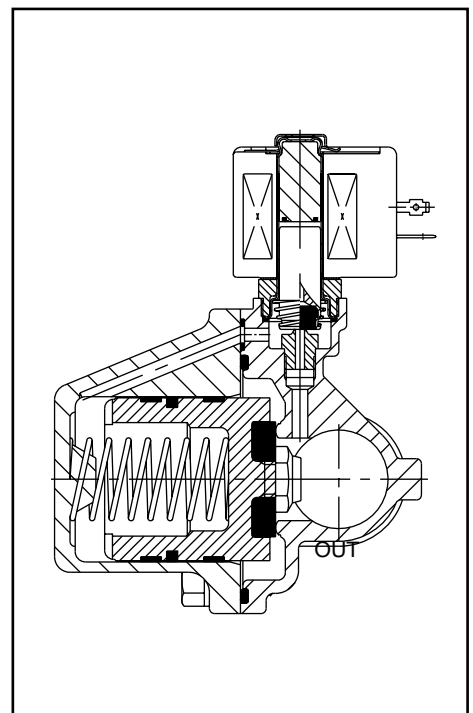

### OPTIONS

- Watertight enclosure with embedded screw terminal coil and Pg 13,5 cable gland to meet CEE-10 (IP67)
- Solenoid head "CSA" approved. Coils according to "CSA/SA" standards
- Compliance with "UL" and "CSA" standards
- Mounting brackets

### INSTALLATION

- The solenoid valves can be mounted in any position without affecting operation
- Pipe thread identifier is: E = Rp (ISO 7)
- The first digit in the catalogue number indicates the standard pipe connection
- Other pipe connections are available on request
- Installation/maintenance instructions are included with each valve
- Spare Parts Kit and replacement coils are available (see section 11)

### DIMENSIONS (mm), WEIGHT (kg)

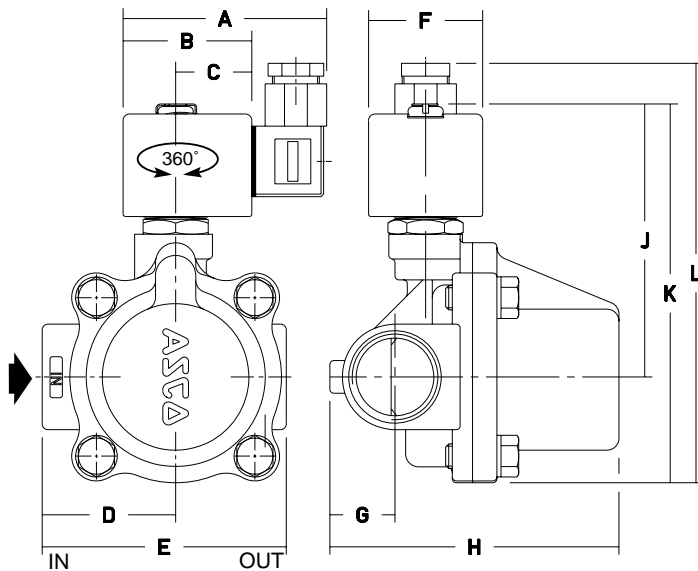

catalogue number SCE222	A	B	C	D	E	F	G	H	J	K	L	weight (1)
B004	80	50	30	58	100	45	30	108	123	164	182	3,5
B008	80	50	30	54	93	45	33	121	123	164	182	3,5
B082	80	50	30	65	111	45	38	145	127	175	193	5,5

(1) incl. coil and connector

All leaflets are available on: [www.ascojoucomatic.com](http://www.ascojoucomatic.com)