



Applications



Approvals

ASTA 20 Certified

Application Notes

Protection of PVC insulated cables

SAFECLIP Fuse Links will protect an associated cable against both overload and short circuit if its current rating is equal to or less than the current rating of the cable. This is in accordance with the IEE Wiring Regulations (BS 7671:1992).

Short circuit energy limitation

SAFECLIP Fuse Links limit the peak current and energy let through to circuits that experience short circuit faults. This enables significant economies to be made in the design of equipment used in combination with SAFECLIP Fuse Links.

Discrimination

SAFECLIP Fuse Links will discriminate with each other at fault levels up to their rated ac performance in most cases when the ratio between 'major' and 'minor' current ratings is 2:1.

Motor Starting Ability

All SAFECLIP Fuse Links are suitable for the protection of motor circuits and have superior withstand to motor starting surges.

Protection against electric shock

SAFECLIP Fuse Links protect against electric shock when used in accordance with the IEE Wiring Regulations (BS 7671:1992).

Power dissipation

All SAFECLIP Fuse Links have low power loss values, well within the limits specified in BS 88: Part 2 (IEC 269-2).

HRC Fuse Links

SAFECLIP

BS 88-1 or 6:1988

IEC 269-1

Technical Data

| | |
|--|---------------|
| Current Rating | (A) 2-125 |
| Voltage Rating ac | (V) up to 440 |
| Breaking Capacity ac | (kA) 80 |
| Max Operating Ambient Temperature | (°C) 40 |

Breaking Capacity

AC Performance

The standard ratings are ASTA 20 certified to 80kA, 440 Volt*, to BS 88: Part 1 or Part 6: 1988 (IEC 269-1).

* SS types are certified at 16.5kA, 240 Volt, and the NS32M40, ES63M80 and XS125 at 80kA, 415 Volt.

Associated Fusegear Equipment

- SAFECLIP Fuse Holders
- SAFECLIP Fusebanks
- SAFECLIP Fuseboards

Associated Switchable Devices

- MSS Panel Mounting Fuse Switches
- WMSS Wall Mounting Fuse Combination Units
- MST100 Panel Mounting Fuse Switch
- WM1003N Wall Mounting Fuse Switch
- SAFECLIP Panel Boards

- Contact the sales office for catalogues

SAFECLIP - Offset blade tag: Type SS



BS Ref. E1

| Current rating | Part number | Code | Max voltage rating ac |
|----------------|-------------|--------|-----------------------|
| 2A | SS2 | 401257 | 240 |
| 4A | SS4 | 401261 | 240 |
| 6A | SS6 | 401262 | 240 |
| 10A | SS10 | 401255 | 240 |
| 16A | SS16 | 401256 | 240 |
| 20A | SS20 | 401258 | 240 |

SAFECLIP - Offset blade tag: Type NS



BS Ref. F1

| Current rating | Part number | Code | Max voltage rating ac |
|----------------|-------------|--------|-----------------------|
| 2A | NS2 | 401236 | 440 |
| 4A | NS4 | 401242 | 440 |
| 6A | NS6 | 401243 | 440 |
| 10A | NS10 | 401234 | 440 |
| 16A | NS16 | 401235 | 440 |
| 20A | NS20 | 401237 | 440 |
| 25A | NS25 | 401238 | 440 |
| 32A | NS32 | 401239 | 440 |
| 32M40A | NS32M40 | 401240 | 415 |

SAFECLIP - Offset blade tag: Type ES



BS Ref. F2

| Current rating | Part number | Code | Max voltage rating ac |
|----------------|-------------|--------|-----------------------|
| 40A | ES40 | 401186 | 440 |
| 50A | ES50 | 401187 | 440 |
| 63A | ES63 | 401188 | 440 |
| 63M80A | ES63M80 | 401190 | 415 |

SAFECLIP - Offset blade tag: Type XS



| Current rating | Part number | Code | Max voltage rating ac |
|----------------|-------------|--------|-----------------------|
| 2A | XS2 | 401273 | 440 |
| 4A | XS4 | 401278 | 440 |
| 6A | XS6 | 401281 | 440 |
| 10A | XS10 | 401269 | 440 |
| 16A | XS16 | 401272 | 440 |
| 20A | XS20 | 401274 | 440 |
| 25A | XS25 | 401275 | 440 |
| 32A | XS32 | 401276 | 440 |
| 35A | XS35 | 401277 | 440 |
| 40A | XS40 | 401279 | 440 |
| 50A | XS50 | 401280 | 440 |
| 63A | XS63 | 401282 | 440 |
| 80A | XS80 | 401283 | 440 |
| 100A | XS100 | 401270 | 440 |
| 125A | XS125 | 401271 | 415 |

SAFECLIP - Offset tags: 2-hole fixing: Type OS



Fixing Centres
73mm

| Current rating | Part number | Code | Max voltage rating ac |
|----------------|-------------|--------|-----------------------|
| 80A | OS80 | 400234 | 440 |
| 100A | OS100 | 400231 | 440 |
| 100M125A | OS100M125 | 400232 | 415 |
| 100M160A | OS100M160 | 400233 | 415 |



Dimensions in mm

SAFECLIP - Offset blade tag

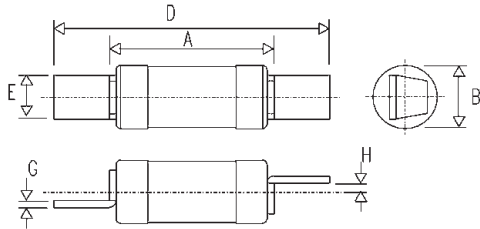

| Type | Rating | A | B | D | E | G | H |
|------|------------|-------|-------|-------|-------|------|------|
| SS | 2 - 20 | 25.00 | 14.50 | 51.00 | 11.00 | 0.80 | 3.60 |
| NS | 2 - 32M40 | 35.50 | 14.50 | 62.00 | 11.00 | 0.80 | 3.60 |
| ES | 40 - 63M80 | 39.00 | 17.50 | 69.00 | 15.00 | 1.25 | 3.60 |
| XS | 2 - 125 | 39.00 | 26.40 | 80.00 | 19.00 | 1.60 | 3.60 |

SAFECLIP - Offset tags: 2-hole fixing

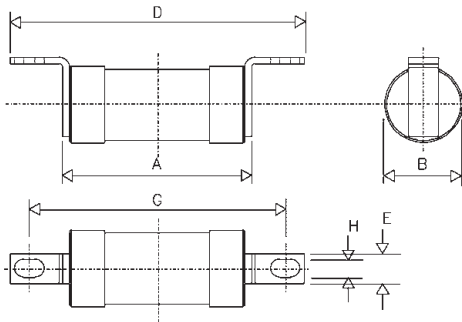

| Type | Rating | A | B | D | E | G Fixing Centres | H |
|------|--------------|-------|-------|-------|-------|------------------------|------|
| OS | 80 - 100M160 | 58.00 | 26.40 | 90.50 | 12.70 | 73.00 | 5.20 |

SAFECLIP

C

SAFELIP: I^2t values

Type SS

| Current Rating (Amp) | Pre-Arcing I^2t (A ² sec) | Total I^2t (A ² sec) at 240 Volt |
|----------------------|--|---|
| 2 | 2 | 4 |
| 4 | 7.5 | 15 |
| 6 | 30 | 85 |
| 10 | 50 | 150 |
| 16 | 140 | 1400 |
| 20 | 300 | 1700 |

Type NS, ES and XS

| Current Rating (Amp) | Pre-Arcing I^2t (A ² sec) | Total I^2t (A ² sec) at 415 Volt | Total I^2t (A ² sec) at 440 Volt |
|----------------------|--|---|---|
| 2 | 2.2 | 9.5 | 11 |
| 4 | 7.2 | 30 | 33 |
| 6 | 22 | 92 | 100 |
| 10 | 170 | 650 | 700 |
| 16 | 200 | 800 | 950 |
| 20 | 360 | 1200 | 1500 |
| 25 | 650 | 2500 | 2900 |
| 32 | 600 | 3500 | 4050 |
| 40 & 32M40* | 2400 | 6400 | 12000 |
| 50 | 3200 | 11500 | 15000 |
| 63 | 5400 | 14500 | 25000 |
| 80 & 63M80* | 6000 | 24000 | 38000 |
| 100 | 12000 | 54000 | 58000 |
| 125 | 13000 | 115000 | |

* Maximum rating of 32M40 and 63M80 is 415 Volt.

SAFELIP: Time/current characteristics

Type SS

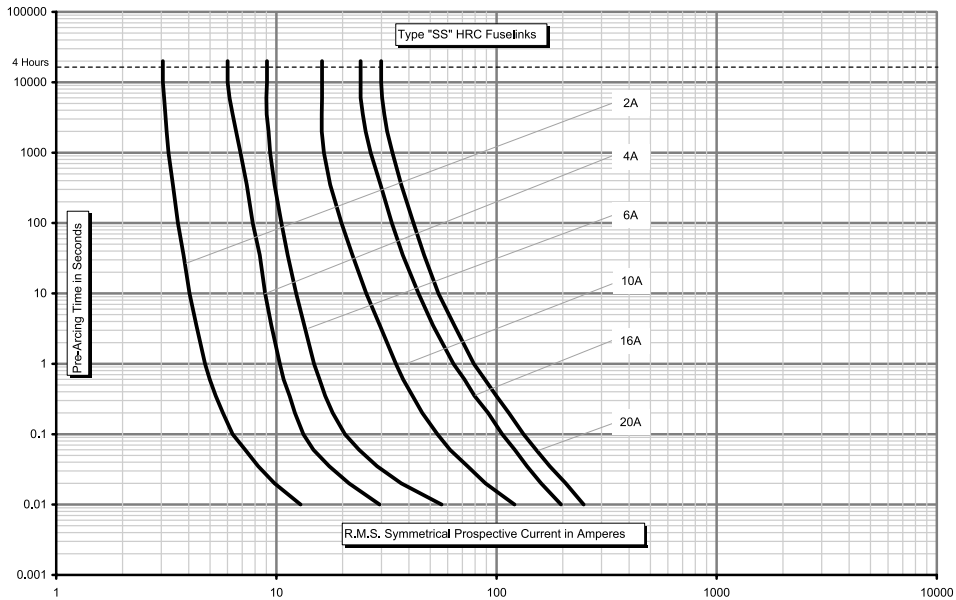

Type NS, ES and XS

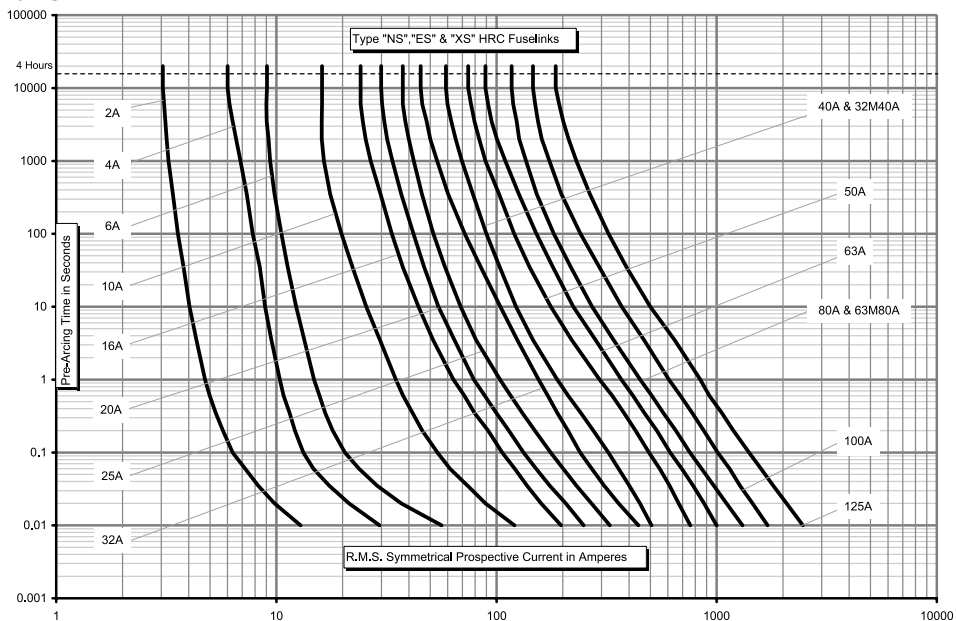

SAFECLIP: I²t values

Type OS

| Current Rating (Amp) | Pre-Arcing I ² t (A ² sec) | Total I ² t (A ² sec) at 415 Volt | Total I ² t (A ² sec) at 440 Volt |
|----------------------|--|---|---|
| 80 | 14000 | 37000 | 40000 |
| 100 | 17000 | 57000 | 60000 |
| 100M125 | 32000 | 120000 | |
| 100M160 | 50000 | 135000 | |

SAFECLIP: Time/current characteristics

Type OS

