



EMAX204PS

Term Tech Rotary Isolator Surface Mounted AC Current Lockable Standard Bodied 20A 4 Pole



The Termination Technology range of 3 phase and Neutral rotary isolators are available from 20A all the way up to 100A. Lockable in the isolated position for safety whilst performing maintenance. Inner workings accessible by a 2 screw cover. Supplied with metric 20mm or 25mm knockouts depending on the size. Suitable for use with AC current only.

Technical Data

Application Type, Size and Range

IP Rating	IP65
Knockout Size	M20
Number of Poles	4

Dimensions

Dimension A (mm)	100
Dimension B (mm)	125
Dimension C (mm)	81
Dimension D (mm)	35
Dimension E (mm)	80
Dimension F (mm)	115

Discernible Features

Locking Mechanism	Padlock lockable in isolated position
Mounting Style	Surface Mounted

Electrical Ratings

Max Current (A)	20
-----------------	----

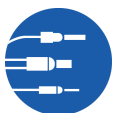

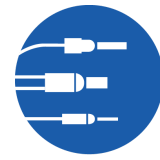

Current Type	AC
Voltage Rating (V)	415
Power Rating (kW)	5.5

Product Specification

Specification	BS EN 60947 Compliant
UKCA Approved	Yes

UK CA

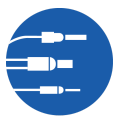
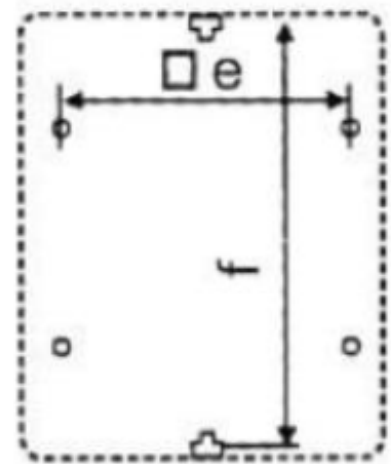
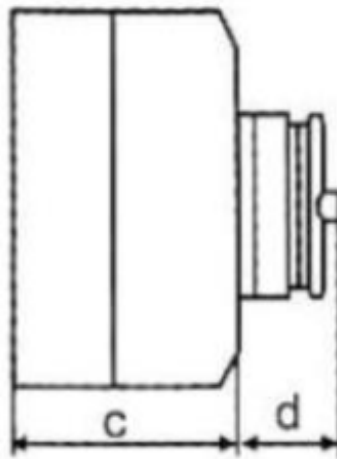
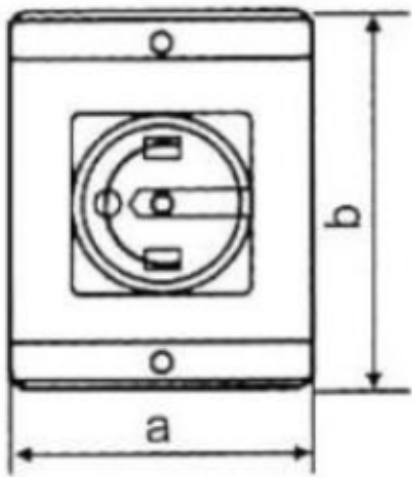

**Termination
Technology Ltd**
Quality and Service

The company with the RIGHT connections at the RIGHT price.

Company Registration Number: 05062297

W: www.termtech.co.uk

T: 01179 354 900

E: sales@termtech.co.uk

Termination Technology Ltd, Unit 4C Crofts End Ind Estate, Crofts End Road,
Bristol BS5 7UW

