

Ordering details

Voltage	h	Type	Aux. contact	Cable entry	Weight approx.	Order No.
Type 32 A 4-pole						
200-250 V		Wall socket	–	KU	1.8 kg	GHG 512 4409 R0001
		Wall socket	–	ME	1.9 kg	GHG 512 4409 R3001
		Wall socket	–	GM	2.0 kg	GHG 512 4409 R3003
		Flange socket	–		1.0 kg	GHG 512 8409 R0001
		Coupler	–		1.7 kg	GHG 512 3409 R0001
		Plug	–		0.7 kg	GHG 512 7409 R0001
380-415 V	9 h 	Wall socket	–	KU	1.8 kg	GHG 512 4406 R0001
		Wall socket	–	ME	1.9 kg	GHG 512 4406 R3001
		Wall socket	yes	KH	1.8 kg	GHG 512 4406 R0501
		Wall socket	–	GM	2.0 kg	GHG 512 4406 R3003
		Flange socket	–		1.0 kg	GHG 512 8406 R0001
		Coupler	–		1.7 kg	GHG 512 3406 R0001
480-500 V	6 h 	Wall socket	–	KU	1.8 kg	GHG 512 4407 R0001
		Wall socket	–	ME	1.9 kg	GHG 512 4407 R3001
		Wall socket	yes	KH	1.8 kg	GHG 512 4407 R0501
		Flange socket	–		1.0 kg	GHG 512 8407 R0001
		Coupler	–		1.7 kg	GHG 512 3407 R0001
		Plug	–		0.7 kg	GHG 512 7407 R0001
600-690 V	5 h 	Wall socket	–	KU	1.8 kg	GHG 512 4405 R0001
		Wall socket	–	ME	1.9 kg	GHG 512 4405 R3001
		Wall socket	yes	KH	1.8 kg	GHG 512 4405 R0501
		Flange socket	–		1.0 kg	GHG 512 8405 R0001
		Coupler	–		1.7 kg	GHG 512 3405 R0001
		Plug	–		0.7 kg	GHG 512 7405 R0001
Type 32 A 5-pole						
200-250 V		Wall socket	–	KU	1.8 kg	GHG 512 4506 R0001
380-415 V		Wall socket	–	ME	1.9 kg	GHG 512 4506 R3001
		Wall socket	yes	KH	1.8 kg	GHG 512 4506 R0501
		Wall socket	–	GM	2.0 kg	GHG 512 4506 R3003
		Flange socket	–		1.0 kg	GHG 512 8506 R0001
		Coupler	–		1.7 kg	GHG 512 3506 R0001
Plug	–		0.7 kg	GHG 512 7506 R0001		

Other voltage ranges and versions available on request

KU = 1 x plastic cable glands M40 for Ø 17-28 mm, 1 x M40 plastic Ex-screw plug

KH = 1 x plastic cable glands M40 for Ø 17-28 mm,

1 x plastic cable glands M25 for Ø 8 - 17 mm, with aux. contact

ME = 2 x metal thread M32 with plastic Ex-screw plug

GM = 2 x metal thread M32 with screw plug, with external earth bolt M6

32A 4-pole up to 690 V
 32A 5-pole up to 415 V

1



Wall socket



Flange socket



Coupler



Plug

Dimension drawing | Wiring diagram

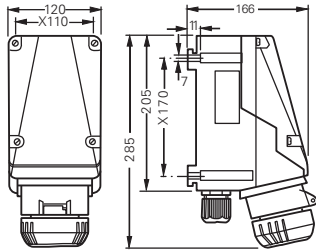

Wall socket 4-pole

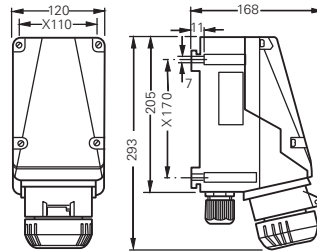

Wall socket 5-pole

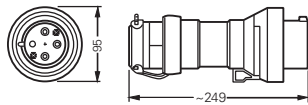

Plug 4-pole

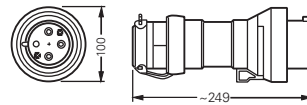

Plug 5-pole

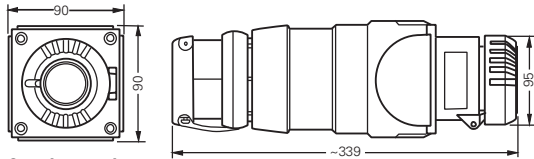

Coupler 4-pole

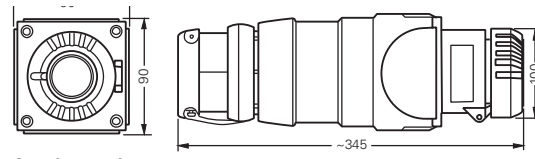

Coupler 5-pole

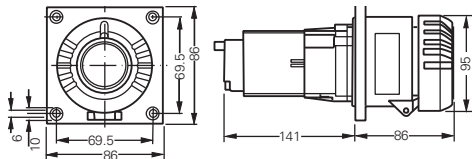

Flange socket 4-pole

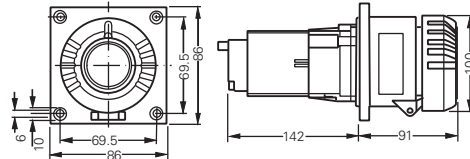

Flange socket 5-pole

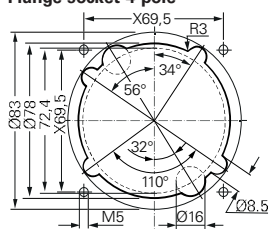

Assembly dimensions flange socket

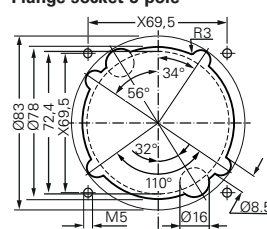

Assembly dimensions flange socket

X = fixing dimensions

without
aux. contact

L1 L2 L3 PE



3P + PE



with
aux. contact

L1 L2 L3 13 N F



3P + AUX + PE

without
aux. contact

L1 L2 L3 N PE



3P + N + PE



with
aux. contact

L1 L2 L3 13 N PE

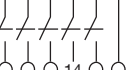

3P + N + AUX + PE

Dimensions in mm

32A 4-pole up to 690 V
 32A 5-pole up to 415 V

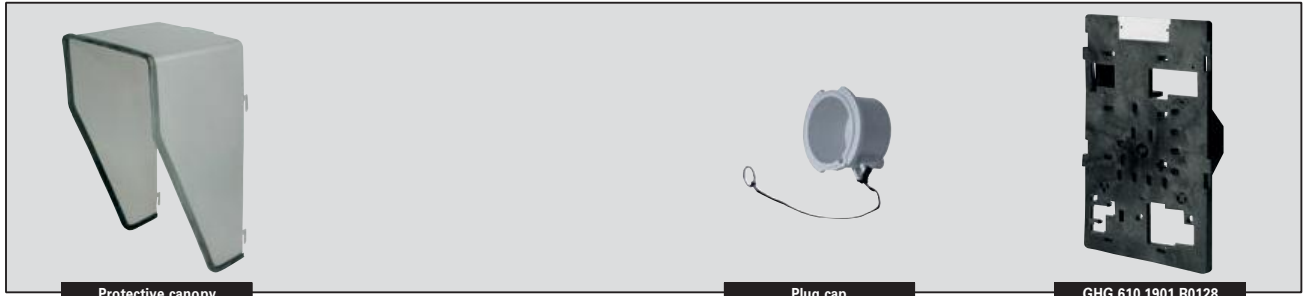

Protective canopy

Plug cap

GHG 610 1901 R0128

1

Accessories

Mounting plates for wall sockets 32 A

Type	Application	Fixing method	Order No.
Size 5	for wall mounting	snap on	GHG 610 1953 R0128
Size 5	for trellis mounting	snap on	GHG 610 1953 R0128
Size 5	for pipe clamp	snap on	GHG 610 1953 R0132

Plug cap for plugs 32 A

Type	Order No.
Plug 32 A 3-pole/4-pole	GHG 510 1901 R0004
Plug 32 A 5-pole	GHG 510 1901 R0005

Accessories for mounting plates

Type	OU	Order No.
Mounting set for pipes 1" (Ø 27 - 30 mm) for mounting plates with pipe fixing	10	GHG 610 1953 R0020

Please pay attention that only order units (OU) according to the ordering details can be delivered.

Protective canopy for mounting plate

Type	Application	Order No.
Size 5	for mounting plate size 5, snap on	GHG 610 1955 R0108

Dimension drawing

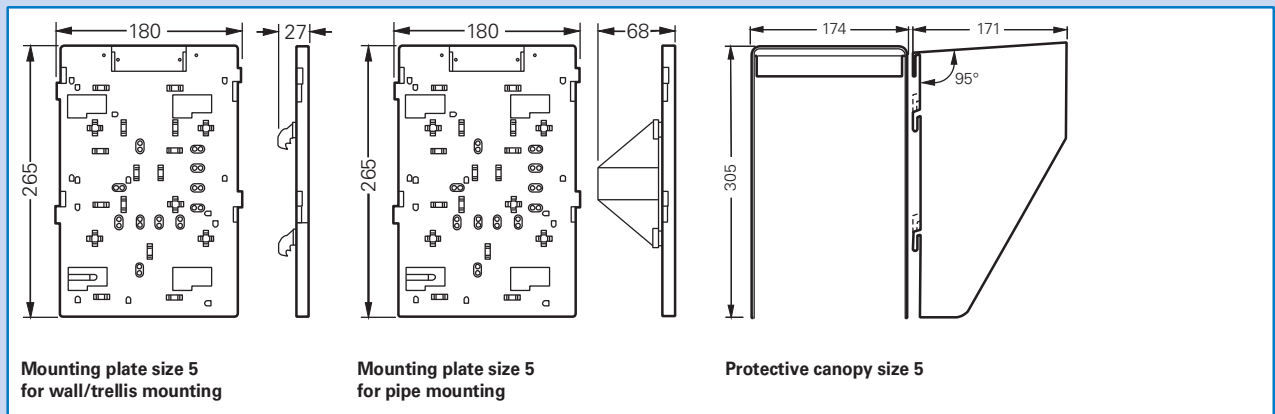

Mounting plate size 5 for wall/trellis mounting

Mounting plate size 5 for pipe mounting

Protective canopy size 5

Dimensions in mm