



IDM260-311S

IDM26x

MOBILE HAND-HELD SCANNERS

SICK
Sensor Intelligence.



Ordering information

Type	Part no.
IDM260-311S	6068392

Other models and accessories → www.sick.com/IDM26x



Detailed technical data

Features

Application	Industrial
Scanner design	2D code hand-held scanner
Sensor resolution	1,280 px x 800 px
Light source	
Internal lighting	LED, Visible, Red, 630 nm
Adjustment aid	Laser, Visible, Red, 630 nm
Code resolution	≥ 0.07 mm ¹⁾ ≥ 0.13 mm ²⁾
Reading distance	30 mm ... 400 mm

¹⁾ Valid for Code 39.

²⁾ Valid for Data Matrix code.

Mechanics/electronics

Supply voltage	5 V DC ... 5 V DC, ± 10 %
Current consumption	Operation (vibration deactivated): 395 mA Operation (vibration activated): 420 mA Standby: 220 mA
Housing color	Blue, gray
Enclosure rating	IP65
Weight	208 g, without cable
Dimensions (L x W x H)	104 mm x 76.3 mm x 176 mm
MTBF	100,000 h

Performance

Readable code structures	1D codes, 2D codes, Stacked
Bar code types	Code 39, Code 39 Trioptic, Code 32, Code 93, Code 11, Codabar, Code 128, GS1-128 / EAN 128, UPC / EAN / JAN (with addition), MSI/Plessey, UK/Plessey, IATA, Interleaved 2 of 5, Standard and Industrial 2 of 5, Matrix 2 of 5, Telepen, GS1 DataBar, Australian Post, China Post, German Post, US Planet, US Postnet, British Post, Intelligent Mail, Japan Post, Korean Post, Dutch KIX Post

2D code types	Data Matrix, QR code, MicroQR-Code, Aztec, MaxiCode
Stacked code types	PDF417, MicroPDF417, Code 49, Code 16K, Composite, Codablock F

Interfaces

Ethernet	✓, TCP/IP
Type of fieldbus integration	Optional, over external connection module CDF600-2
PROFINET	✓
Type of fieldbus integration	Optional over external fieldbus module CDF600-2
Function	PROFINET Single Port, PROFINET Dual Port
EtherCAT®	✓
Type of fieldbus integration	Optional over external fieldbus module CDF600
Serial	✓, RS-232
PROFIBUS DP	✓
Type of fieldbus integration	Optional over external fieldbus module CDF600-2
DeviceNet™	✓
Type of fieldbus integration	Optional, over external connection module CDM + CMF
USB	✓
Function	Keyboard wedge, COM-Port emulation
Optical indicators	2 LEDs (operational status, good read)
Acoustic indicators	Beeper, can be switched off
Vibration	Yes
Configuration software	IDM Setup Tool

Ambient data

Shock resistance	50 drops from 2 m height on concrete
Ambient operating temperature	-20 °C ... +50 °C
Storage temperature	-40 °C ... +70 °C
Permissible relative humidity	95 %, Non-condensing
Ambient light immunity	100,000 lx

General notes

Note	Not free of paint wetting impairment substances.
-------------	--

Classifications

ECl@ss 5.0	27280101
ECl@ss 5.1.4	27280101
ECl@ss 6.0	27280101
ECl@ss 6.2	27280101
ECl@ss 7.0	27280101
ECl@ss 8.0	27280101
ECl@ss 8.1	27280101
ECl@ss 9.0	27280101
ECl@ss 10.0	27280101
ECl@ss 11.0	27280101
ETIM 5.0	EC002550

ETIM 6.0	EC002550
ETIM 7.0	EC002550
UNSPSC 16.0901	43211701

Connection diagram

PROFINET IO/RT

PROFINET IO/RT

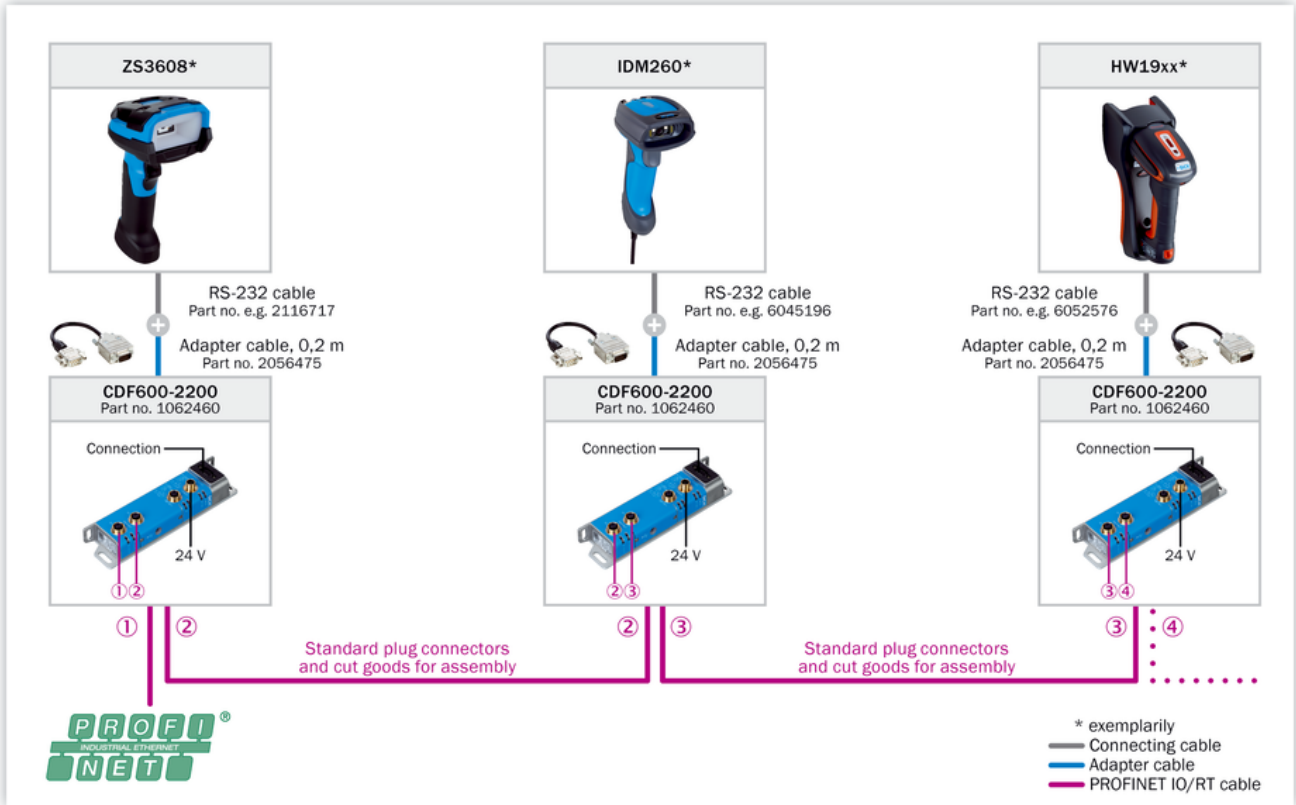

PROFIBUS DP

PROFIBUS DP

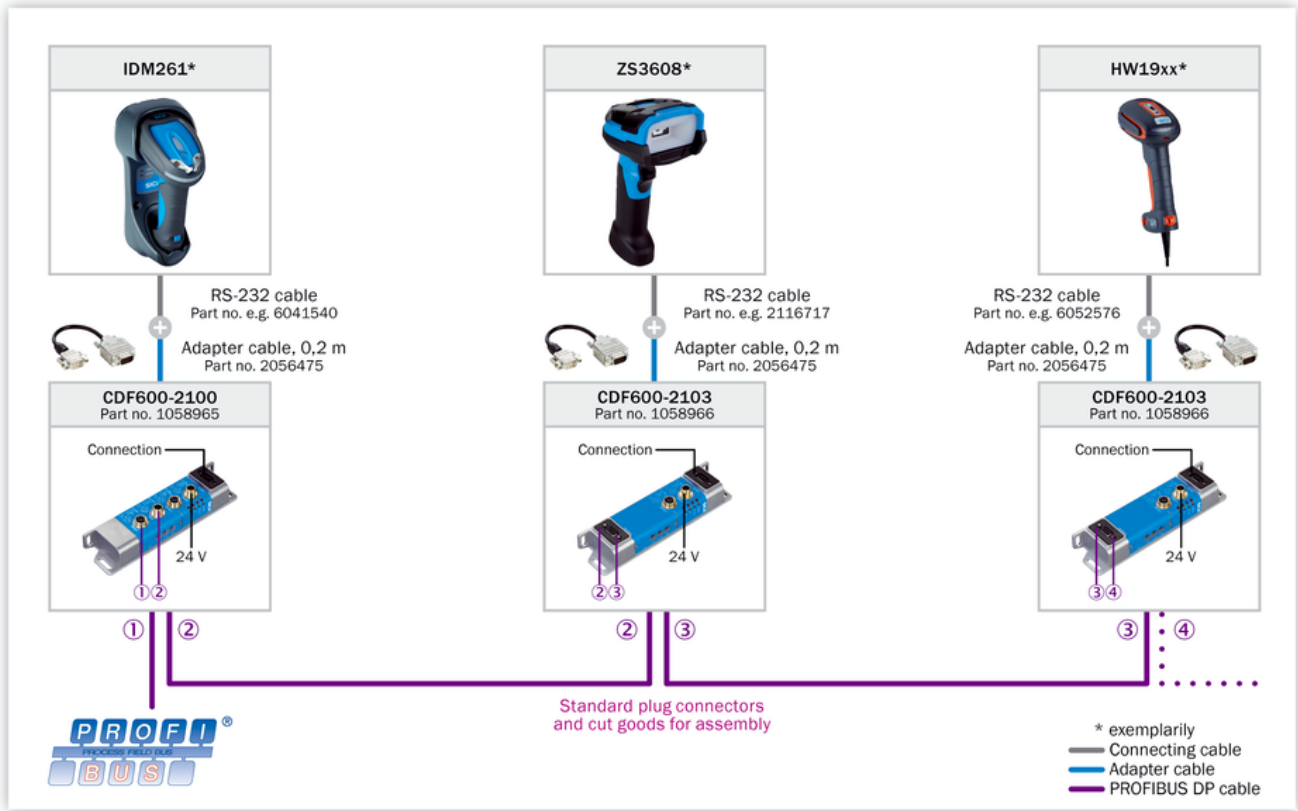

Ethernet TCP/IP

Ethernet TCP/IP

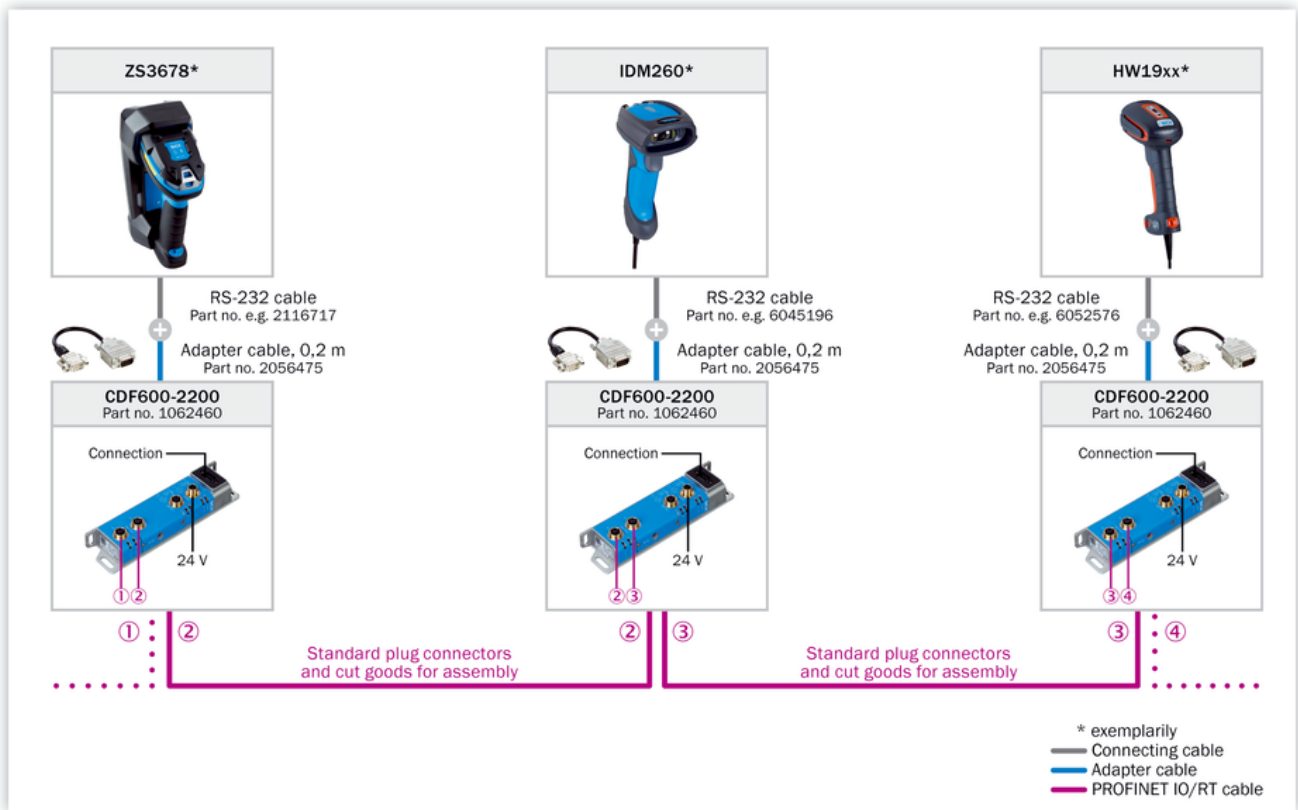

EtherCAT®

EtherCAT®

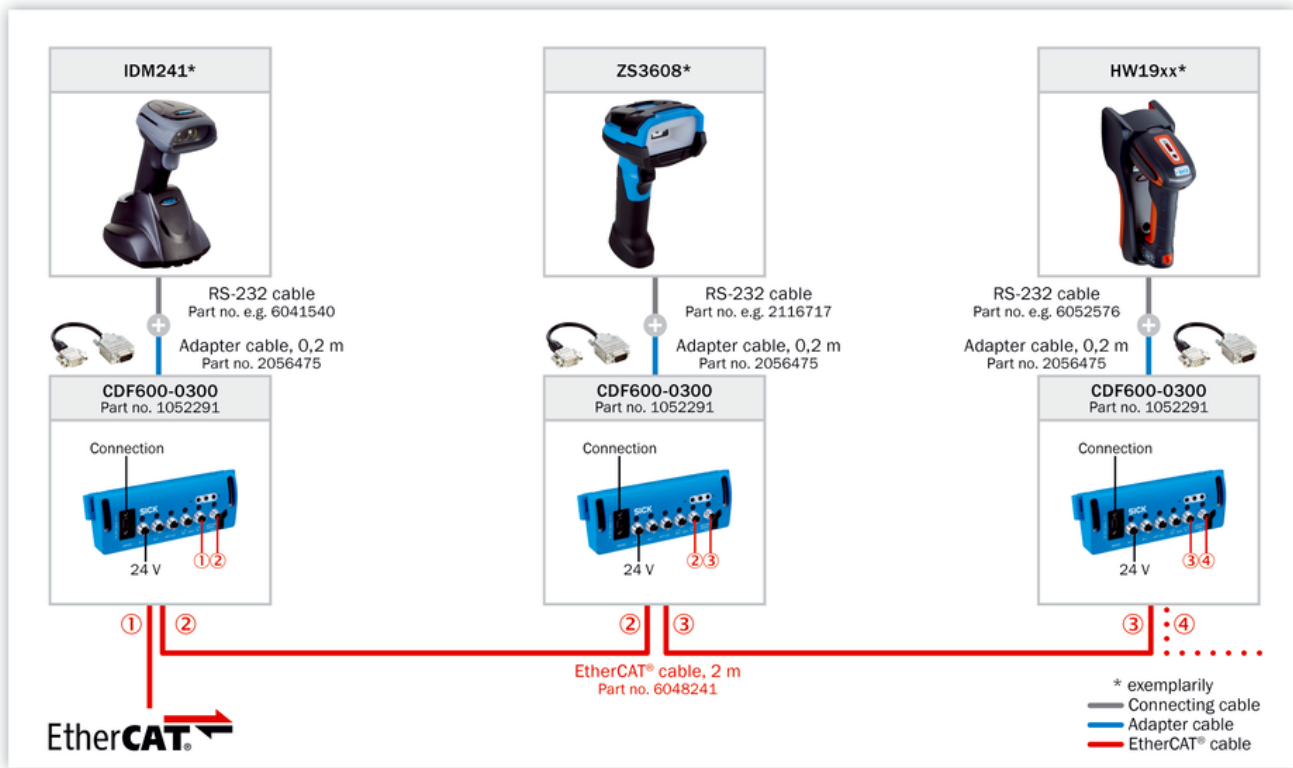

DeviceNet™

DeviceNet™

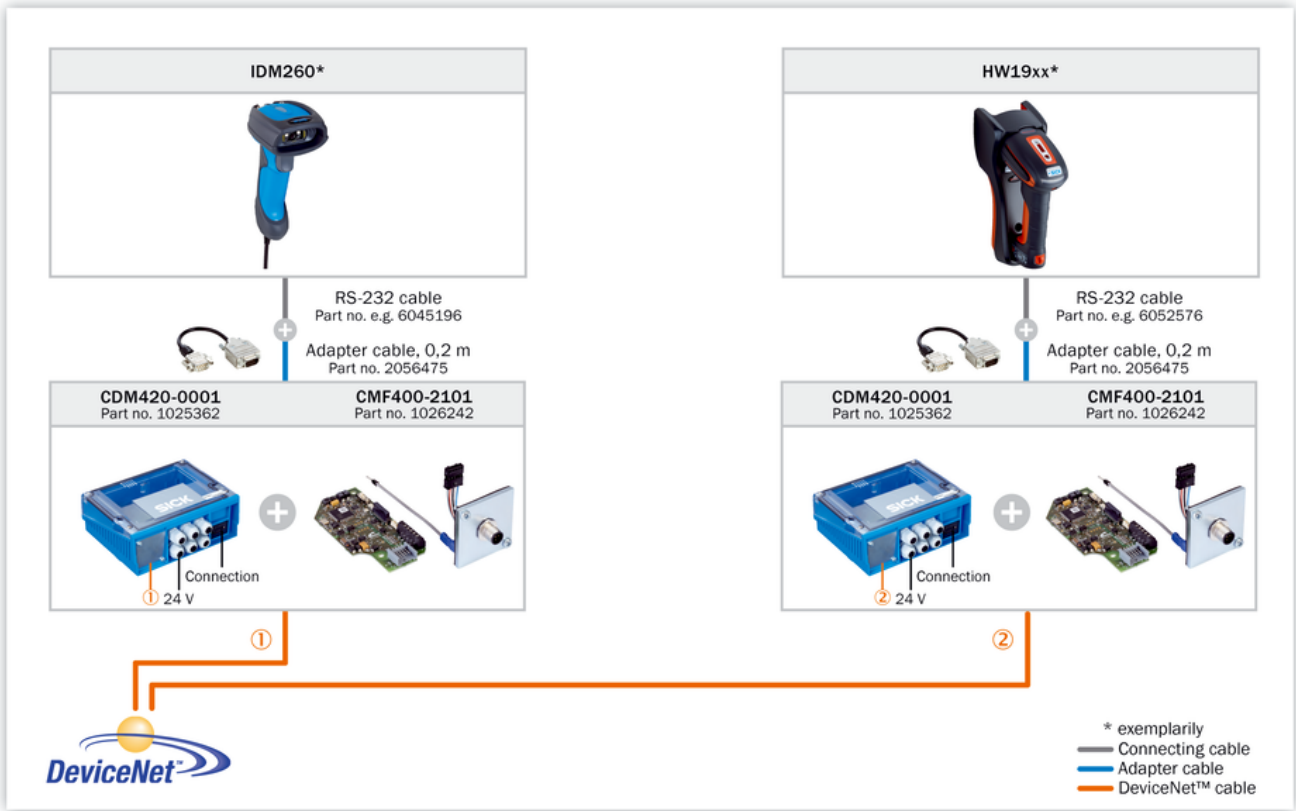





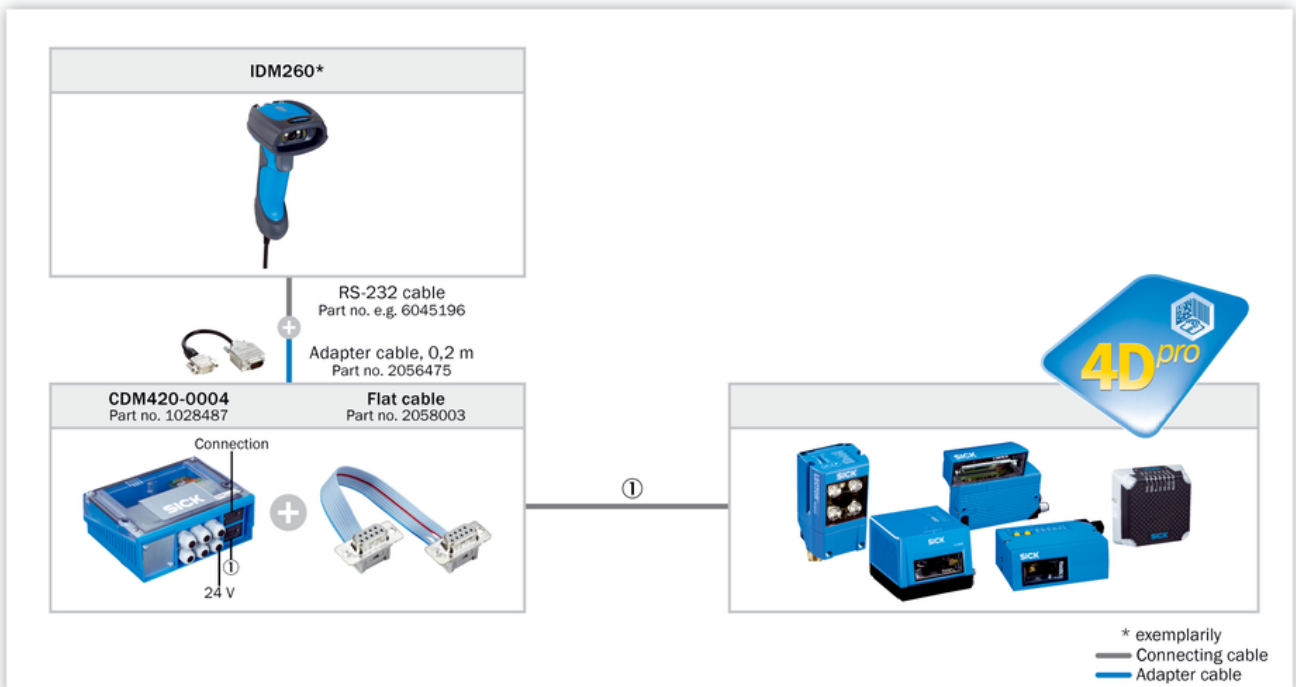

AUX looping

Looping-in via AUX



Recommended accessories

Other models and accessories → www.sick.com/IDM26x

	Brief description	Type	Part no.
Other mounting accessories			
	Tripod mount	Stand mount	6045193
	Desk holder	Table mount	6045192
Power supply units and power supply cables			
	Power supply, input AC 100 ... 240 V, output DC 5 V/2 A (necessary when using RS-232 TTL cable, does not fulfill medical standard EN 60601/ IEC 60601))	Power supply unit	6036722
Adapters and distributors			
	Adapter for connecting a handheld scanner to CDB620 / CDM420 / CDF600 / CD-F600-2, D-Sub 9-pin male connector, D-Sub 15-pin male connector, including 24V / 5V DC converter, AUX port adapter, for hand-held scanners to CDB620/CDM420/CDF600/CDF600-2, adapter AUX port	YMHDAC-C20XXXMDSA9	2056475
Modules and gateways			
	Connection kit for connecting a hand-held scanner to a PROFINET (Siemens) interface	Hand-held scanner PROFINET kit	1101488
Plug connectors and cables			
	Head A: male connector, USB-A Head B: male connector, RJ45 Cable: USB, unshielded, 1.8 m For keyboard wedge or USB Com Port Emulation	Connection cable	6045195
	Head A: female connector, D-Sub, 9-pin, straight Head B: male connector, RJ45 Cable: RS-232, unshielded, 1.8 m Voltage via pin 9 or external power supply required	Connection cable	6045196

Recommended services

Additional services → www.sick.com/IDM26x

	Type	Part no.
Warranty extensions		
<ul style="list-style-type: none"> • Product area: Identification solutions, machine vision, Distance sensors, Detection and ranging solutions • Range of services: The services correspond to the scope of the statutory manufacturer warranty (SICK general terms and conditions of purchase) • Duration: Five-year warranty from delivery date. 	Extended warranty for a total of five years from delivery date	1680671

SICK AT A GLANCE

SICK is one of the leading manufacturers of intelligent sensors and sensor solutions for industrial applications. A unique range of products and services creates the perfect basis for controlling processes securely and efficiently, protecting individuals from accidents and preventing damage to the environment.

We have extensive experience in a wide range of industries and understand their processes and requirements. With intelligent sensors, we can deliver exactly what our customers need. In application centers in Europe, Asia and North America, system solutions are tested and optimized in accordance with customer specifications. All this makes us a reliable supplier and development partner.

Comprehensive services complete our offering: SICK LifeTime Services provide support throughout the machine life cycle and ensure safety and productivity.

For us, that is “Sensor Intelligence.”

WORLDWIDE PRESENCE:

Contacts and other locations –www.sick.com