

Main characteristics

Eltra's metric wheels series is studied for specific industrial application where is required to measure a linear movement (i.e. continuous sheet cutting machines of wood, textiles, glass, etc.). Precise reading and high stress resistance are the main features of those encoders. The body is entirely designed of aluminium and mounted using an oscillating arm pivoted on the axial. It comes with an integrated self-lubricating compact box to assure a long operation period without any maintenance. The weighty metric wheel keeps a stable contact with the material, allowing an accurate measurement of both length and speed. The wheel surface can be in crossed-knurl aluminium, special anti-oil or anti-slide rubber.



Ordering code

Full stop to separate special versionss

RH 200 A 500 Z 5 N 8 X 3 P R . XXX											
support RH200-500	RH										
support RM500	RM										
200mm linear wheel	200										
500mm linear wheel	500										
Wheel type											
smooth	A										
knurled	B										
rubberized	C										
Resolutions											
PPR: series RM500 from 1 to 10000											
PPR: series RH200/500 from 40 to 1024											
Please, directly contact our offices for pulses availability											
Zero pulse											
without zero pulse	S										
with zero pulse	Z										
Input voltage:											
series RM500 5 ÷ 28											
series RH200/500 5 / 8 ÷ 24											
LINE DRIVER only available with input voltage 5 Vdc or 8 ÷ 24 Vdc											
Enclosure rating											
X standard IP54 RH200											
standard IP64 RH-RM500											
S optional IP66											
Bore diameter											
8 ø 8 mm RH200											
10 ø 10 mm RH-RM500											
Output types											
N NPN											
C NPN OPEN COLLECTOR											
P PUSH PULL											
L LINE DRIVER											
For optionals about output types please refer to incremental outputs section											

R radial
A axial

P cable output (standard length 0,5 m for RH200)
cable output (standard length 1,5 m for RH-RM500)

M connector MS3106E 16S-1S o 18-1S

J connector JMSP 1607 F o 1610 F

M and J connectors only available for metric wheels RH-RM500 series

R.P.M.

3 3000

Special version
code numbered
from 001 to 999

RH 200

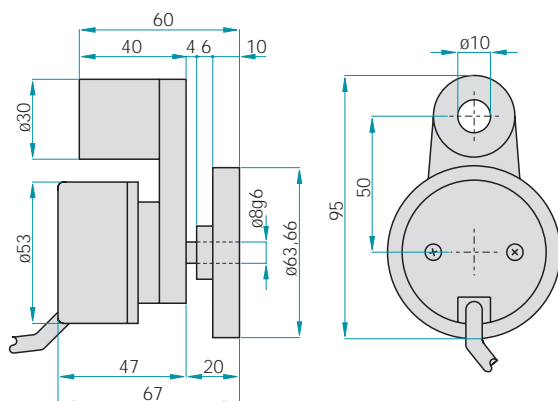

RH 500

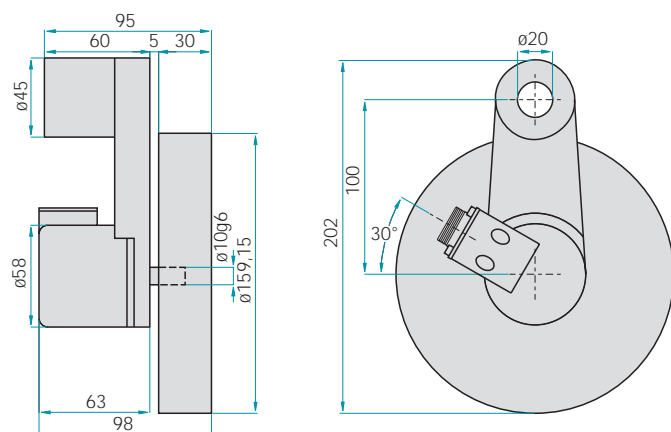

RM 500

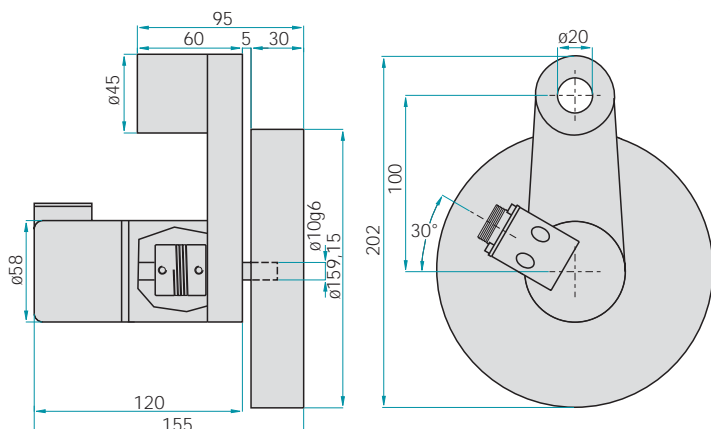

RM 500 series electrical specifications

Resolution	from 1 to 10000 PPR
Input voltage	5 ÷ 28 Vdc LINE DRIVER only available with input voltage 5/8 ÷ 24 Vdc
Input current with no output load	100 mA Max
Source and sink current	50 mA for channel 20 mA for channel with LINE DRIVER
Output types	NPN / NPN OPEN COLLECTOR / PUSH PULL / LINE DRIVER
Output frequency	300 KHz Max
Frequency response	$F = \frac{RPM \times Resolution}{60}$

RH200 series electrical specifications

Resolution	from 40 to 1024 PPR
Input voltage	5Vdc / 8 ÷ 24 Vdc
Input current with no output load	100 mA MAX
Source and sink current	50 mA for channel 20 mA for channel with LINE DRIVER
Output types	NPN / NPN OPEN COLLECTOR / PUSH PULL / LINE DRIVER
Output frequency	100 KHz Max
Frequency response	$F = \frac{RPM \times Resolution}{60}$

Mechanical specifications

Bore diameter	$\phi 8$ mm g6 RH200 $\phi 10$ mm g6 RH-RM500
Enclosure rating	IP54 standard for RH200 IP64 standard for RH-RM500 IP66 optional (only RH-RM500)
Shaft speed	3000 RPM
Shock	50 G for 11 msec (with plastic disc) 20 G for 11 msec (with glass disc)
Vibrations	10G 10 ÷ 2000 Hz
Bearings life	10 ⁹ revolutions
Bearings	n° 2 ball bearings + n° 2 ball bearings on support for RM500
Shaft material	Stainless steel AISI303
Housing material	Aluminium - UNI 5076
Support material	Aluminium - UNI 9002/5 painted
Wheel material	Aluminium - UNI 9002/5 for Sv.200 Aluminium - UNI 3051 for Sv.500
Operating temperature	0° ÷ +60°C
Storage temperature	-25° ÷ +70°C
Weight + support	250g for RH200 1000g for RM500
Wheels weights	100g for Sv.200 800g for Sv.500