

# IG5954

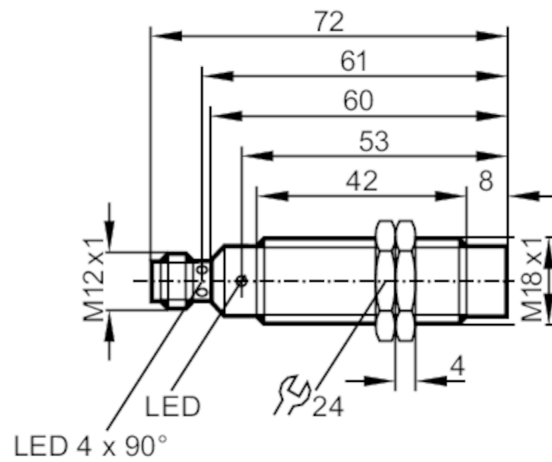

## Inductive sensor

IGK2012-FRKG/M/2LED/US-104-IRF



### Electrical data

Operating voltage [V]	10...36 DC
Protection class	II
Reverse polarity protection	yes

### Outputs

Output function	normally open / normally closed; (selectable)
Max. voltage drop switching output DC [V]	4.6
Minimum load current [mA]	4
Max. leakage current [mA]	1
Permanent current rating of switching output DC [mA]	100
Switching frequency DC [Hz]	250
Electrical design	PNP/NPN
Short-circuit protection	yes
Type of short-circuit protection	pulsed
Overload protection	yes

### Detection zone

Sensing range [mm]	12
Real sensing range $S_r$ [mm]	$12 \pm 10 \%$
Operating distance [mm]	0...9.7
Increased sensing range	yes

### Accuracy / deviations

Correction factor	steel: 1 / stainless steel: 0.7 / brass: 0.5 / aluminium: 0.5 / copper: 0.4
Hysteresis [% of $S_r$ ]	3...20
Switch point drift [% of $S_r$ ]	-10...10

# IG5954



## Inductive sensor

IGK2012-FRKG/M/2LED/US-104-IRF

Operating conditions		
Ambient temperature	[°C]	-25...70
Protection		IP 68; ("Coolant")
Tests / approvals		
EMC		EN 60947-5-2
		EN 55011
		class B
MTTF	[years]	1341
Mechanical data		
Weight	[g]	54.4
Housing		threaded type
Mounting		non-flush mountable
Dimensions	[mm]	M18 x 1 / L = 72
Thread designation		M18 x 1
Materials		brass white bronze coated; sensing face: CO-PC
Displays / operating elements		
Display	switching status	4 x 90° LED, yellow
	setting aid	1 x LED, red
Optical setting aid		yes
Accessories		
Accessories (supplied)		lock nuts: 2
Remarks		
Pack quantity		1 pcs.
Electrical connection - plug		
Connector: 1 x M12		
		

# IG5954



## Inductive sensor

IGK2012-FRKG/M/2LED/US-104-IRF

normally open

