

SITOR FUSE-LINK 630A, AC 1000V, SIZE 2



Similar to image

Technical data:

product brand name		SETRON
Current / with AC / Rated value	A	630
Operating class of the fuse link		aR
Size of fuse system / acc. to DIN EN 60269-1		NH2
Supply voltage		
• with AC / Rated value	V	1,000
Switching capacity current		
• acc. to IEC 60947-2 / Rated value	kA	100
Design of the fuse link		SITOR, LV HRC design
Design of an identification indicator		front indicator
mounting position		Any, preferably vertical
Climate class		-20 to +50 at 95% relative humidity
Ambient temperature	°C	-20 ... +50
Varying load factor (WL)		1
Active power loss	W	100
Active power loss / for rated value of the current / with AC / in hot operating state / per pole	W	100
Reference code / acc. to DIN EN 61346-2		F

Certificates/approvals:

General Product Approval



Declaration of Conformity

Further information:

Information- and Downloadcenter (Catalogs, Brochures,...)

<http://www.siemens.com/lowvoltage/catalogs>

Industry Mall (Online ordering system)

<https://eb.automation.siemens.com/mall/en/WW/Catalog/Product/3NE3336>

Service&Support (Manuals, Certificates, Characteristics, FAQs,...)

<http://support.automation.siemens.com/WW/view/en/3NE3336/all>

Image database (product images, 2D dimension drawings, 3D models, device circuit diagrams, ...)

http://www.automation.siemens.com/bilddb/cax_en.aspx?mlfb=3NE3336

CAx-Online-Generator

<http://www.siemens.com/cax>

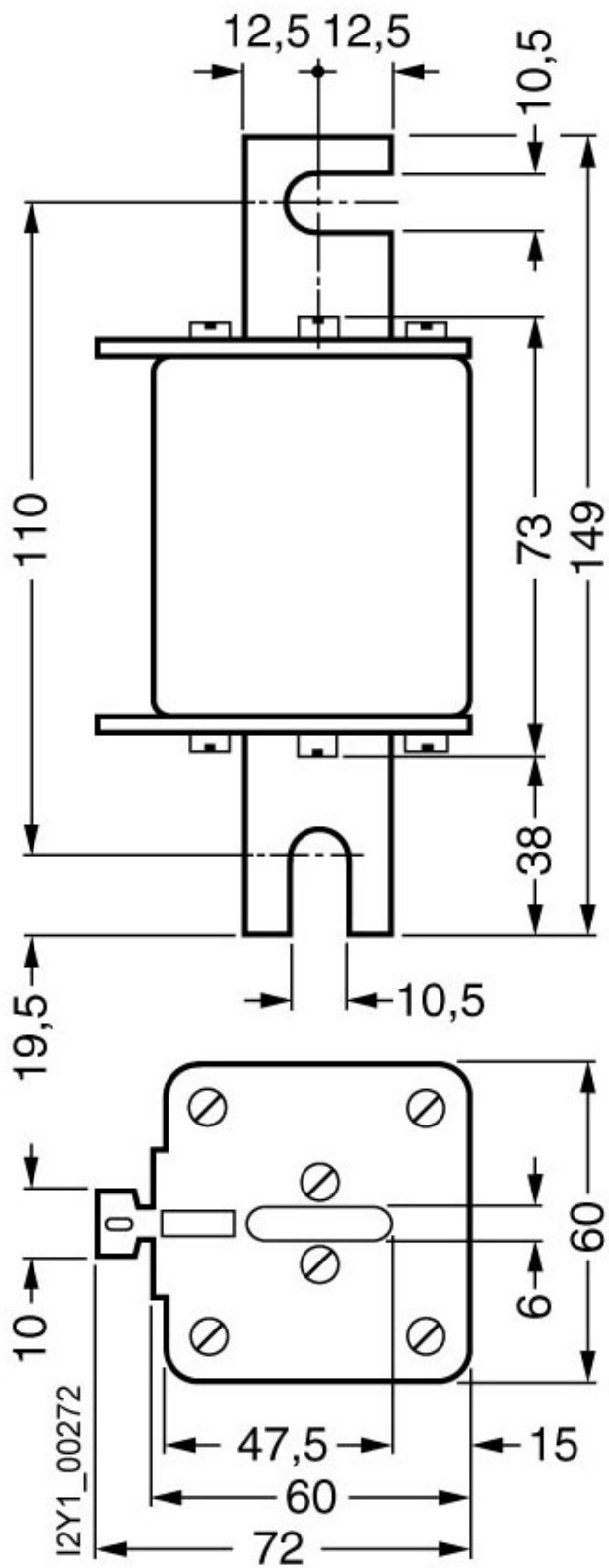

last change:

Sep 29, 2014