



!!! Phased-out product !!! The preferred successor is 3RN2010-1CW30
 Thermistor motor protection Standard evaluation unit AUTO, 1 NO + 1 NC,
 24-240 V AC/DC screw terminal

General technical data		
display version LED	Yes	
protection class IP	IP20	
reference code acc. to IEC 81346-2	K	
Substance Prohibitance (Date)	01.07.2006 00:00:00	
Product Function		
product function reclosing lockout	No	
Control circuit/ Control		
control supply voltage 1 at AC		
• at 50 Hz	24 ... 240 V	
• at 60 Hz	24 ... 240 V	
control supply voltage 1		
• at DC	24 ... 240 V	
Auxiliary circuit		
supply voltage frequency		
• 1 for auxiliary and control circuit rated value	50 Hz	
• 2 for auxiliary and control circuit rated value	60 Hz	
number of NC contacts for auxiliary contacts	1	
number of NO contacts for auxiliary contacts	1	
number of CO contacts for auxiliary contacts	0	
Main circuit		
type of voltage	AC/DC	
Connections/ Terminals		
type of electrical connection for auxiliary and control circuit	screw-type terminals	
Installation/ mounting/ dimensions		
fastening method	screw and snap-on mounting	
height	92 mm	
width	22.5 mm	
depth	91 mm	
Ambient conditions		
ambient temperature during operation	-25 ... +60 °C	
Certificates/ approvals		
General Product Approval	EMC	For use in hazardous locations



Declaration of Conformity

Test Certificates

Marine / Shipping



EG-Konf.

[Miscellaneous](#)

[Type Test Certificates/Test Report](#)



LRS



PRS



RMRS

Marine / Shipping

other



[Miscellaneous](#)

[Confirmation](#)

Further information

Information- and Downloadcenter (Catalogs, Brochures,...)

<https://www.siemens.com/ic10>

Industry Mall (Online ordering system)

<https://mall.industry.siemens.com/mall/en/en/Catalog/product?mlfb=3RN1010-1CW00>

Cax online generator

<http://support.automation.siemens.com/WW/CAXorder/default.aspx?lang=en&mlfb=3RN1010-1CW00>

Service&Support (Manuals, Certificates, Characteristics, FAQs,...)

<https://support.industry.siemens.com/cs/ww/en/ps/3RN1010-1CW00>

Image database (product images, 2D dimension drawings, 3D models, device circuit diagrams, EPLAN macros, ...)

http://www.automation.siemens.com/bilddb/cax_de.aspx?mlfb=3RN1010-1CW00&lang=en

Characteristic: Derating

<https://support.industry.siemens.com/cs/ww/en/ps/3RN1010-1CW00/manual>

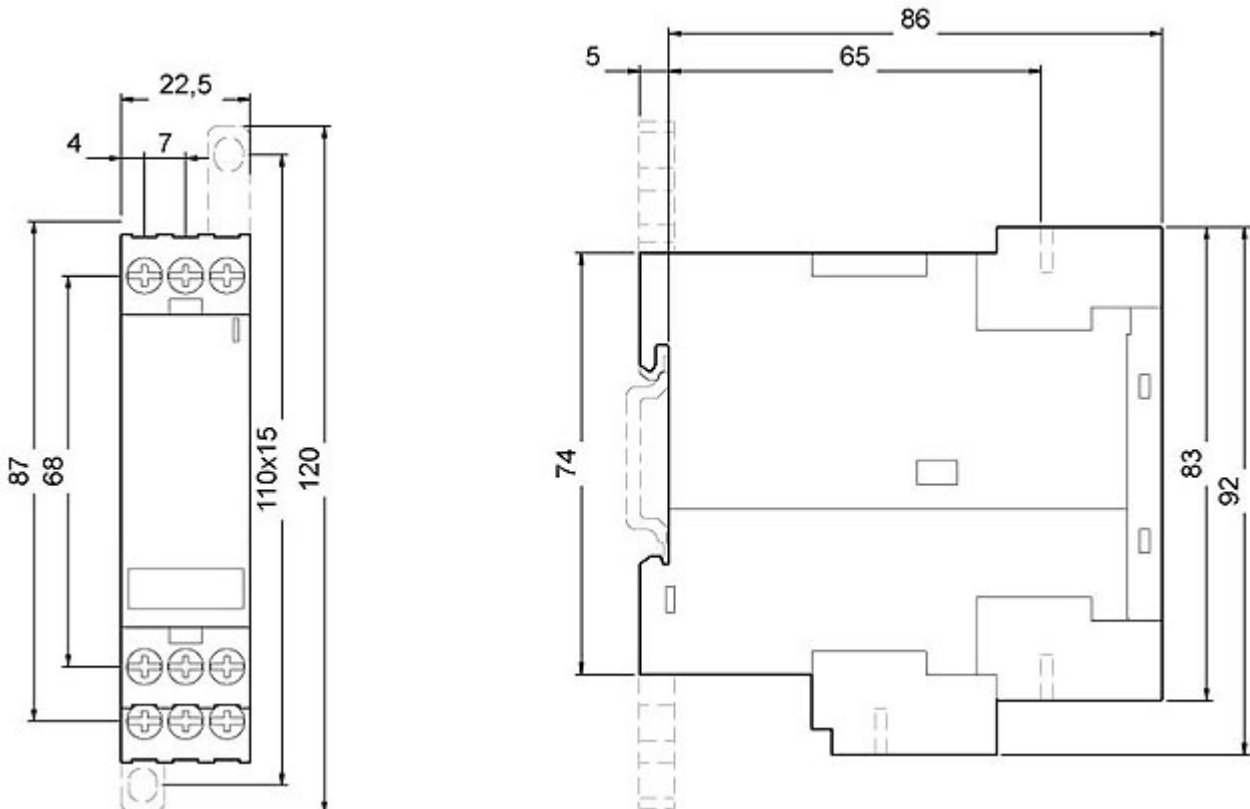

last modified:

12/21/2020 