

## Switch Disconnectors 0-1

### Four Hole Panel Mounting



Thermal Current I <sub>th</sub> (A)	Switch code	Ratings AC-23A Breaking capacity (kW)	Max wire gage mm <sup>2</sup>
-------------------------------------	-------------	---------------------------------------	-------------------------------

#### 3-pole switches, IP 66

20	KG10A T303 E	5.5/120	2,5
20	KG10B T303 E	5.5/120	2,5
25	KG20A T303 E	7.5/180	6
25	KG20B T303 E	7.5/180	6
32	KG32A T303 E	11/220	6
32	KG32B T303 E	11/220	6
40	KG41 T303 E	15/300	16
40	KG41B T303 E	15/300	16
63	KG64 T303 E	22/350	16
63	KG64B T303 E	22/350	16
80	KG80 T303 E	30/560	50
80	KG80C T303 E	30/560	50
100	KG100 T303 E	37/650	50
100	KG100C T303 E	37/650	50
125	KG125 T303 E	45/750	95
160	KG160 T303 E	55/850	95
200	KG210 T303 E	75/1100	185
250	KG250 T303 E	90/1380	185
315	KG315 T303 E	110/1650	185

#### For KG10A - KG100C

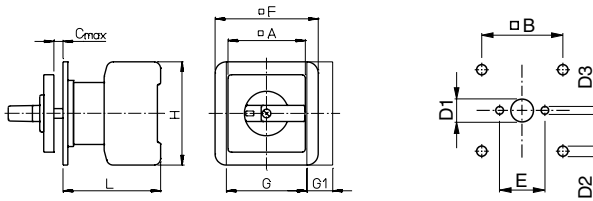

	A	B	C	D1	D2	F	G	G1 <sup>1</sup>	H	L
KG10A	48	36	4	11-15	5	48	48	-	50	48,2
KG10B	64	48	4	11-15	5	64	48	-	50	56,7
KG20A, KG32A	48	36	4	10-15	5	48	42	13,5	54	53,8
KG20B, KG32B	64	48	4	10-15	5	64	42	13,5	54	53,8
KG41B, KG64B	64	48	4	10-15	5	64	50	16	64	60,5
KG80, KG100	64	48	4	10-15	5	70	70	22	80	70,6
KG80C, KG100C	88	68	4	13-17	6	88	70	22	80	70,6

#### For KG125 - KG315

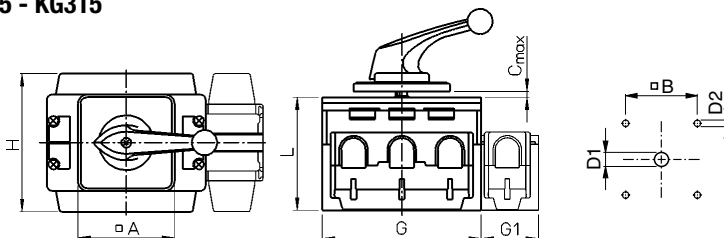

	A	B	C	D1	D2	G	G1 <sup>1</sup>	H	L
KG125, KG160	88	68	5,5	13-17	6	112	38	108	96
KG210, KG250, KG315	88	68	5,5	13-17	6	145	52,5	126	103

<sup>1</sup> for ON/OFF switches 4 pole.