

## TZ1LE024SR11 (ORDER NO. 070828)

### Safety switch TZ, plug connector SR11

- ▶ Auxiliary release on the front
- ▶ Two LED indicators, red and green
- ▶ Plug connector SR11
- ▶ Actuating head fitted left



### Description

#### Approach direction

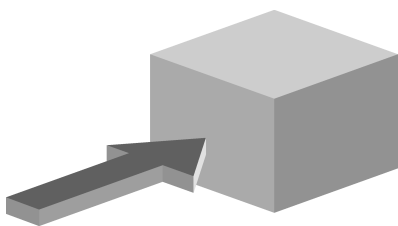

Horizontal

Can be adjusted in 90° steps

#### Solenoid operating voltage and LED function display

- ▶ 24 V AC/DC -15%, +10%

#### Guard locking type

TZ1 Closed-circuit current principle, guard locking by spring force. Release by applying voltage to the solenoid.

#### Switching element

- SK For monitoring the door/actuator position  
ÜK For monitoring the guard locking (built-in solenoid)  
528H Slow-action switching contact 1 NC  + 1 NO

#### Auxiliary release

Is used for releasing the guard locking with the aid of a tool. Sealing can be fitted to protect against tampering. Lead seal kit and tool included (already pre-assembled on versions with plug connectors).

## Function drawings

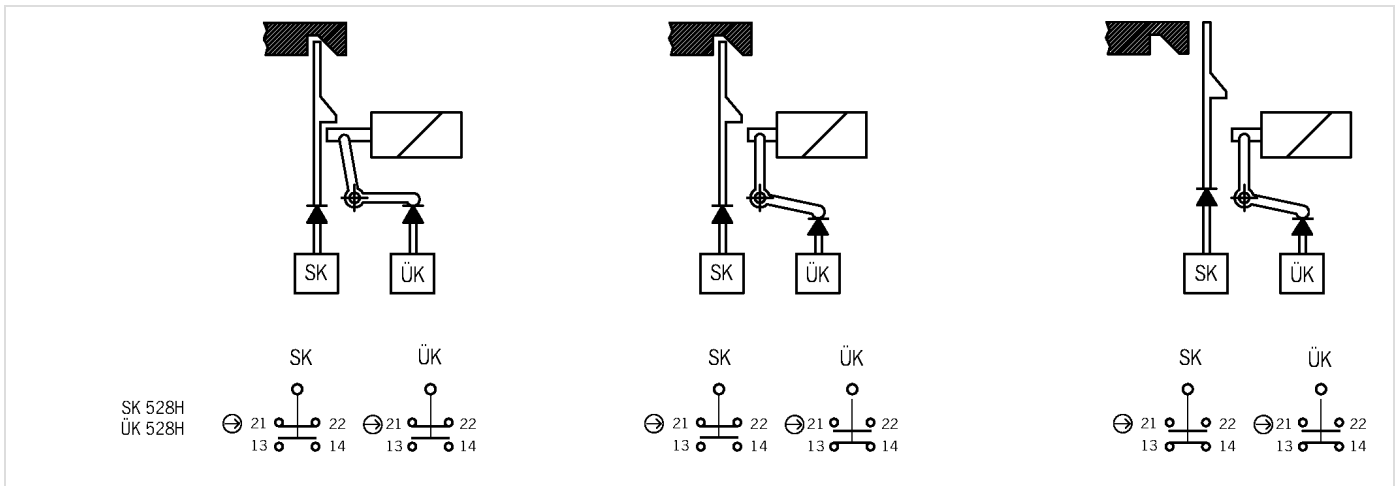

## Dimension drawings

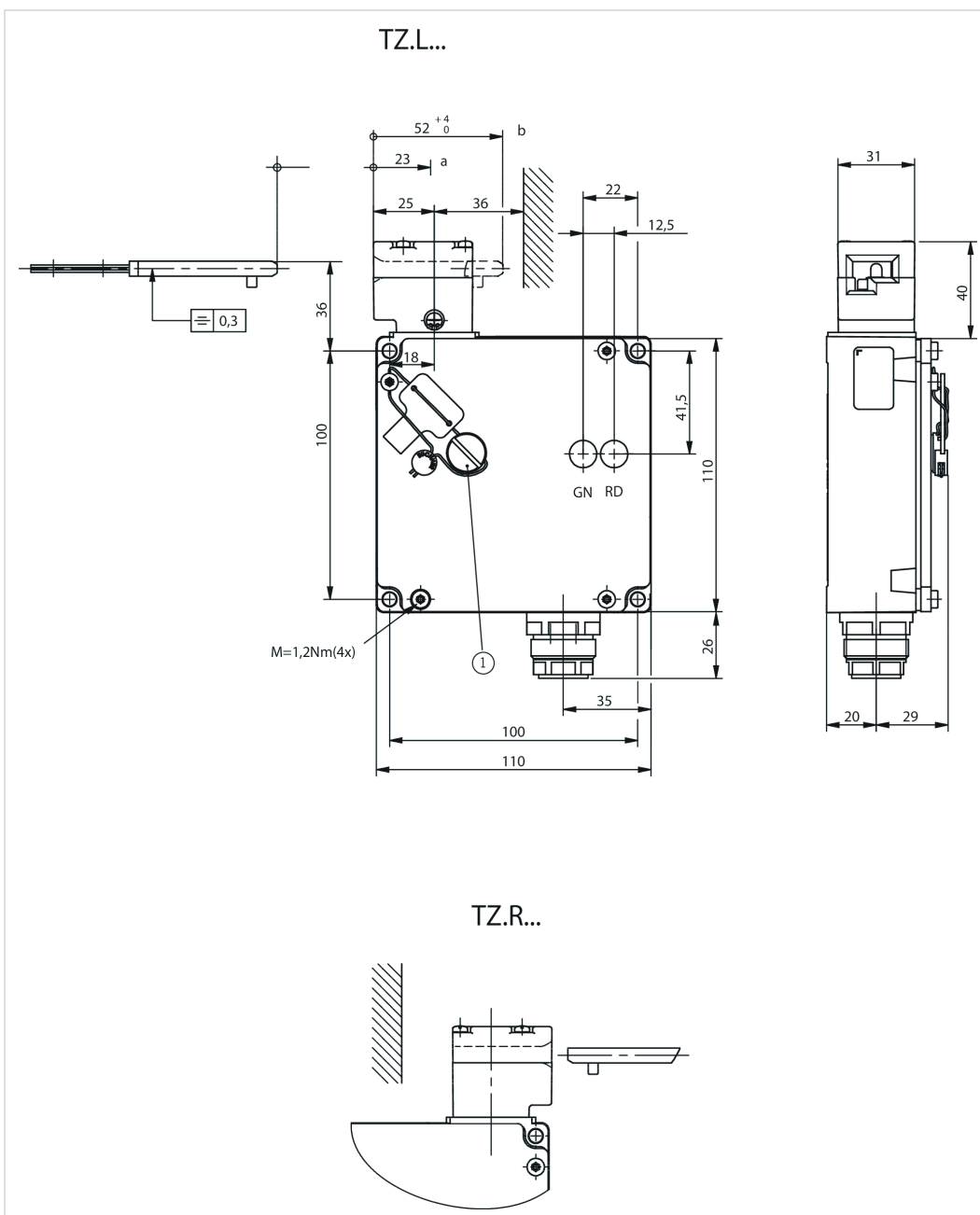

## Connection examples

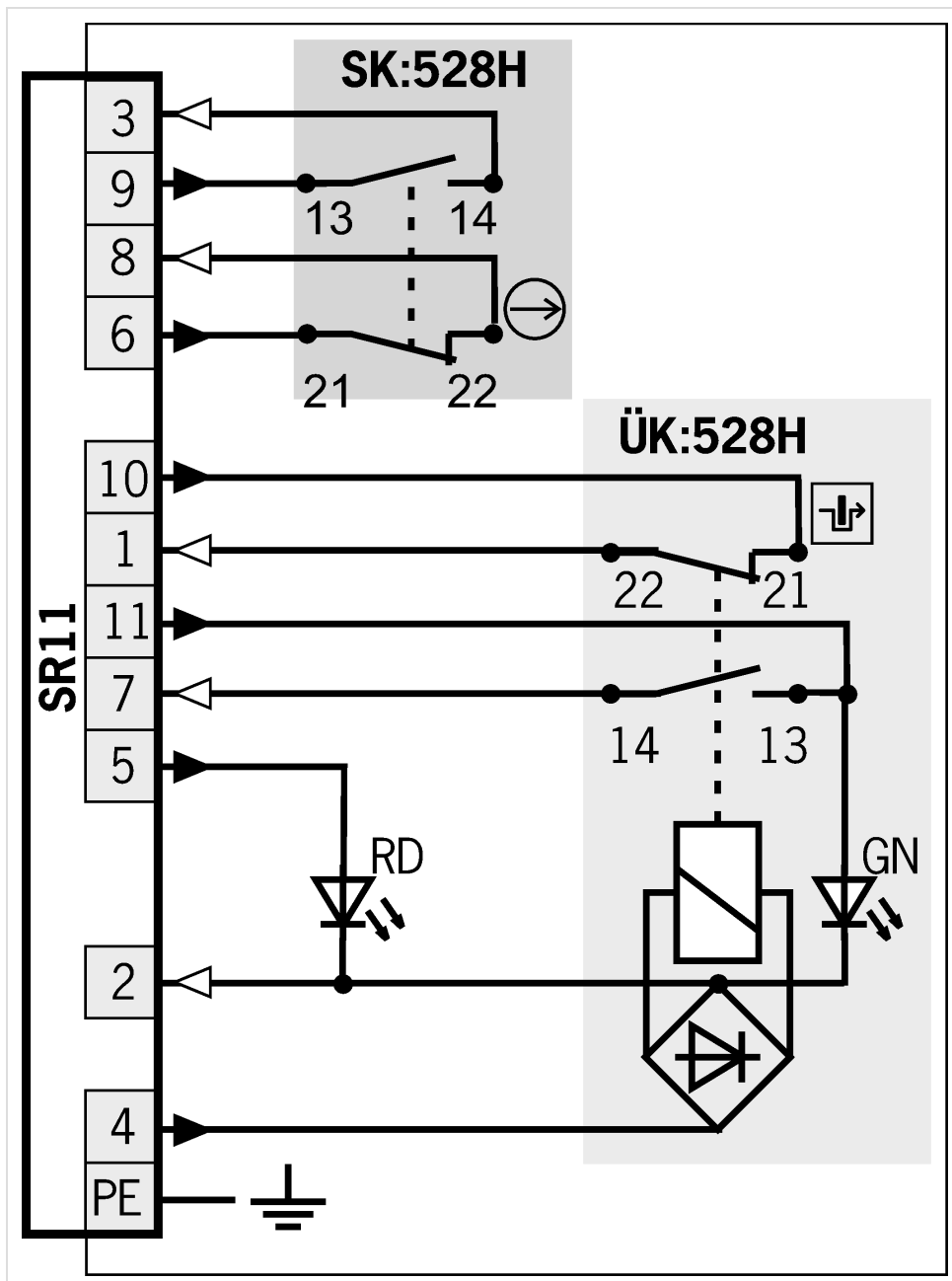

## Technical data

### Approvals



### Controls and indicators

LED indicator

Operating voltage corresponds to the solenoid voltage  
(2 LEDs; green, red)

### Electrical connection ratings

Power consumption	10 W
Rated impulse withstand voltage $U_{imp}$	1.5 kV
Rated insulation voltage $U_i$	50 V
Short circuit protection according to IEC 60269-1	4A gG (70 °C = 2A gG)
Solenoid duty cycle	100 %
Solenoid operating voltage	AC/DC 24 V -15% ... +10%
Switching current	min. at 24 V 1 mA
Switching voltage	min. at 10 mA 12 V
thermal rated current $I_{th}$	4 A (70 °C = 2 A)
Utilization category	AC-15 4A 50V (70 °C = 2 A)
	DC-13 4A 24V (70 °C = 2 A)

## Mechanical values and environment

Actuating force	35 N
Actuation frequency	max. 1200 1/h
Ambient temperature	-25 ... +80 °C
Approach direction	
	Actuating head left C
Approach speed	max. 20 m/min
Connection	
	1 x Plug connector SR11 (11-pin + PE)
Degree of protection	IP65
Extraction force	30 N
Guard locking principle	Closed-circuit current principle
Insertion depth	52 mm
Installation orientation	any
Lid	black
Locking force $F_{max}$	2000 N
Locking force $F_{Zh}$	1500 N
Material	
	Contact Silver alloy, gold flashed
	Housing Anodized die-cast alloy
Mechanical life	1 x 10 <sup>6</sup>
Number of door position NO contacts	1
Number of door position positively driven contacts	1
Number of guard lock monitoring NO contacts	1 switches green LED
Number of guard lock monitoring positively driven contacts	1
Retention force	10 N
Switching principle	Slow-action switching contact

## Reliability values according to EN ISO 13849-1

	<b>Control of guard locking</b>
Category	Depending on external control of guard locking
Performance Level	Depending on external control of guard locking (LEDs have the same ground potential as the guard locking solenoid)
PFHd	Depending on external control of guard locking (LEDs have the same ground potential as the guard locking solenoid)
	<b>Monitoring of guard locking and the guard position</b>
B10d	3 x 10 <sup>6</sup>

## In combination with Betätiger BETAETIGER-Z-GN

Overtravel	16 mm
------------	-------

## In combination with Betätiger BETAETIGER-Z-G

Overtravel	4 mm
------------	------

## Accessories

### Actuator

## Actuator for safety switches NZ.VZ, NZ.VZ.VS and TZ

---



**016849**  
BETAETIGER-Z-G

- ▶ Two stainless-steel safety screws per actuator

## Hinged actuator, right, for safety switches NZ.VZ, NZ.VZ.VS and TZ

---

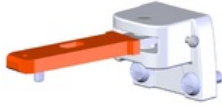

**024299**  
RADIUSBETAETIGER-Z-R

- ▶ Two stainless-steel safety screws per actuator

## Connection material

### Connecting cable with plug connector SR11, 10 m

---



**077630**  
C-M26F12-12X1,00PU10,0-MA-077630

- ▶ Female plug SR11, 11-pin + PE
- ▶ Straight plug connector
- ▶ PUR cable
- ▶ Cable length 10 m
- ▶ With flying lead

### Connecting cable with plug connector SR11, 10 m, angled

---



**077636**  
C-M26F12-12X1,0PU10,0-MA-077636

- ▶ Female plug SR11, 11-pin + PE
- ▶ Angled plug connector
- ▶ PUR cable
- ▶ Cable length 10 m
- ▶ With flying lead

### Connecting cable with plug connector SR11, 15 m

---



**077631**  
C-M26F12-12X1,00PU15,0-MA-077631

- ▶ Female plug SR11, 11-pin + PE
- ▶ Straight plug connector
- ▶ PUR cable
- ▶ Cable length 15 m
- ▶ With flying lead

### Connecting cable with plug connector SR11, 15 m, angled

---



**077637**  
C-M26F12-12X1,0PU15,0-MA-077637

- ▶ Female plug SR11, 11-pin + PE
- ▶ Angled plug connector
- ▶ PUR cable
- ▶ Cable length 15 m
- ▶ With flying lead

### Connecting cable with plug connector SR11, 20 m

---



**096632**  
C-M26F12-12X1,0PU20,0-MA-096632

- ▶ Female plug SR11, 11-pin + PE
- ▶ Straight plug connector
- ▶ PUR cable
- ▶ Cable length 20 m
- ▶ With flying lead

### Connecting cable with plug connector SR11, 25 m

## Connecting cable with plug connector SR11, 25 m

---



**094749**  
C-M26F12-12X1,0PU25,0-MA-094749

- ▶ Female plug SR11, 11-pin + PE
- ▶ Straight plug connector
- ▶ PUR cable
- ▶ Cable length 25 m
- ▶ With flying lead

## Connecting cable with plug connector SR11, 5 m

---



**077629**  
C-M26F12-12X1,0PU05,0-MA-077629

- ▶ Female plug SR11, 11-pin + PE
- ▶ Straight plug connector
- ▶ PUR cable
- ▶ Cable length 5 m
- ▶ With flying lead

## Connecting cable with plug connector SR11, 5 m, angled

---



**077635**  
C-M26F12-12X1,0PU05,0-MA-077635

- ▶ Female plug SR11, 11-pin + PE
- ▶ Angled plug connector
- ▶ PUR cable
- ▶ Cable length 5 m
- ▶ With flying lead

## Plug connector SR11 for safety switches NZ and TZ

---

**070859**  
SR11EF

- ▶ Crimp contacts
- ▶ Cable optional
- ▶ Coding shells

**091296**  
SR11AM2-M20

- ▶ Crimp contacts
- ▶ Cable optional
- ▶ Coding shells

**054773**  
SR11WF

- ▶ Crimp contacts
- ▶ 90° angled optional
- ▶ Cable optional
- ▶ Coding shells

## Function expansion

## Adapter NZ/TZ 45/30

---



**079033**  
ADAPTER NZ/TZ 45/30

- ▶ The adapter NZ/TZ 45/30 is used to compensate for different profiles, doors/frame 45/30

## Lockout bar NZ.VZ/TZ, 3 holes

---



**046730**  
SPERREINSATZ-Z-046730

- ▶ Prevents unintentional closing of the door
- ▶ Can be secured with padlocks



**091305**  
SPERREINSATZ MIT KETTE

- ▶ Prevents unintentional closing of the door
- ▶ Can be secured with padlocks

## Lockout bar NZ.VZ/TZ, 5 holes

---

**086538**  
SPERREINSATZ-Z-086538

- ▶ Prevents unintentional closing of the door
- ▶ Can be secured with padlocks

## Protective plate NZ.VZ/TZ

---

**059136**  
SCHUTZBLECH NZ/TZ

## Mechanical actuators

### Actuator for safety switches NZ.VZ, NZ.VZ.VS and TZ

---



**074411**  
BETAETIGER-Z-G/V25

- ▶ Two stainless-steel safety screws per actuator
- ▶ Packaging unit 25 pieces



**072251**  
BETAETIGER-Z-GN

- ▶ Two stainless-steel safety screws per actuator



**097436**  
BETAETIGER-Z-GME

- ▶ Made of solid stainless steel
- ▶ Two stainless-steel safety screws per actuator



## Hinged actuator, bottom, for safety switches NZ.VZ, NZ.VZ.VS and TZ

---



**074414**  
RADIUSBETAETIGER-Z-U/V25

- ▶ Two stainless-steel safety screws per actuator
  - ▶ Packaging unit 25 pieces
- 



**048850**  
RADIUSBETAETIGER-Z-U

- ▶ Two stainless-steel safety screws per actuator
- 

## Hinged actuator, left, for safety switches NZ.VZ, NZ.VZ.VS and TZ

---

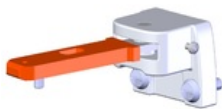

**024298**  
RADIUSBETAETIGER-Z-L

- ▶ Two stainless-steel safety screws per actuator
- 

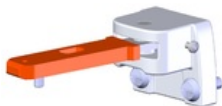

**074413**  
RADIUSBETAETIGER-Z-L/V25

- ▶ Two stainless-steel safety screws per actuator
  - ▶ Packaging unit 25 pieces
- 



**100407**  
RADIUSBETAETIGER-Z-L-C2194

- ▶ Two stainless-steel safety screws per actuator
  - ▶ Smaller door radii
- 

## Hinged actuator, right, for safety switches NZ.VZ, NZ.VZ.VS and TZ

---



**100406**  
RADIUSBETAETIGER-Z-R-C2194

- ▶ Two stainless-steel safety screws per actuator
  - ▶ Smaller door radii
- 

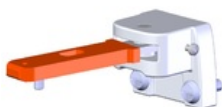

**074412**  
RADIUSBETAETIGER-Z-R/V25

- ▶ Two stainless-steel safety screws per actuator
  - ▶ Packaging unit 25 pieces
- 

## Hinged actuator, top, for safety switches NZ.VZ, NZ.VZ.VS and TZ

---



**074415**  
RADIUSBETAETIGER-Z-O/V25

- ▶ Two stainless-steel safety screws per actuator
  - ▶ Packaging unit 25 pieces
- 



**057950**

- ▶ Two stainless-steel safety screws per



057530  
RADIUSBETAETIGER-Z-O

- ▶ Two stainless-steel safety screws per actuator

## Metal bolt

### Bolt BTC-TZ00... without escape release for safety switch TZ



106280  
BTC-TZ00-C-TH-00-X

- ▶ Aluminum bolt
- ▶ For doors hinged on the left
- ▶ Can be locked in open position with padlocks
- ▶ Actuator included

### Bolt TZ-C... for safety switch TZ



079799  
RIEGEL TZ-C-NIRO

- ▶ Stainless steel bolt
- ▶ For doors hinged on the left
- ▶ Can be locked in open position with padlocks
- ▶ Actuator and switch bracket included



096058  
RIEGEL TZ-C-NIRO-C2101

- ▶ Stainless steel bolt
- ▶ For doors hinged on the left
- ▶ Can be locked in open position with padlocks
- ▶ Actuator and switch bracket included



117194  
RIEGEL TZ-C-NIRO-C2392

- ▶ Stainless steel bolt
- ▶ For doors hinged on the left
- ▶ Can be locked in open position with padlocks
- ▶ Actuator and switch bracket included



057737  
RIEGEL TZ-C

- ▶ Steel bolt
- ▶ For doors hinged on the left
- ▶ Can be locked in open position with padlocks
- ▶ Actuator and switch bracket included

### Bolts NZ/TZ-S1 and NZ/TZ-S2 for safety switches NZ.VZ, NZ.VZ.VS and TZ



028357  
RIEGEL NZ/TZ-S1

- ▶ Aluminum bolt
- ▶ For doors hinged on the left or right. Cone grip bottom.
- ▶ Spring catch in open position
- ▶ Can be locked in open position with padlocks
- ▶ Actuator included



028359  
RIEGEL NZ/TZ-S2

- ▶ Aluminum bolt
- ▶ For doors hinged on the left or right. Cone grip top.
- ▶ Spring catch in open position
- ▶ Can be locked in open position with padlocks
- ▶ Actuator included

## Mounting accessories

## Mounting plates EMP-B1 for actuators for safety switches CTP, CTA, TP...A, STA, STP, TX and TZ

---



**093457**  
EMP-B1

## Mounting plates EMP-B2 for actuators for safety switches CTP, CTA, TP...A, STA, STP, TX and TZ

---



**093458**  
EMP-B2

## Mounting plates EMP-SA for safety switch TZ

---

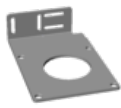

**094401**  
EMP-SA

- ▶ For vertical and horizontal mounting of safety switch TZ

## Safety screws M5 x 10

---

**073455**  
M5X10-NIRO/V100 NZ/TZ

- ▶ Safety screws M5 x 10
- ▶ Packaging unit 100 pieces

## Safety screws M5 x 16

---

**073456**  
M5X16/V100

- ▶ Safety screws M5 x 16
- ▶ Packaging unit 100 pieces

## Safety screws for actuators, M5 x 25

---

**073457**  
M5X25/V100

- ▶ Safety screws M5 x 25
- ▶ Packaging unit 100 pieces

## Spare parts

048257  
PLOMBENSATZ TZ

## Contacts

🏠 EUCHNER GmbH + Co. KG  
Kohlhammerstraße 16  
70771 Leinfelden-Echterdingen

☎ +49 711 7597-0

📠 +49 711 753316

✉ info(at)euchner.de