

# GG BS88 Centre bolted tags fuse links



## Product description

Eaton's Bussmann® series GG British Standard fuse links are specifically designed for the protection of general industrial applications e.g. power distribution and cable protection.

## Standard features

- Good peak let-through current limitation
- 1:1:6 Selective coordination ratio between "minor" and "major" fuse
- Power loss values well within the limits of IEC 60269-2

**Catalogue symbol:**

- GG(Amps)

**Technical data:**

- Rated voltage: 550 V a.c. / 250 V d.c.
- Rated current: 710 to 1250 A
- Breaking capacity: 80 kA a.c. / 40 kA d.c.
- Breaking range and utilisation category: gG

**Standards/Approvals:**

- BS88-1
- IEC 60269-1
- Suitable for use in RoHS compliant applications

**Packaging:**

- MOQ 1

**Table 1. Technical data**

Part number	Rated voltage	Rated current (Amps)	Energy integrals I <sup>2</sup> t (A <sup>2</sup> S)		Watts loss W	Dimensions (mm)										Product class	Weight
			Pre-arcing	Total at 415 V a.c.		A	B	C	D	E	F	G	H	J			
GG710	550 V a.c. 250 V d.c.	710	3500	8100	53	262	231	77.5	10.5	15.5	38	165	83	6.4	gG	2.7Kg	
GG800	550 V a.c. 250 V d.c.	800	5000	11,500	64	262	231	77.5	10.5	15.5	38	165	83	6.4	gG	2.7Kg	
GG1000	550 V a.c.	1000	6800	16,000	69	262	228.5	84	10.5	15.5	38	165	100	12.7	gG	2.8Kg	
GG1250	550 V a.c.	1250	14,000	30,000	85	262	228.5	84	10.5	15.5	38	165	100	12.7	gG	2.8Kg	

**Outline drawing**

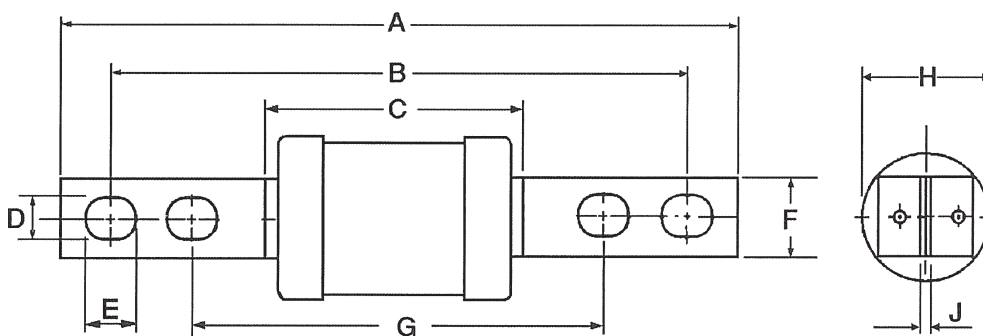

**Time-current curve**

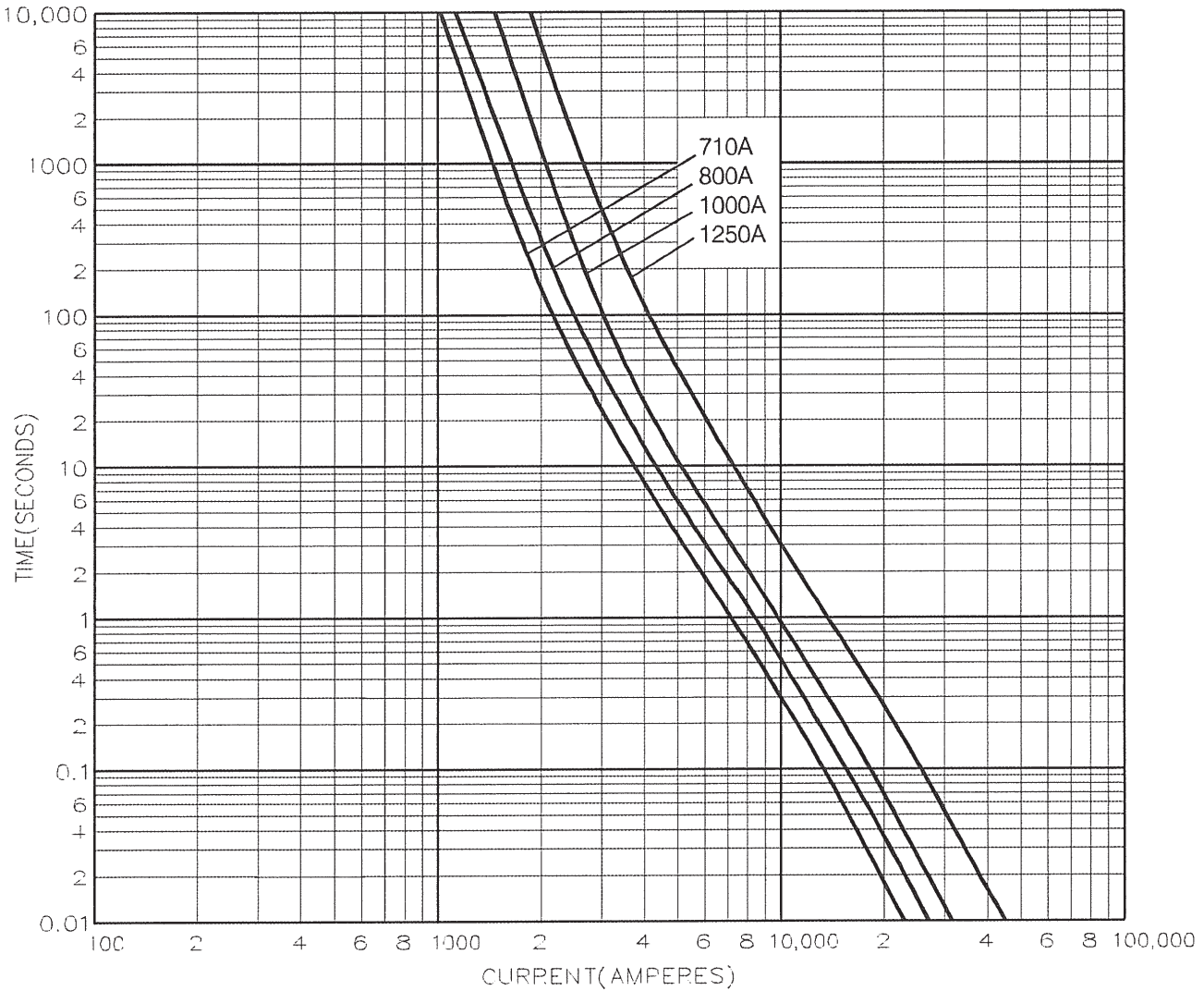

Changes to the products, to the information contained in this document, and to prices are reserved; so are errors and omissions. Only order confirmations and technical documentation by Eaton is binding. Photos and pictures also do not warrant a specific layout or functionality. Their use in whatever form is subject to prior approval by Eaton. The same applies to Trademarks (especially Eaton, Moeller, and Cutler-Hammer). The Terms and Conditions of Eaton apply, as referenced on Eaton Internet pages and Eaton order confirmations.

**Eaton**  
 EMEA Headquarters  
 Route de la Longeraie 7  
 1110 Morges, Switzerland

Eaton Electrical Products Limited  
 Melton Road  
 Burton-on-the-Wolds  
 Leicestershire, LE12 5TH  
 United Kingdom

© 2017 Eaton  
 All Rights Reserved  
 PDF Only  
 Publication No. 4104  
 October 2017

Eaton is a registered trademark.

All other trademarks are property of their respective owners.