



# Read/write station IQT-F116-R4M-V1

- Operating frequency 13.56 MHz
- Conforms to ISO 15693
- Connection via V1 (M12 x 1) plug connection
- RS 485 Multidrop

HF R/W system, ISO 15693



## Dimensions

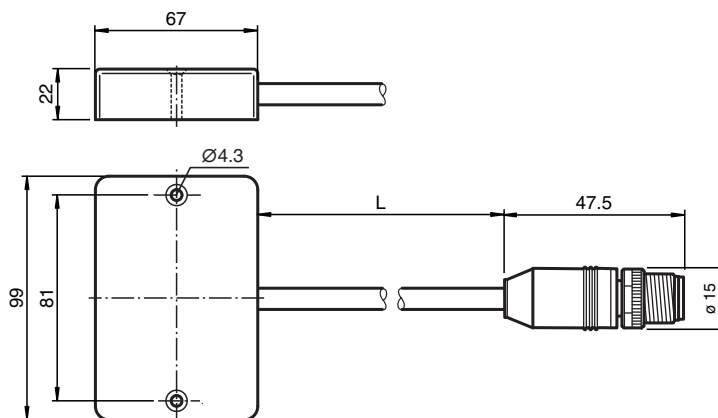

## Technical Data

General specifications	
Operating frequency	13.56 MHz
Transfer rate	26 kBit/s
Sensing range	
Read distance	0 ... 130 mm
Write distance	0 ... 130 mm
Width	max. 100 mm
UL File Number	E87056
Electrical specifications	
Rated operating voltage	$U_e$ 17.5 ... 30.6 V DC , ripple 10 % <sub>SS</sub> , limited power source (EN 60950)
Power consumption	$P_0$ ≤ 1.2 W
Mag. Field strength	<19 dB $\mu$ A/m at 10 m
Interface	
Physical	RS-485 multidrop
Protocol	ASCII
Transfer rate	38400 Bit/s

Release date: 2020-03-23 Date of issue: 2020-03-27 Filename: 223791\_eng.pdf

Refer to "General Notes Relating to Pepperl+Fuchs Product Information".

Pepperl+Fuchs Group  
www.pepperl-fuchs.com

USA: +1 330 486 0001  
fa-info@us.pepperl-fuchs.com

Germany: +49 621 776 1111  
fa-info@de.pepperl-fuchs.com

Singapore: +65 6779 9091  
fa-info@sg.pepperl-fuchs.com

PEPPERL+FUCHS





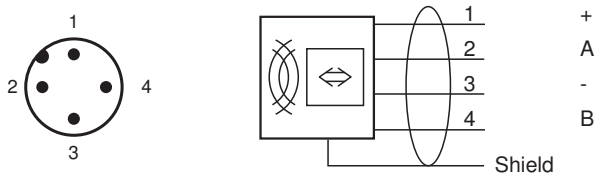

## Technical Data

Cable length	≤ 3 m
<b>Compliance with standards and directives</b>	
Directive conformity	
R&TTE Directive 1995/5/EC	EN 301489-1 V1.8.1 (2008-04), EN 301489-3 V1.4.1 (2002-08), EN 300330-2 V1.3.1 (2006-04), EN 60950-1:2006
Standard conformity	
Electromagnetic compatibility	EN 61000-6-2, EN 61000-6-4
Degree of protection	EN 60529
RFID	ISO/IEC 15693-2:2006 , ISO/IEC 15693-3:2009 , ISO/IEC 18000-3
<b>Ambient conditions</b>	
Ambient temperature	-10 ... 55 °C (14 ... 131 °F)
Storage temperature	-10 ... 55 °C (14 ... 131 °F)
<b>Mechanical specifications</b>	
Degree of protection	IP67
Connection	M12 x 1 connector
Material	
Housing	PBT
Encapsulation compound	WEVO 403FL/300
Mass	approx. 200 g
Cable length	20 cm

## Connection



## Accessories

	<b>IQC21-30P</b>	Data carrier
	<b>IQC21-50P</b>	Data carrier
	<b>IQC21-50F-T10</b>	Data carrier
	<b>IQC21-58</b>	Data carrier
	<b>IQC22-C1</b>	Data carrier
	<b>IQC21-50PVC</b>	Data carrier

## Operation

### Power supply:

The device must only be operated with a current source of limited power according EN 60950.