

SC 44.x1 pro



Retaining Clip in delivery included

- 1 or 2 channels
- Daily and weekly program
- 46 memory locations
- 10 years battery-reserve
- Minimum interval 1 min.
- Switching capacity 16 A per channel
- Permanent by date / holiday function
- Manual permanent mode
- Manual override
- Automatic sorting of switching times on readout
- Unrestricted block programming
- Fully automatic daylight saving time
- Elapsed time and pulse counter
- Pulse function
- Security by PIN-Code
- Illuminated display
- Data-key function

Further information / Accessory

Accessory: Data-key DK *pro*
and Programming package PP 50 *pro*
(not included in delivery of the time switch)



Highlights

- Text based menu and self-explanatory symbols
- Display with a large dot matrix area to provide two high resolution text lines
- Easy handling. Quick and intuitive programmable time switch
- Can be programmed with supply disconnected
- Unlimited program security by E²-PROM
- Programmable with PC
(Accessory Data-key DK *pro* and Programming package PP 50 *pro*)

basic extended premium

Digital time switch SC 44.x1 pro

for switchboard panel and wall mounting

Technical data

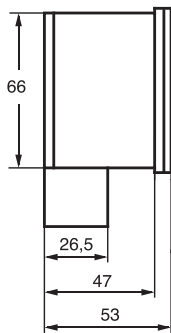
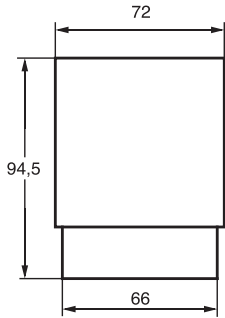

SC 44.11 pro (1 channel)

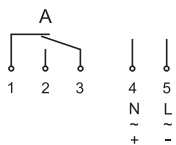

SC 44.21 pro (2 channels)

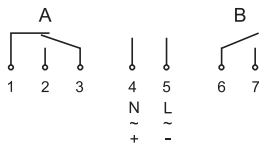

Supply voltage	230 V, 50–60 Hz other voltages on request
Power consumption (real power)	0.5–1.2 W (depending on the switching status)
Channels (potential-free)	Channel A: change-over · channel B: normally open contact gap < 3 mm (μ)
Contact material	AgNi
Switching capacity per channel	16 A / 250 V~ at cosφ=1 6 A with inductive load cosφ=0.6
Min. switching power	300 mW (5 V / 5 mA)
Max. starting current	30 A
Switching functions	ON; OFF; pulse
Pulse length Pulse function (switching time)	00:01 up to 59:59 mm:ss
Memory locations	46
Minimum interval	1 min.
Time base	Quartz
Power back-up (at 20°C)	approx. 10 years (depends on the Lithium-battery life)
Program security	unlimited (E ² -PROM)
Quartz accuracy (at 20°C)	≤ ±0.5 sec./day
Display	high resolution LCD (visible area 7.5 cm ²)
Permitted ambient temperature	–30°...+55°C
Enclosure	self-extinguishing thermoplastic
Dimensions	72 x 72 mm (to IEC 61554)
Switchboard flush mounting	Retaining clip in 68 x 68 mm cutout
Surface mounting	Wall mounting with terminal cover
Type of connection	Screw terminals
Type of protection	IP 20 to DIN EN 60529
Class of protection	II when installed according to regulations
Accessories (not included in delivery)	Data-key DK pro, Programming package PP 50 pro
Certification mark	VDE

Order number	Channels	Time base	Special function
SC 44.11 pro	1	Quartz	data-key (optional)
SC 44.21 pro	2	Quartz	data-key (optional)

▾ Housing colour