



Energy Division

Dorman Smith K Series Circuit Protection Devices

The new improved Dorman Smith miniature circuit breakers offer higher breaking capacities and a comprehensive range of residual current circuit breakers with over-current protection in single or double module configurations. Devices share the same profile and are engineered for multiple applications including installation within the Dorman Smith Loadlimiter 63 distribution board range.

Miniature Circuit Breakers (MCB)

MCB features breaking capacities up to 15kA in line with modern electrical systems where higher prospective fault levels may exist at sub and main distribution boards. Three types of characteristics B, C and D are available and the current rating span of 1A-63A offers a flexible solution to commercial and industrial applications.

Features

- Exceeds the requirements of EN60898
- Rated breaking capacity up to 10kA to EN60898
- Rated breaking capacity up to 15kA to EN 60947-2
- Contact position indicator
- 35mm² cable capacity
- Multiples of 17.5mm width

Benefits

- Shielded dual terminals
- Green/red indicators give positive confirmation of contact position
- Padlocking device can be fitted
- Shunt trip and Auxiliary contact can be fitted to 1P and 2P devices

Dimensions

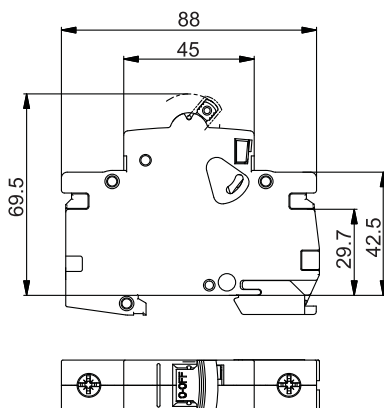

Catalogue Numbers

	1P cat. no.	2P cat. no.	3P cat. no.
B TYPE	K1PB06	K2PB06	K3PB06
	K1PB10	K2PB10	K3PB10
	K1PB13	N/A	K3PB13
	K1PB16	K2PB16	K3PB16
	K1PB20	K2PB20	K3PB20
	K1PB25	N/A	K3PB25
	K1PB32	K2PB32	K3PB32
	K1PB40	K2PB40	K3PB40
	K1PB50	K2PB50	K3PB50
	K1PB63	K2PB63	K3PB63

	1P cat. no.	2P cat. no.	3P cat. no.
C TYPE	K1PC01**	N/A	K3PC01**
	K1PC02**	N/A	K3PC02**
	K1PC04**	N/A	K3PC04**
	K1PC06	K2PC06	K3PC06
	K1PC10	K2PC10	K3PC10
	K1PC13	N/A	K3PC13
	K1PC16	K2PC16	K3PC16
	K1PC20	K2PC20	K3PC20
	K1PC25	N/A	K3PC25
	K1PC32	K2PC32	K3PC32
K1PC40	K2PC40	K3PC40	
K1PC50	K2PC50	K3PC50	
K1PC63	K2PC63	K3PC63	

	1P cat. no.	2P cat. no.	3P cat. no.
D TYPE	K1PD01**	N/A	K3PD01**
	K1PD02**	N/A	K3PD02**
	K1PD04**	N/A	K3PD04**
	K1PD06	K2PD06	K3PD06
	K1PD10	K2PD10	K3PD10
	K1PD16	K2PD16	K3PD16
	K1PD20	K2PD20	K3PD20
	K1PD25	N/A	K3PD25
	K1PD32	K2PD32	K3PD32
	T1PD40	N/A	T3PD40
T1PD50*	N/A	T3PD50*	
T1PD63*	T2PD63*	T3PD63*	

*6kA-60898/10kA-60947-2

** non stocked items (contact customer services for availability)

RCBO – Residual Current Circuit Breakers with Over-current Protection

Recognising changes to 17th IEE Wiring Regulations and the additional requirements for residual current devices, Tyco Electronics launch a range of Dorman Smith residual current circuit breakers with over-current protection (RCBO) sharing the same profile as the MCB. Featuring a current span of 6-40A in either B or C tripping characteristics with 30m/A sensitivity for personnel protection and 100m/A for plant protection.

Single Module RCBO (Residual Current Circuit Breaker with Over-current Protection)

Features

- Exceeds the requirements of EN 61009, IEC 61009
- SP&N configuration
- Rated breaking capacity up to 10kA
- Contact position indicator
- Rated voltage Ue -230V
- Rated frequency 50Hz
- Energy limiting class 3
- Type AC
- Terminal capacity: outgoing terminals 16mm²
- Terminal capacity: busbar side terminals 35mm²
- Padlock device can be fitted
- Shunt trip device can be fitted

	Current rating (A)	30m/A cat. no.	100m/A cat. no.
B TYPE	6	KR1PB0630	KR1PB06100
	10	KR1PB1030	KR1PB10100
	16	KR1PB1630	KR1PB16100
	20	KR1PB2030	KR1PB20100
	32	KR1PB3230	KR1PB32100
	40	KR1PB4030	KR1PB40100

	Current rating (A)	30m/A cat. no.	100m/A cat. no.
C TYPE	6	KR1PC0630	KR1PC06100
	10	KR1PC1030	KR1PC10100
	16	KR1PC1630	KR1PC16100
	20	KR1PC2030	KR1PC20100
	32	KR1PC3230	KR1PC32100
	40	KR1PC4030	KR1PC40100



Dimensions

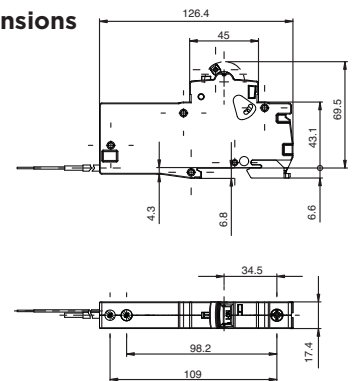

Double Module RCBO (Residual Current Circuit Breaker with Over-current Protection)

Features

- Exceeds the requirements of EN 61009, IEC 61009
- SP&SwN configuration
- Rated breaking capacity up to 10kA
- Contact position indicator
- Rated voltage Ue -230V
- Rated frequency 50Hz
- Energy limiting class 3
- Type AC
- Terminal capacity: outgoing terminals 35mm²
- Terminal capacity: busbar side terminals 35mm²

	Current rating (A)	30m/A cat. no.
B TYPE	6	KR2PB0630
	10	KR2PB1030
	16	KR2PB1630
	20	KR2PB2030
	32	KR2PB3230
	40	KR2PB4030

	Current rating (A)	30m/A cat. no.
C TYPE	6	KR2PC0630
	10	KR2PC1030
	16	KR2PC1630
	20	KR2PC2030
	32	KR2PC3230
	40	KR2PC4030



Dimensions

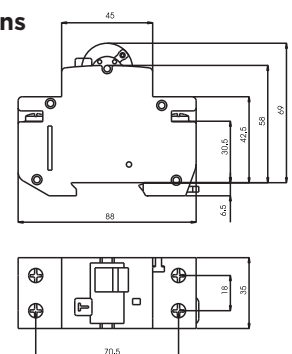

K-Series Accessories

KAUX1	K-Series auxiliary contact
KDL	K Series locking device
KST240	K-Series shunt trip 230V

While Tyco Electronics and its affiliates referenced herein have made every reasonable effort to ensure the accuracy of the information contained in this catalogue, Tyco Electronics cannot assure that this information is error free. For this reason, Tyco Electronics does not make any representation or offer any guarantee that such information is accurate, correct, reliable or current. Tyco Electronics reserves the right to make any adjustments to the information at any time. Tyco Electronics expressly disclaims any implied warranty regarding the information contained herein, including, but not limited to, the implied warranties of merchantability or fitness for a particular purpose. Tyco Electronics' only obligations are those stated in Tyco Electronics' Standard Terms and Conditions of Sale. Tyco Electronics will in no case be liable for any incidental, indirect or consequential damages arising from or in connection with, including, but not limited to, the sale, resale, use or misuse of its products. Users should rely on their own judgement to evaluate the suitability of a product for a certain purpose and test each product for its intended application. TE (logo) and Tyco Electronics are trademarks of the Tyco Electronics group of companies and its licensors. Crompton is a trademark of Crompton Parkinson and is used by Tyco Electronics under a licence. Other Trademarks mentioned herein are the property of their respective owners.

Energy Division – economical solutions for the electrical power industry: cable accessories, connectors & fittings, electrical equipment, instruments, lighting controls, insulators & insulation enhancement and surge arresters.

Tyco Electronics UK Ltd
Energy Division
Freebournes Road
Witham, Essex CM8 3AH

Phone: +44 (0)870 870 7500
Fax: +44 (0)870 240 5289
E-mail: electrical@tycoelectronics.com

www.dormansmithswitchgear.com
<http://energy.tycoelectronics.com/ds>

 **Tyco Electronics**
Our commitment. Your advantage.