



TZFS24VDC

- Thermoplastic enclosure
- Holding force 1500 N

Data

Ordering data

Product type description	TZFS24VDC
Article number (order number)	131017671
EAN (European Article Number)	8905236105999
eCl@ss number, Version 9.0	27-27-26-03
eCl@ss number, Version 11.0	27-27-26-03
ETIM number, version 7.0	EC002593
ETIM number, version 6.0	EC002593

General data

Standards	EN 60947-5-1 BG-GS-ET-19
Coding level according to ISO 14119	Low
Active principle	electromechanical
Enclosure material	Glass-fibre, reinforced thermoplastic
Material of the contacts, electrical	Silver
Gross weight	480 g

General data - Features

Power to unlock	Yes
Manual release	Yes
Number of actuating directions	4
Number of auxiliary contacts	1
Number of safety contacts	2

Safety appraisal

Standards	EN ISO 13849-1
Mission Time	20 Year(s)

Safety appraisal - Safety outputs

B10d Normally-closed contact (NC)	2,000,000 Operations
B10d Normally open contact (NO)	1,000,000 Operations

Mechanical data

Mechanical life, minimum	1,000,000 Operations
Clamping force in accordance with EN ISO 14119 F_{zh}	1,500 N
Latching force	20 N
positive break travel	3.5 mm
Positive break force, minimum	20 N
Actuating speed, maximum	0.3 m/s

Mechanical data - Connection technique

Terminal Connector	Screw terminals
Cable section, minimum	1 x 0.5 mm ²
Cable section, maximum	1 x 1.5 mm ²

Note (Cable section)

All indications about the cable section are including the conductor ferrules.

Mechanical data - Dimensions

Length of sensor	41 mm
Width of sensor	129 mm
Height of sensor	92.5 mm

Ambient conditions

Degree of protection	IP65 to EN 60529 IP67 to EN 60529
Ambient temperature, minimum	+0 °C
Ambient temperature, maximum	+50 °C

Ambient conditions - Insulation value

Rated insulation voltage U_i	250 V
Rated impulse withstand voltage U_{imp}	2.5 kV

Electrical data

Thermal test current	4 A
Rated control voltage	24 VDC
Required rated short-circuit current to EN 60947-5-1	1,000 A
Electrical power consumption, maximum	8.5 W
Switching principle	Creep circuit element

Electrical data - Safety contacts

Voltage, Utilisation category AC-15	230 VAC
Current, Utilisation category AC-15	4 A

Voltage, Utilisation category DC-13	24 VDC
Current, Utilisation category DC-13	4 A

Electrical data - Auxiliary contacts

Voltage, Utilisation category AC-15	230 VAC
Current, Utilisation category AC-15	4 A
Voltage, Utilisation category DC-13	24 VDC
Current, Utilisation category DC-13	4 A

Other data

Note (applications)	sliding safety guard removable guard hinged safety guard
---------------------	--

Scope of delivery

Included in delivery	The actuator TZ/CO is included in delivery.
----------------------	---

Notes

Note (Manual release)	For manual release using triangular key M3 (included in delivery)
-----------------------	---

Pictures

Product picture (catalogue individual photo)



ID: ktzf-f14
 | 350.6 kB | .jpg | 352.778 x 254 mm - 1000 x 720 px - 72 dpi
 | 34.7 kB | .png | 74.083 x 53.269 mm - 210 x 151 px - 72 dpi

Dimensional drawing basic component

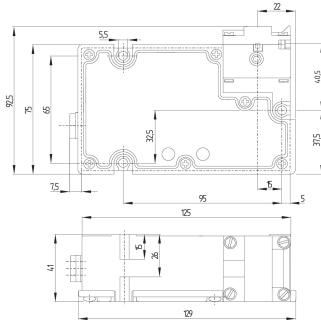

ID: ktzf-g01

| 160.4 kB | .jpg | 352.778 x 352.072 mm - 1000 x 998 px - 72

dpi

| 2.5 kB | .png | 74.083 x 74.083 mm - 210 x 210 px - 72 dpi

Diagram

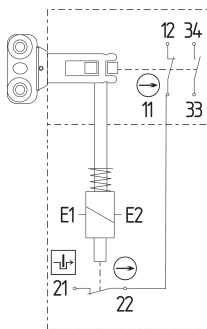

ID: ktzf-k05

| 195.5 kB | .ai | 210.002 x 297 mm - 595 x 841 px - 72 dpi

| 162.3 kB | .jpg | 352.778 x 553.861 mm - 1000 x 1570 px - 72

dpi

Schmersal, Inc., 15 Skyline Drive, Hawthorne, NY 10532

The details and data referred to have been carefully checked. Images may diverge from original. Further technical data can be found in the manual. Technical amendments and errors possible.

Generated on: 1/11/2022, 12:40 PM