



CONTACTOR RELAY 82E EN 50 011 8NO+2NC,  
SCREW TERMINALS AC OPERATION AC 230/220V 50HZ,  
276/264V 60HZ

General details:		
Size of contactor		0
Ambient temperature <ul style="list-style-type: none"><li>during operation</li></ul>	°C	-25 ... +55
Protection class IP / on the front		IP20
Reference code <ul style="list-style-type: none"><li>acc. to DIN 40719 extended according to IEC 204-2 / acc. to IEC 750</li><li>acc. to DIN EN 61346-2</li><li>acc. to DIN EN 81346-2</li></ul>		K K K
Control circuit:		
Type of voltage / of the control supply voltage		AC
Control supply voltage frequency <ul style="list-style-type: none"><li>1</li><li>2</li></ul>	Hz Hz	50 60
Control supply voltage <ul style="list-style-type: none"><li>with AC / at 50 Hz / Rated value</li><li>with AC / at 60 Hz / Rated value</li></ul>	V V	230 277
Auxiliary circuit:		

<b>Operating current / at AC-15</b>		
• at 230 V / Rated value	A	10
• at 400 V / Rated value	A	6
<b>Identification number and letter for switching elements</b>		82 E
<b>Number of NC contacts / for auxiliary contacts</b>		2
• lagging switching		0
• delayed switching		0
• make-before-break switching		0
<b>Number of NO contacts / for auxiliary contacts</b>		8
• leading contact		0
• delayed switching		0
• make-before-break switching		0
<b>Number of CO contacts / for auxiliary contacts</b>		0

#### Connection type:

**Design of the electrical connection / for auxiliary and control current circuit**

screw-type terminals

#### Mechanical design:

**Mounting type**

screw and snap-on mounting onto 35 mm standard mounting rail according to DIN EN 50022

**Width**

mm

55

**Height**

mm

78

**Depth**

mm

102

#### Certificates/approvals:

##### General Product Approval



CCC



CSA



UL

##### Test Certificates

[other](#)

[Special Test Certificate](#)

[Type Test Certificates/Test Report](#)

##### Shipping Approval



DNV



GL



LRS



RMRS

[other](#)

[Declaration of Conformity](#)

[other](#)

[Environmental Confirmations](#)

#### Safety:

<b>Protection against electrical shock</b>		finger-safe
<b>B10 value / with high demand rate</b> <ul style="list-style-type: none"> <li>• acc. to SN 31920</li> <li>• Note</li> </ul>		1,000,000 With 0.3 x I <sub>e</sub>
<b>T1 value / for proof test interval or service life / acc. to IEC 61508</b>	a	20

#### Further information:

##### Information- and Downloadcenter (Catalogs, Brochures,...)

<http://www.siemens.com/industrial-controls/catalogs>

##### Industry Mall (Online ordering system)

<http://www.siemens.com/industrial-controls/mall>

##### Cax online generator

<http://www.siemens.com/cax>

##### Service&Support (Manuals, Certificates, Characteristics, FAQs,...)

<http://support.automation.siemens.com/WW/view/en/3TH4382-0AP0/all>

##### Image database (product images, 2D dimension drawings, 3D models, device circuit diagrams, ...)

[http://www.automation.siemens.com/bilddb/cax\\_en.aspx?mlfb=3TH4382-0AP0](http://www.automation.siemens.com/bilddb/cax_en.aspx?mlfb=3TH4382-0AP0)

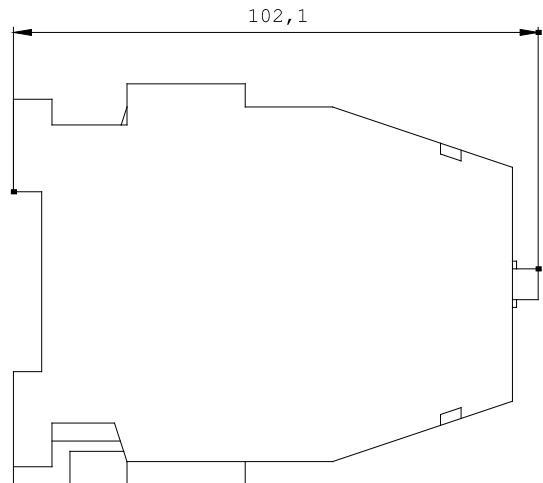
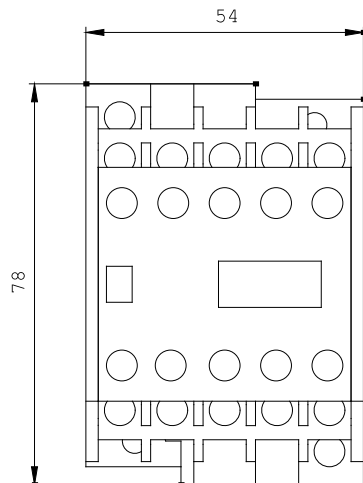

\W9.44.  
\W9.29

last change:

Jun 16, 2014