

Series NRX Type NF-frame ANSI/UL/IEC low voltage power circuit breaker renewal parts



Contents

| Description | Page | Description | Page |
|-----------------------------------------------------------------------------------|------|-----------------------------------------------------------------------------------------------|------|
| Type NF-frame field-installable kits and renewal parts lists | | Communication modules | 5 |
| Secondary contact wiring kits | 2 | Primary terminal adapter field option kits for fixed breakers and drawout cassettes | 6 |
| Cassette shutter field option kits | 2 | Bus conductor extensions for fixed, front connected breakers | 6 |
| Cassette cell switch field option kits | 2 | MCCB or Series NRX Type NF-frame code terminals for fixed, front connected breakers | 6 |
| Shunt trip field option kits | 2 | Miscellaneous accessories for breaker and cassette | |
| Motor operator field option kits (for charging closing spring) | 2 | Secondary block combinations | 7 |
| Spring release device field option kits | 3 | Adapter and barrier kits | 7 |
| Latch check switch (LCS) field option kits | 3 | Door, levering in, and cassette parts and kits | 7 |
| Auxiliary switch field option kits | 3 | Mechanical interlock parts and kits | 7 |
| Undervoltage release field option kits | 3 | Trip unit replacement kits and parts | 8 |
| Trip indicator and bell alarm/overcurrent trip switch field option kits | 3 | Secondary terminal replacement parts, blocks, and kits | 9 |
| Operations counter field option kits | 4 | Wire harnesses for trip units and communication modules | 9 |
| Padlockable pushbutton cover field option kits | 4 | Breaker replacement parts—miscellaneous | 9 |
| Padlock clarification | 4 | Miscellaneous accessories | 9 |
| Breaker key lock provision field option kits | 4 | | |
| Replacement rating plugs | 5 | | |
| Neutral current sensor kits | 5 | | |



Powering Business Worldwide

Series NRX Type NF-frame field-installable kits and renewal parts list

Table 1. Secondary contact wiring kits

Field-installation kits for use in wiring fixed breaker or drawout breaker cassette secondary contacts or adding option kits in field.

| Description | Kit contents | Catalog number |
|--------------------------------------|--------------|----------------|
| Drawout secondary terminal block kit | 8 blocks | DSBK08 |
| Drawout secondary terminal block kit | 20 blocks | DSBK20 |
| Drawout secondary terminal block kit | 30 blocks | DSBK30 |
| Fixed secondary terminal block kit | 8 blocks | FSBK08 |
| Fixed secondary terminal block kit | 20 blocks | FSBK20 |
| Fixed secondary terminal block kit | 30 blocks | FSBK30 |

Note: Please see **Table 22** on **page 7** for secondary block combinations.

Table 2. Cassette shutter field option kits

Field-installable option kit for drawout cassette for installation by customer.



| Breaker frame | Cassette type(s) | Number of poles | Continuous current rating amperes | Shutter kit catalog number |
|---------------|------------------|-----------------|-----------------------------------|----------------------------|
| All frames | All types | Three-pole | 800–1600 | SHTR3P |
| All frames | All types | Four-pole | 800–1600 | SHTR4P |

Table 3. Cassette cell switch field option kits

Field-installable option kit for drawout cassette for installation by customer.



| Description | Catalog number |
|----------------------------------------------------------------------------|----------------|
| Three switches; 1 Form C contact per disconnect, test and connect position | NRXCSKT |

Table 4. Shunt trip field option kits

Field-installable option kit for fixed or drawout breakers.



| Voltage (AC: 50/60 Hz) | Catalog number |
|------------------------|----------------|
| 110–127 Vac/Vdc | STA |
| 208–250 Vac/Vdc | STR |
| 24 Vdc | STL |
| 48 Vdc | STH |
| 60 Vdc | STS |

Note: See **Table 1** to order secondary contact blocks necessary.

Table 5. Motor operator field option kits (for charging closing spring)

Field-installable option kit for fixed or drawout breakers.



| Voltage (AC: 50/60 Hz) | Catalog number |
|------------------------|----------------|
| 110–127 Vac/Vdc | MOTBW |
| 208–250 Vac/Vdc | MOTPT |
| 24 Vdc | MOTL |
| 48 Vdc | MOTH |
| 60 Vdc | MOTX |

Note: See **Table 1** to order secondary contact blocks.

Table 6. Spring release device field option kits

Field-installable option kit for fixed or drawout breakers. Includes SRD assembly with plug-in wires and instructions.



| Voltage (AC: 50/60 Hz) | Catalog number |
|------------------------|----------------|
| 110–127 Vac/Vdc | SRA |
| 208–250 Vac/Vdc | SRR |
| 24 Vdc | SRM |
| 48 Vdc | SRH |
| 60 Vdc | SRS |

Note: See **Table 1** to order secondary contact blocks necessary.

Table 7. Latch check switch (LCS) field option kits

Field-installable option kit for fixed or drawout breakers.



| Description | Catalog number |
|----------------------------------------------------------------|----------------|
| Latch check switch for wiring internally to spring release | LCS1 |
| Latch check switch with 1 Form C contact for remote indication | LCS2 |

Table 8. Auxiliary switch field option kits

Field-installable option kit for fixed or drawout breakers.

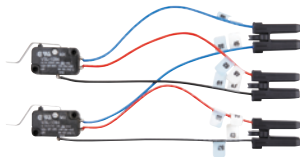

| Switch type (Form C) | Catalog number |
|---------------------------|------------------|
| Two contacts, short leads | NRXAUXKT1 |
| Two contacts, long leads | NRXAUXKT2 |

Note: Each auxiliary switch requires two secondary blocks. See **Table 1** to order secondary contact blocks.

Table 9. Undervoltage release field option kits

Field-installable option kit for fixed or drawout breakers.



| Voltage (AC: 50/60 Hz) | UVR release type | Catalog number |
|-------------------------|------------------|----------------|
| 110–127 Vac/110–125 Vdc | Continuous | UVRA |
| 208–240 Vac/220–250 Vdc | Continuous | UVRB |
| 24 Vdc | Continuous | UURL |
| 48 Vdc | Continuous | UVRH |
| 60 Vdc | Continuous | UVRS |

Note: See **Table 1** on **page 2** to order secondary contact blocks.

Table 10. Trip indicator and bell alarm/overcurrent trip switch field option kits

Field-installable option kits for fixed or drawout breakers. For breakers with trip units only, not available on non-automatic breakers.



| Trip indication kit description ① | Contacts | Catalog number |
|-----------------------------------------------------|----------|----------------|
| Mechanical pop-out trip indicator option kit | None | MTKIT |
| Interlocked mechanical pop-out trip indicator kit ③ | None | IMTKIT |
| Bell alarm/OTS kit with mechanical trip indicator | 2 Form C | BAOTSMT |
| Bell alarm/OTS contact field option kit ② | 2 Form C | BAOTS |

① Manual reset only.

② For use with breakers that have mechanical pop-out trip indicator option already installed.

③ Interlock trip indicator requires the trip indicator to be reset before charging and operating the breaker.

Note: See **Table 1** on **page 2** to order secondary contact blocks.

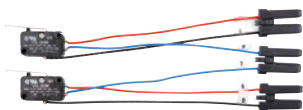

Table 11. Operations counter field option kits

Field-installable option kit for fixed and drawout breakers.



| Description | Catalog number |
|--------------------|----------------|
| Mechanical counter | NPCOUNTERKIT |

Table 12. Padlockable pushbutton cover field option kits

Field-installable option kit for fixed and drawout breakers.



| Padlockable cover type ① | Catalog number |
|------------------------------|----------------|
| Plastic base / plastic doors | NPLPBCP |
| Metal base / metal doors | NPLPBCM |
| Plastic base / metal doors | NPLPBCF |
| Metal base / plastic doors | NPLPBCH |
| Metal base / plastic doors | NPLPBMOFF |

① The cover can be configured to block the Open and Close pushbuttons or just the Close pushbutton.

Table 13. Padlock clarification

| Position 18 | Frame | Cover | Close button cover type | Open button cover type | Safe off feature | Emergency access feature | Field installable kit |
|-------------|---------|---------|-------------------------|------------------------|------------------|--------------------------|-----------------------|
| A and N | None | None | None | None | None | None | None |
| B and J | Plastic | Plastic | Hinged | Hinged | No | No | No |
| K and L | Metal | Metal | Hinged | Hinged | No | No | No |
| 1 and 2 | Metal | Metal | Hinged | Hinged | Yes ① | No | No |
| Kits | Plastic | Plastic | Hinged | Hinged | No | No | Yes |
| | Plastic | Metal | Hinged | Hinged | No | No | Yes |
| | Metal | Metal | Hinged | Hinged | No | No | Yes |
| | Metal | Plastic | Hinged | Hinged | No | No | Yes |
| | Metal | Metal | Hinged | Hinged | Yes ① | No | Yes |

① When padlocked, the cover depresses the Open pushbutton, preventing manual or electric breaker closing.

Table 14. Breaker key lock provision field option kits

Field-installable option kit for fixed and drawout breakers.



Castell



HF Securite (Ronis)



Kirk



CES

| Lock type | Use with customer supplied lock and key number | Catalog number |
|---------------------|------------------------------------------------|----------------|
| Castell | — | NCASTELLKIT |
| HF Securite (Ronis) | PBA90GEL3000 | NRONISKIT |
| Kirk | KC40.10 | NKIRKKIT |
| CES | — | NCESKIT |

Note: Lock not provided by Eaton.

Table 15. Replacement rating plugs

Field-installation rating plug on fixed or drawout breakers.



| Ampere rating | Frame size in (maximum) | | |
|--------------------------|-------------------------|-----------------------|-----------------------|
| | 630–800 A ① | 1000–1250 A ① | 1600 A ① |
| | Group A rating plugs | Group B rating plugs | Group C rating plugs |
| In of rating plug | Catalog number | Catalog number | Catalog number |
| 200 | NA200T | — | — |
| 250 | NA250T | — | — |
| 300 | NA300T | — | — |
| 400 | NA400T | NB400T | — |
| 500 | NA500T | NB500T | — |
| 600 | NA600T | NB600T | — |
| 630 | NA630T ① | NB630T ① | — |
| 800 | NA800T | NB800T | NC800T |
| 1000 | — | NB1000T | NC1000T |
| 1200 | — | NB1200T | NC1200T |
| 1250 | — | NB1250T ① | NC1250T ① |
| 1600 | — | — | NC1600T ① |

① IEC only (not UL listed).

Note: Rating plug must be selected based on breaker frame rating.

Table 16. Neutral current sensor kits

Field-installable external accessory for fixed or drawout breakers. Fourth current sensor for mounting on enclosure neutral in three-pole breaker ground-fault applications on three-phase, four-wire systems.



| Sensor rating | Sensor qty. required per three-pole breaker | Style number |
|---------------|---------------------------------------------|--------------|
| All ratings | 1 | NFNCTKIT |

Table 17. Communication modules



| Communications type | Catalog number |
|---------------------|----------------|
| Eaton INCOM™ | ICAM |
| Modbus® | MCAM |
| PROFIBUS® | PCAM |
| Ethernet | ECAM |

Table 18. Primary terminal adapter field option kits for fixed breakers and drawout cassettes

Field installation kit for changing fixed breakers to desired bus configurations; all ratings and frames.

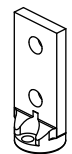
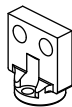

| Terminal description | Breaker terminals | Connection type | Number of poles | Continuous current rating amperes | Catalog number |
|-------------------------------|---------------------------|-----------------|-----------------|-----------------------------------|----------------|
| Short horizontal/vertical kit | Upper and lower terminals | Rear mount | Three-pole | 630–1600 | SADP316 |
| Short horizontal/vertical kit | Upper and lower terminals | Rear mount | Four-pole | 630–1600 | SADP413 |
| Long horizontal/vertical kit | Upper and lower terminals | Rear mount | Three-pole | 630–1600 | LADP316 |
| Long horizontal/vertical kit | Upper and lower terminals | Rear mount | Four-pole | 630–1600 | LADP416 |

Table 19. Primary terminal adapter field option kits for fixed breakers and drawout cassettes

Field installation kit for changing fixed breakers to desired bus configurations; all ratings and frames.

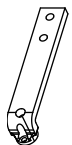
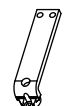

| Terminal description | Number of poles | Continuous current rating amperes | Catalog number |
|--------------------------------------------|-----------------|-----------------------------------|------------------|
| Rear connect adapter kit, long, 6 per box | Three-pole | 630–1600 | LBADPU316 |
| Rear connect adapter kit, long, 8 per box | Four-pole | 630–1600 | LBADPU416 |
| Rear connect adapter kit, short, 6 per box | Three-pole | 630–1600 | SBADPI316 |

Table 20. Bus conductor extensions for fixed, front connected breakers



| Terminal description | Number of poles | Interruption rating | Catalog number |
|-------------------------------------------|-----------------|---------------------|---------------------|
| Bus conductor extension for front connect | Three-pole | 42 kA and below | NRXBUSEXT |
| Bus conductor extension for front connect | Three-pole | 50 kA and below | NRXBUSEXT503 |
| Bus conductor extension for front connect | Four-pole | 50 kA and below | NRXBUSEXT504 |
| Bus conductor extension for front connect | Three-pole | 65 kA and below | NRXBUSEXT653 |
| Bus conductor extension for front connect | Four-pole | 65 kA and below | NRXBUSEXT654 |

Table 21. MCCB or Series NRX Type NF-frame code terminals for fixed, front connected breakers

| Terminal description | Wire size (number of conduct) | Catalog number |
|------------------------|-------------------------------|----------------------|
| Cable connect adapters | 500 kcmil #1–500 (2) | TA700NB1M ①② |
| Cable connect adapters | 400 kcmil 3/0–400 (3) | TA1000NB1M ①② |
| Cable connect adapters | 500 kcmil 4/0–500 (4) | TA1200NB1M ①② |
| Cable connect adapters | 750 kcmil 3/0–750 (3) | TA1201NB1M |

① Only metric MCCB terminals can be used on the Series NRX front connect at this time.

② Order two per pole.

Miscellaneous accessories for breaker and cassette

Table 22. Secondary block combinations

| Accessory | Required secondary blocks |
|-------------------------------------|---------------------------|
| Shunt trip | 1 |
| Motor operator | 2 |
| Spring release | 1 |
| Latch check switch (wired external) | 2 |
| Undervoltage release | 1 |
| Second shunt trip | 1 |
| Two auxiliary switches | 3 |
| Four auxiliary switches | 6 |
| Bell alarm/OTS | 3 |
| Communication module | 2 |
| 520 style trip unit | 2 ① |

① Included in all breakers.

Table 23. Adapter and barrier kits



| Description | Number of poles | Catalog number |
|-----------------------------|-----------------|----------------|
| Cassette phase barriers | 3 | 3DBAR |
| Cassette phase barriers | 4 | 4DBAR |
| Rear connect phase barriers | 3 | 3RBAR |
| Rear connect phase barriers | 4 | 4RBAR |

Table 24. Door, levering in, and cassette parts and kits

| Description | Catalog number |
|----------------------------------------|----------------|
| Cassette rejection kid | CREJBRKIT |
| Drawout door escutcheon and gasket kit | DEGK |
| Fixed door escutcheon and gasket kit | FEGK |
| Levering in device tool | LVIN |
| Three-pole levering in device | NRXLEVIN3 |
| Four-pole levering in device | NRXLEVIN4 |
| Cassette extension rails | NRXRAILS |

Table 25. Mechanical interlock parts and kits

| Description | Catalog number |
|---------------------------------------------------|----------------|
| Mechanical interlock kit, 2-way, drawout | NFM12D |
| Mechanical interlock kit, 3-way, type 31, drawout | NFM131D |
| Mechanical interlock kit, 3-way, type 32, drawout | NFM132D |
| Mechanical interlock kit, 3-way, type 33, drawout | NFM133D |
| Mechanical interlock kit, 2-way, fixed | NFM12F |
| Mechanical interlock kit, 3-way, type 31, fixed | NFM131F |
| Mechanical interlock kit, 3-way, type 32, fixed | NFM132F |
| Mechanical interlock kit, 3-way, type 33, fixed | NFM133F |
| Mechanical interlock cable 5 feet | NRXMIC5 |
| Mechanical interlock cable 6 feet | NRXMIC6 |
| Mechanical interlock cable 8 feet | NRXMIC8 |
| Mechanical interlock cable 10 feet | NRXMIC10 |

Table 26. Trip unit replacement kits and parts



| Description | Style number |
|-----------------------------------------------------------|--------------|
| Series NRX Digitrip 520 replacement cover (with hardware) | 5722B23G01 |
| Series NRX 1150 catalog number N11RLSIG trip unit kit | 66B3150G01 |
| Series NRX 1150 catalog number N11RLSI trip unit kit | 66B3150G02 |
| Series NRX 1150 RLSIA trip unit kit | 66B3150G03 |
| Series NRX 1150 IEC trip unit kit | 66B3150G04 |
| Series NRX 1150 catalog number N11IECEF trip unit kit | 66B3150G05 |
| Series NRX 1150 catalog number N11RIEC trip unit kit | 66B3150G06 |
| Series NRX 1150 catalog number RIECEF trip unit kit | 66B3150G07 |
| Series NRX 1150 catalog number N11LSIG trip unit kit | 66B3150G08 |
| Series NRX 1150 catalog number N11LSI trip unit kit | 66B3150G09 |
| Series NRX 1150 catalog number N11LSIA trip unit kit | 66B3150G10 |
| Series NRX 520 catalog number 5NLSIG | 70C1591G02 |
| Series NRX 520 catalog number N5LSI | 70C1591G04 |
| Series NRX 520 catalog number N5LSIG | 70C1591G05 |
| Series NRX 520 catalog number N5LI | 70C1591G06 |
| Series NRX 520 catalog number N5MLSI | 70C1591G11 |
| Series NRX 520 catalog number N5MLSIG | 70C1591G12 |
| Series NRX 520 catalog number N5MLSIA | 70C1591G13 |
| Series NRX 520 catalog number N5MLSI | 70C1591G14 |
| Series NRX 520 catalog number N5MLSIG | 70C1591G15 |
| Series NRX 520 catalog number N5MLSIA | 70C1591G16 |
| Series NRX 520 catalog number N5MRLSI | 70C1591G51 |
| Series NRX 520 catalog number N5MRLSIG | 70C1591G52 |
| Series NRX 520 catalog number N5MRLSIA | 70C1591G53 |
| Series NRX 520 catalog number N5MRLSI | 70C1591G54 |
| Series NRX 520 catalog number N5MRLSIG | 70C1591G55 |
| Series NRX 520 catalog number N5MRLSIA | 70C1591G56 |

① Contact 800-ETN-CARE for pricing and availability.

Catalog number references

| Symbol | Function/protection |
|----------|------------------------------------------------------------------|
| M | Metering function |
| R | Arcflash Reduction Maintenance System™ Maintenance Mode function |
| L | Long time trip (overload) |
| S | Short time trip |
| I | Instantaneous trip |
| G | Ground (Earth) fault trip |
| A | Ground (Earth) Alarm only |

Table 27. Secondary terminal replacement parts, blocks, and kits



| Description | Style number |
|----------------------------------------|--------------|
| Cassette secondary terminal block comb | 65A2675G01 |
| Weidmuller drawout terminal block | 66B2508G01 |
| Weidmuller fixed terminal block | 66B2510G01 |
| Rear connect adapter—short | 66B2512H01 |

① Contact 800-ETN-CARE for pricing and availability.

Table 28. Wire harnesses for trip units and communication modules

| Description | Style number |
|------------------------------------|--------------|
| Cam module cable assembly | 5723B54G10 |
| Aux power / GF source wire harness | 66B2832G27 |
| Communications wire harness | 66B2832G29 |
| GF source enable wire harness | 66B2832G28 |
| N-frame wire harness—aux power/GFs | 66B3090G01 |
| N-frame wire harness—PT module | 66B2832G35 |
| NF-frame wire harness kit | 66B3150G11 |
| Relay alarm wire harness | 66B2832G25 |
| Zone interlock jumper wire harness | 66B2832G30 |
| Zone interlock wire harness | 66B2832G26 |

① Contact 800-ETN-CARE for pricing and availability.

Table 29. Breaker replacement parts—miscellaneous

| Description | Style number |
|------------------------------------------------|--------------|
| Series NRX N-frame replacement charging handle | 65A3059G01 |
| Terminal shield kit accessory for NRX NF | NRXNFSTI |
| Series NRX 1150 PT module | 6D32438G01 |

Table 30. Miscellaneous accessories

| Description | Kit contents/accessory function | Catalog number |
|--------------------------------------------------------|----------------------------------------------------------------------------------------|----------------|
| Breaker trip unit test devices and accessories | | |
| Trip unit test kit | 120 Vac portable test kit for Digitrip 520, 520M | MTK1000 |
| Hand-held test kit | 120 Vac, 240 Vac hand-held test kit for Digitrip 520, 520M, and 1150 series trip units | MTST230V |
| Breaker trip unit test devices and accessories | | |
| NF wire harness kit | Harness to upgrade from 520 to 1150 trip units | 66B3150G11 |
| Miscellaneous breaker and enclosure accessories | | |
| Fixed breaker mounting feet kit | Replacement mounting feed for fixed breakers | NRXMTGFEET |
| Surface mount hardware kit | Hardware to surface mount NF breaker to panel | NFSMHKIT |
| Replacement charging handle | To replace damaged or broken charging handle | 65A3059G01 |
| Accessory tray | To replace damaged or broken accessory tray | LTRAY |
| Ground fault/zero sequence sensor kit | External sensor to detect source ground/zero sequence faults | NFGFSKIT |
| Residual/neutral ground sensor kit | External sensor to detect residual ground faults | NFNCTKIT |

Eaton
1000 Eaton Boulevard
Cleveland, OH 44122
United States
Eaton.com

© 2016 Eaton
All Rights Reserved
Printed in USA
Publication No. TD013014EN / Z17712
January 2016



Eaton is a registered trademark.

All other trademarks are property
of their respective owners.