

# Miniature Circuit Breakers BR6



The IMO range of miniature circuit breakers have been designed for protection of electrical installations against overload and short circuits and are manufactured in accordance with IEC60898-1

## Key Features

- New front design; cover and handle in arc shape.
- Transparent cover to carry label
- 6kA short circuit capacity
- Applicable to terminal and Pin/Fork type busbar connection
- Finger protected connection terminals
- Handle padlock device



Tripping characteristics in accordance with B, C and D type curves

- Curve B: 3-5 I<sub>n</sub>
- Curve C: 5-10 I<sub>n</sub>
- Curve D: 10-20 I<sub>n</sub>



## Options & Ordering Codes

<b>BR6</b>		<b>B</b>		<b>10</b>		<b>16A</b>	
Series		Tripping Characteristic		Pole Configuration		Rated Current (Amps)	
6kA Rated MCB	BR6	B Curve	B	Single Pole (1P)	10	1A	
		C Curve	C	Single Pole + Neutral (1P+N)	1N	2A	
		D Curve	D	Two Pole (2P)	20	4A	
				Three Pole (3P)	30	6A	
				Three Pole + Neutral (3P+N)	3N	10A	
				Four Pole (4P)	40	16A	
						20A	
						25A	
						32A	
						40A	
						50A	
						63A	

Type	Number of Modules
10	1
1N	2
20	2
30	3
3N	4
40	4

## Specifications

In Accordance With	IEC 60898-1	
Certification	CE, SEMKO	
Pole Composition	1P, 1P+N, 2P, 3P, 3P+N, 4P	
Tripping Curve	B, C, D	
Calibration Temperature	+30°C	
Rated Frequency	50 / 60Hz	
Rated Operational Voltage	230VAC / 400VAC	
Rated Insulation Voltage	250VAC / 500VAC	
Rated Impulse Withstand Voltage	6.2kV	
Rated Short Circuit Breaking Capacity (as per IEC 60898-1)	6kA B & C Curves	4.5kA D Curve
Electrical Lifetime	≥ 4,000 cycles	
Fastening Torque	2.0Nm	
Terminal Capacity	35mm <sup>2</sup> solid, 25mm <sup>2</sup> stranded conductor	
Mounting on Rail	EN 60715 (EN 50022)	
Protection Degree	IP20	
Operating Temperature	-5°C to +40°C	
Rated Current	1A to 63A	
Energy Limiting Class	3	
Terminal Height	21mm	
Busbar Connection	Pin type (top/bottom), Fork (bottom only)	

# Miniature Circuit Breakers BR6



## Dimensions (mm)

Technical Datasheet

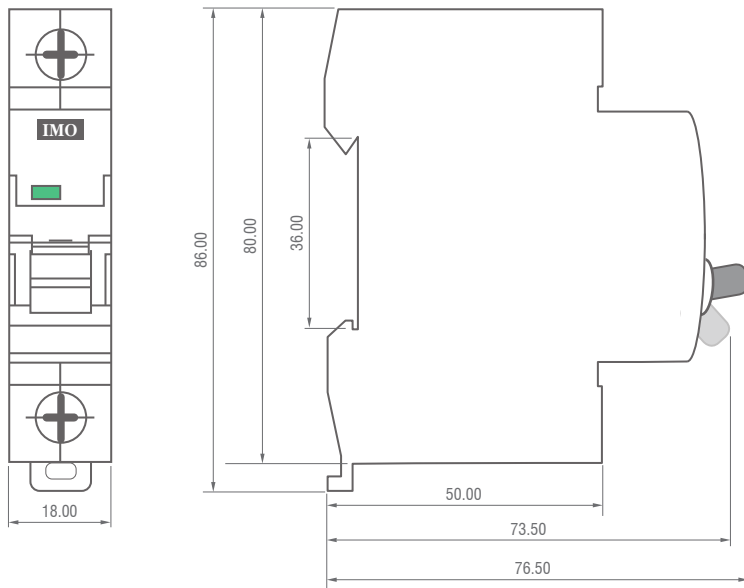

## B, C & D Tripping Curves

## Ambient Temperature & Current Rating Curve

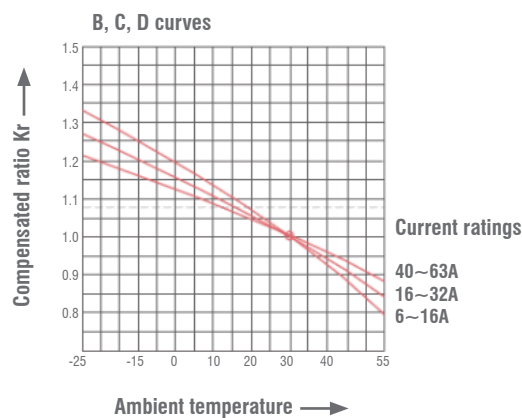
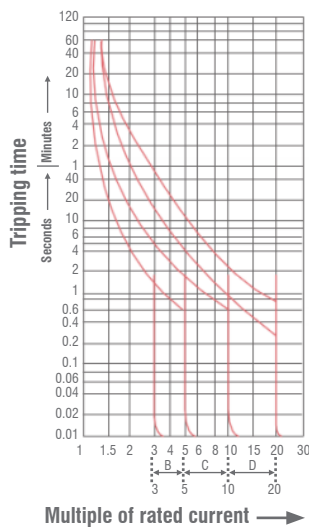

## Accessories

Under / Over Voltage Trip	BR6-U2-02
Trips the attached unit in case of under / over voltage	
Rated Voltage $U_e$ : AC 230V	
Under-Voltage Tripping Range: 280V $\pm 5\%$	
Over-Voltage Tripping Range: 170V $\pm 5\%$	
Mounting on Left Side	

Shunt Trip	BR6-S2
for switching off the protection device remotely	
Rated Voltage $U_e$ : AC 110V / 230V / 400V	
Voltage: 70% - 110% $\times U_e$	
Mounting on Left Side	

Auxiliary Switch	BR6-F2
for monitoring the status of the protection device (open/closed)	
1 pole changeover	
Rated Current: 6A @ 230VAC & 24VDC or 3A @ 400VAC	
Dielectric Strength: 2000V / 1min	
Terminal Capacity: 2.5mm <sup>2</sup>	
Mounting on Left Side	

Description	Part Number
Busbar 1 Pole, 100A, Pin Type, 1M	B10BB1P100-1M
Busbar 3 Pole, 100A, Pin Type, 1M	B10BB3P100-1M
Busbar 1 Pole, 100A, Fork Type, 1M	B10BB1F100-1M
Busbar 3 Pole, 100A, Fork Type, 1M	B10BB3F100-1M
End Cap 1 Pole	B10BBCAP1
End Cap 3 Pole	B10BBCAP3
Terminal Adaptor	BA1
Locking Device (4mm padlock diameter max. - not included)	B10-LOCK