



2NO+2NC CONTACTOR, AC3: 11KW AC 110V 50HZ 4-POLE,
2NO+2NC, SZ: S0, SCREW TERMINAL 1NO+1NC INTEGR.

product brand name	SIRIUS
Product designation	3RT2 contactor
General technical data:	
Product expansion function module for communication	No
Insulation voltage	
• Rated value	690 V
maximum permissible voltage for safe isolation between coil and main contacts acc. to EN 60947-1	400 V
Degree of pollution	3
Shock resistance	
• at rectangular impulse	
— with AC	8,3g / 5 ms, 5,3g / 10 ms
• with sine pulse	
— with AC	13,5g / 5 ms, 8,3g / 10 ms
Surge voltage resistance Rated value	6 kV
Mechanical service life (switching cycles)	
• of the contactor typical	10 000 000
• of the contactor with added electronics-compatible auxiliary switch block typical	5 000 000
• of the contactor with added auxiliary switch block typical	10 000 000
Protection class IP	
• on the front	IP20
Equipment marking	

- acc. to DIN EN 61346-2
- acc. to DIN EN 81346-2

Q
Q

Main circuit:

Number of poles for main current circuit	4
Number of NC contacts for main contacts	2
Number of NO contacts for main contacts	2
Operating current	
<ul style="list-style-type: none"> • at AC-1 <ul style="list-style-type: none"> — up to 690 V at ambient temperature 40 °C Rated value — up to 690 V at ambient temperature 60 °C Rated value • at AC-2 at AC-3 at 400 V <ul style="list-style-type: none"> — per NO contact Rated value — per NC contact Rated value 	40 A 35 A 25 A 25 A
Operating current with 1 current path	
<ul style="list-style-type: none"> • at DC-1 <ul style="list-style-type: none"> — at 24 V Rated value — at 110 V Rated value — at 220 V Rated value — at 440 V Rated value • at DC-3 at DC-5 <ul style="list-style-type: none"> — at 24 V per NC contact Rated value — at 24 V per NO contact Rated value — at 110 V per NC contact Rated value — at 110 V per NO contact Rated value — at 220 V per NC contact Rated value — at 220 V per NO contact Rated value — at 440 V per NC contact Rated value — at 440 V per NO contact Rated value 	35 A 4.5 A 1 A 0.4 A 20 A 20 A 1.25 A 2.5 A 0.5 A 1 A 0.045 A 0.09 A
Operating current with 2 current paths in series	
<ul style="list-style-type: none"> • at DC-1 <ul style="list-style-type: none"> — at 24 V Rated value — at 110 V Rated value — at 220 V Rated value — at 440 V Rated value • at DC-3 at DC-5 <ul style="list-style-type: none"> — at 110 V per NC contact Rated value — at 110 V per NO contact Rated value — at 220 V per NC contact Rated value — at 220 V per NO contact Rated value 	35 A 35 A 5 A 1 A 7.5 A 15 A 1.5 A 3 A

— at 24 V per NC contact Rated value	35 A
— at 24 V per NO contact Rated value	35 A
— at 440 V per NC contact Rated value	0.135 A
— at 440 V per NO contact Rated value	0.27 A
Operating power	
• at AC-2 at AC-3	
— at 230 V per NC contact Rated value	5.5 kW
— at 230 V per NO contact Rated value	5.5 kW
— at 400 V per NC contact Rated value	11 kW
— at 400 V per NO contact Rated value	11 kW
Active power loss at AC-3 at 400 V for rated value of the operating current per conductor	1.6 W
Operating frequency	
• at AC-1 maximum	1 000 1/h
No-load switching frequency	
• with AC	5 000 1/h
• for DC	1 500 1/h
Control circuit/ Control:	
Type of voltage of the control supply voltage	AC
Control supply voltage with AC	
• at 50 Hz Rated value	110 V
Operating range factor control supply voltage rated value of the magnet coil with AC	
• at 50 Hz	0.8 ... 1.1
• at 60 Hz	0.85 ... 1.1
Closing delay	
• with AC	8 ... 40 ms
Opening delay	
• with AC	4 ... 16 ms
Arcing time	10 ... 10 ms
Residual current of the electronics for control with signal <0>	
• with AC at 230 V maximum permissible	0.007 A
Auxiliary circuit:	
Number of NC contacts	
• for auxiliary contacts	
— instantaneous contact	1
Number of NO contacts	
• for auxiliary contacts	
— instantaneous contact	1
Product expansion Auxiliary switch	Yes
Operating current at AC-12 maximum	10 A

Operating current at AC-15	
• at 230 V Rated value	10 A
• at 400 V Rated value	3 A
• at 690 V Rated value	1 A
Operating current at DC-12	
• at 60 V Rated value	6 A
• at 110 V Rated value	3 A
• at 125 V Rated value	2 A
• at 220 V Rated value	1 A
• at 600 V Rated value	0.15 A
Operating current at DC-13	
• at 24 V Rated value	10 A
• at 60 V Rated value	2 A
• at 110 V Rated value	1 A
• at 125 V Rated value	0.9 A
• at 220 V Rated value	0.3 A
• at 600 V Rated value	0.1 A
Contact reliability of the auxiliary contacts	1 faulty switching per 100 million (17 V, 1 mA)

UL/CSA ratings:

yielded mechanical performance [hp]	
• for single-phase AC motor	
— at 110/120 V Rated value	2 hp
— at 230 V Rated value	3 hp
Contact rating of the auxiliary contacts acc. to UL	A600 / Q600

Short-circuit:

Design of the fuse link	
• for short-circuit protection of the main circuit	
— with type of assignment 1 required	gL/gG LV HRC 3NA, DIAZED 5SB, NEOZED 5SE: 63 A
— with type of assignment 2 required	gL/gG LV HRC 3NA, DIAZED 5SB, NEOZED 5SE: 35 A
• for short-circuit protection of the auxiliary switch required	fuse gL/gG: 10 A

Installation/ mounting/ dimensions:

mounting position	+/-180° rotation possible on vertical mounting surface; can be tilted forward and backward by +/- 22.5° on vertical mounting surface
Mounting type	screw and snap-on mounting onto 35 mm standard mounting rail according to DIN EN 50022
• Side-by-side mounting	Yes
Height	85 mm
Width	61 mm
Depth	97 mm

Required spacing	
• with side-by-side mounting	
— forwards	0 mm
— Backwards	0 mm
— upwards	0 mm
— downwards	0 mm
— at the side	0 mm
• for grounded parts	
— forwards	0 mm
— Backwards	0 mm
— upwards	0 mm
— at the side	6 mm
— downwards	0 mm
• for live parts	
— forwards	0 mm
— Backwards	0 mm
— upwards	0 mm
— downwards	0 mm
— at the side	6 mm

Connections/ Terminals:

Type of electrical connection	
• for main current circuit	screw-type terminals
• for auxiliary and control current circuit	screw-type terminals
Type of connectable conductor cross-section	
• for main contacts	
— solid	2x (1 ... 2.5 mm ²), 2x (2.5 ... 10 mm ²)
— single or multi-stranded	2x (1 ... 2,5 mm ²), 2x (2,5 ... 10 mm ²)
— finely stranded with core end processing	2x (1 ... 2.5 mm ²), 2x (2.5 ... 6 mm ²), 1x 10 mm ²
• for AWG conductors for main contacts	2x (16 ... 12), 2x (14 ... 8)
• for auxiliary contacts	
— solid	2x (0.5 ... 1.5 mm ²), 2x (0.75 ... 2.5 mm ²)
— single or multi-stranded	2x (0,5 ... 1,5 mm ²), 2x (0,75 ... 2,5 mm ²)
— finely stranded with core end processing	2x (0.5 ... 1.5 mm ²), 2x (0.75 ... 2.5 mm ²)
• for AWG conductors for auxiliary contacts	2x (20 ... 16), 2x (18 ... 14)

Safety related data:

B10 value with high demand rate acc. to SN 31920	1 000 000
Proportion of dangerous failures	
• with low demand rate acc. to SN 31920	40 %
• with high demand rate acc. to SN 31920	73 %
Product function	
• Mirror contact acc. to IEC 60947-4-1	Yes

- positively driven operation acc. to IEC 60947-5-1

No

T1 value for proof test interval or service life acc. to IEC 61508

20 y

Protection against electrical shock

finger-safe

Mechanical data:

Size of contactor

S0

Ambient conditions:

Installation altitude at height above sea level maximum

2 000 m

Ambient temperature

- during operation
- during storage

-25 ... +60 °C

-55 ... +80 °C

Certificates/ approvals:

General Product Approval

EMC

Functional Safety/Safety of Machinery



[Type Examination](#)

Declaration of Conformity

Test Certificates

Shipping Approval



[Type Test Certificates/Test Report](#)

[Special Test Certificate](#)



Shipping Approval

other



[Environmental Confirmations](#)

other

[Confirmation](#)



Further information

Information- and Downloadcenter (Catalogs, Brochures,...)

<http://www.siemens.com/industrial-controls/catalogs>

Industry Mall (Online ordering system)

<http://www.siemens.com/industrymall>

Cax online generator

<http://support.automation.siemens.com/WW/CAXorder/default.aspx?lang=en&mlfb=3RT25261AF00>

Service&Support (Manuals, Certificates, Characteristics, FAQs,...)

<https://support.industry.siemens.com/cs/ww/en/ps/3RT25261AF00>

Image database (product images, 2D dimension drawings, 3D models, device circuit diagrams, EPLAN macros, ...)

http://www.automation.siemens.com/bilddb/cax_de.aspx?mlfb=3RT25261AF00&lang=en

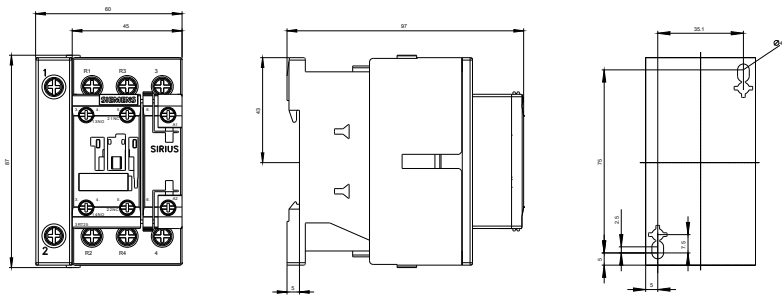

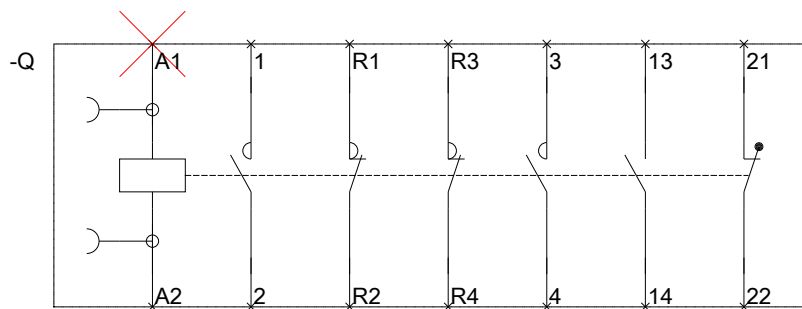
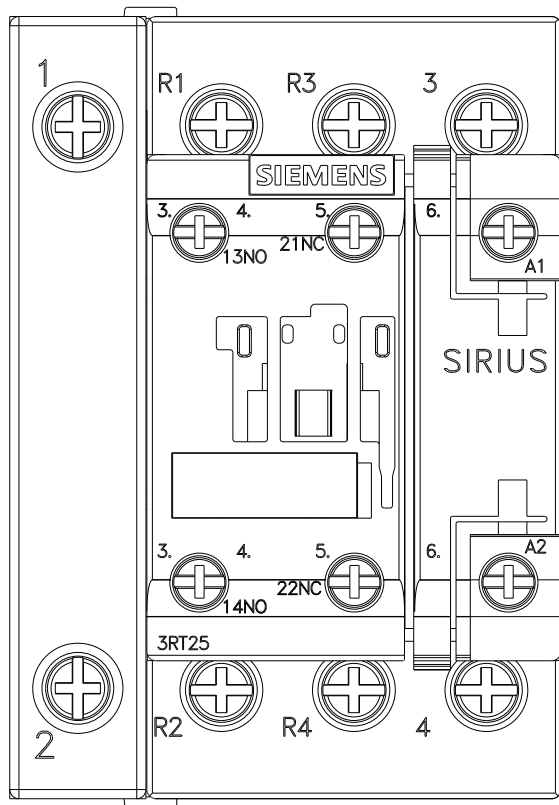

last modified:

14.05.2015