

Datasheet - IFL 4-250-01P

Inductive proximity switch / Housing construction form: Block / IFL 250



(Minor differences between the printed image and the original product may exist!)

- Design 250
- Thermoplastic enclosure
- DC 3-wire
- Double-insulated 

Ordering details

Product type description	IFL 4-250-01P
Article number	101097008
EAN code	4030661060224
eCl@ss	27-27-01-01

Approval

Approval



CCC

Global Properties

Product name	IFL - 250
Standards	IEC/EN 60947-5-2; DIN VDE 0660-208
Compliance with the Directives (Y/N) 	Yes
Operating resource protection class	Protection class 2
Materials	
- Material of the housings	Plastic
- Material of the cable mantle	PVC
Housing coating	None
Housing construction form	Block
Weight	86 g

Mechanical data

Design of electrical connection	Cable
Cable length	2 m
Conductor with strain relief	No
Conductors	3 x 0,34 mm ²
mechanical installation conditions	not flush
Switch distance	4 mm
Reduction factor 1 met (Y/N)	No
Protection circuit	inductive interference protection, Protection against polarity reversal, short-circuit and overload proof
Pressure resistant (Y/N)	No

Ambient conditions

Ambient temperature	
- Min. environmental temperature	-25 °C
- Max. environmental temperature	+70 °C
Protection class	IP67 to IEC/EN 60529

Electrical data

Design of control element	Opener (NC)
Number of wire	3 piece
Voltage type	DC, direct current
Supply voltage U _B	
- Min. supply voltage	10 V
- Max. supply voltage	40 V
Switch frequency	approx. 1000 Hz
Voltage drop U _d	approx. 1.2 V (200 mA)
Operating current I _e	200 mA
No-load current I ₀	approx. 3 mA (24 V)

Outputs

Design of control output	PNP
--------------------------	-----

LED switching conditions display

LED switching conditions display (Y/N)	Yes
- yellow LED	

ATEX

Explosion protection categories for gases	None
Explosion protected category for dusts	None

Dimensions

Dimensions of the sensor	
- Width of sensor	40 mm
- Height of sensor	25 mm
- Length of sensor	12 mm

notice

Switches can be mounted adjacent to each other without interference.
with 2 screws M3 x 6 for rear mounting
maximum screwing depth: 6 mm

Ordering code

IFL **(1)-(2)-(3)(4)(5)-(6)**

(1)

2 Switch distance 2 mm

4 Switch distance 4 mm

(2)

250 Block Design, 40 x 25 x 12 mm

(3)

01 Opener (NC)

10 Normally open contact (NO)

10/01 Normally open contact (NO) / Opener (NC) with Wiring compartment

11 Normally open contact (NO) / Opener (NC) antivalent

(4)

without Cable

D DC 2-wire

(5)

N n-type

P p-type

(6)

1716 cable entries from sides

Documents

Operating instructions (en) 128 kB, 31.08.2016

Code: mrl_ifl-allgemein_en

Operating instructions (pl) 137 kB, 21.10.2016

Code: mrl_ifl-allgemein_pl

Operating instructions (pt) 109 kB, 06.04.2017

Code: mrl_ifl-allgemein_pt

Operating instructions (it) 108 kB, 21.10.2016

Code: mrl_ifl-allgemein_it

Operating instructions (es) 110 kB, 21.10.2016

Code: mrl_ifl-allgemein_es

Operating instructions (cn) 177 kB, 05.05.2017

Code: mrl_ifl-allgemein_cn

Operating instructions (de) 131 kB, 31.08.2016

Code: mrl_ifl-allgemein_de

Operating instructions (fr) 110 kB, 21.10.2016

Code: mrl_ifl-allgemein_fr

Declaration of conformity (en, de) 232 kB, 05.11.2013

Code: __iflp01

CCC certification (en) 2 MB, 27.04.2017

Code: q_iflp01

CCC certification (cn) 2 MB, 27.04.2017

Code: q_iflp04

Images

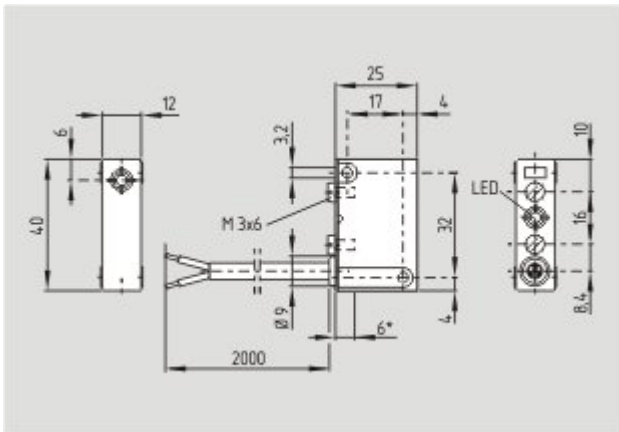

Dimensional drawing (basic component)

K.A. Schmersal GmbH & Co. KG, Möddinghofe 30, D-42279 Wuppertal

The data and values have been checked thoroughly. Technical modifications and errors excepted.

Generiert am 06.12.2017 - 16:12:42h Kasbase 3.3.0.F.64I