



ASISAFE BASIC SAFETY MONITOR 2 F-RO,
 2 ENABLING CIRCUITS, IP20,
 WITH SCREW-TYPE TERMINALS (REMOVABLE),
 SAFE OUTPUT RELAY RESPONSE TIME MAX. 40 MS,
 MONITOR TYPE 2, VERSION 3,
 APPLICABLE UP TO CATEGORY 4 (EN 954-1),
 UP TO PL E (EN ISO 13849-1),
 UP TO SIL 3 (IEC 61508),
 FOR AS-INTERFACE / AS-I SAFETY AT WORK

General technical data:

Design of the product		safety monitor
Protocol / will be supported / AS interface protocol		Yes
Type		2 enabling circuits
Number of release circuits		2
Response time / max.	ms	40
Design of the electrical connection / of the inputs and outputs		screw-type terminals
Rated operational current Ie		
<ul style="list-style-type: none"> • AC-12, 50/60 Hz / 250 V 	A	3
<ul style="list-style-type: none"> • AC-15, 50/60 Hz 		
<ul style="list-style-type: none"> • 115 V 	A	3
<ul style="list-style-type: none"> • 230 V 	A	3
<ul style="list-style-type: none"> • DC-12 (DC-1) / 24 V 	A	3
<ul style="list-style-type: none"> • DC-13 (DC-11) 		
<ul style="list-style-type: none"> • 24 V 	A	1
<ul style="list-style-type: none"> • 115 V 	A	0.1
<ul style="list-style-type: none"> • 230 V 	A	0.05
Item designation		
<ul style="list-style-type: none"> • according to DIN 40719 extendable after IEC 204-2 / according to IEC 750 		A
<ul style="list-style-type: none"> • according to DIN EN 61346-2 		F

Ambient conditions:

Ambient temperature

- during operating
- during storage

°C	60 ... -20
°C	70 ... -30

Protection class IP

IP20

Mechanical design:

Width

mm 45

Height

mm 108

Depth

mm 120

Type of mounting

screws / standard rail

Certificates/approvals:

General Product Approval

Functional Safety / Safety of Machinery

Declaration of Conformity



CSA



GOST



TÜV



UL



EG-Konf.

Shipping Approval



ABS



BUREAU
VERITAS



DNV



LRS



PRS



RINA

other

[Confirmation](#)

[Declaration of
Conformity](#)

Further information:

Information- and Downloadcenter (Catalogs, Brochures,...)

<http://www.siemens.com/industrial-controls/catalogs>

Industry Mall (Online ordering system)

<http://www.siemens.com/industrial-controls/mall>

CAx-Online-Generator

<http://www.siemens.com/cax>

Service&Support (Manuals, Certificates, Characteristics, FAQs,...)

<http://support.automation.siemens.com/WW/view/en/3RK1105-1BE04-0CA0/all>

Image database (product images, 2D dimension drawings, 3D models, device circuit diagrams, ...)

http://www.automation.siemens.com/bilddb/cax_en.aspx?mlfb=3RK1105-1BE04-0CA0

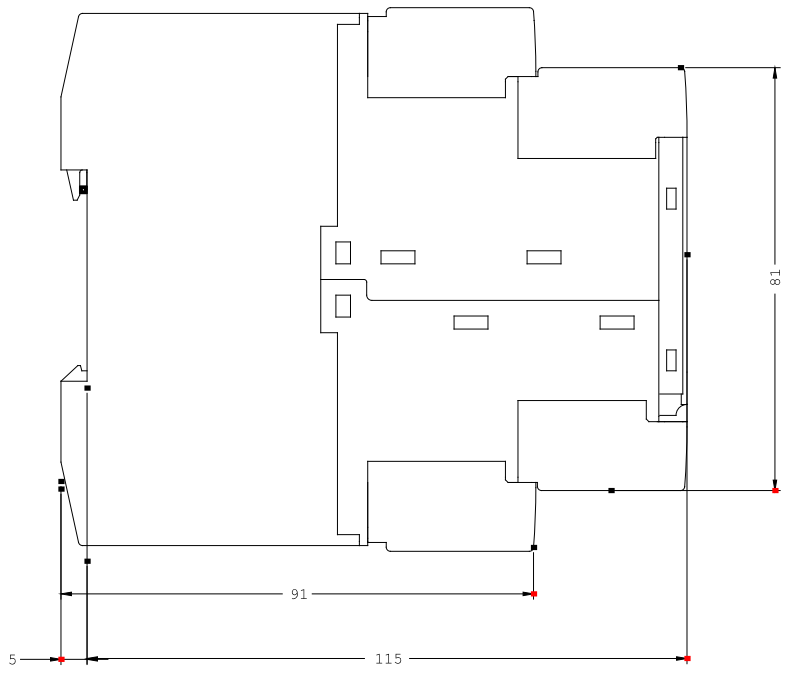
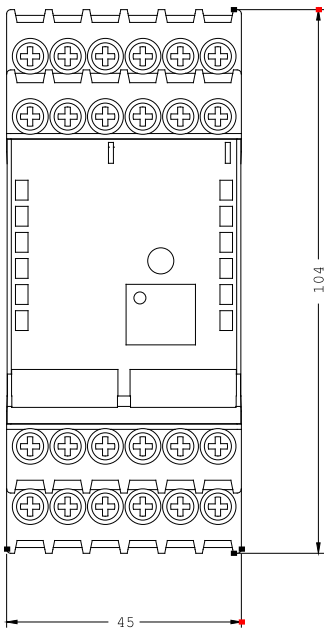

last change:

Mar 5, 2012