

DOL starter, 7.5 kW Prepared for relay mounting
 Contactor 3RT10, 230 V, 50 Hz Size S0, PE and N
 terminal Molded-plastic enclosure IP65 Version for
 Europe Button I-O (O=R), black/white

General technical data:

Design of the product		direct starter
Adjustable pick-up value current of the current-dependent overload release	A	1.8 ... 17
Maximum short-circuit current breaking capacity (Icu) at 400 V rated value	kA	50
Equipment marking acc. to DIN EN 61346-2		K
Equipment marking acc. to DIN 40719 extended according to IEC 204-2 acc. to IEC 750		A

Control circuit/ Control:

Type of voltage		AC
Control supply voltage		
<ul style="list-style-type: none"> • at AC — at 50 Hz rated value 	V	230 ... 230
Supply voltage frequency for auxiliary and control current circuit rated value	Hz	50 ... 50
Number of NC contacts for auxiliary contacts		0
Number of NO contacts for auxiliary contacts		1
Number of CO contacts for auxiliary contacts		0

Main circuit:

Operating voltage rated value	V	400
Operating current at AC at 400 V rated value	A	17
Operating power at AC-3 at 400 V rated value	kW	7.5
Product function Short circuit protection		No

Mechanical data:

Mounting type		screw fixing
Type of electrical connection for main current circuit		screw-type terminals
Product component Motor brake output		No
Product function Bus communication		No
Size of motor starter		S0
Width	mm	105
Height	mm	190
Depth	mm	117



Communication/ Protocol:

Protocol is supported		
• AS-interface protocol		No
• PROFIBUS DP protocol		No

Ambient conditions:

Ambient temperature during operation	°C	-20 ... +35
Protection class IP		IP65

Certificates/ approvals:

General Product Approval	Declaration of Conformity	Test Certificates	other
	 EG-Konf.	Type Test Certificates/Test Report	Confirmation

Further information

- Information- and Downloadcenter (Catalogs, Brochures,...)**
<http://www.siemens.com/industrial-controls/catalogs>
- Industry Mall (Online ordering system)**
<http://www.siemens.com/industrymall>
- Cax online generator**
<http://support.automation.siemens.com/WW/CAXorder/default.aspx?lang=en&mlfb=3RE1020-8XC25-0AP0>
- Service&Support (Manuals, Certificates, Characteristics, FAQs,...)**
<https://support.industry.siemens.com/cs/ww/en/ps/3RE1020-8XC25-0AP0>
- Image database (product images, 2D dimension drawings, 3D models, device circuit diagrams, EPLAN macros, ...)**
http://www.automation.siemens.com/bilddb/cax_de.aspx?mlfb=3RE1020-8XC25-0AP0&lang=en

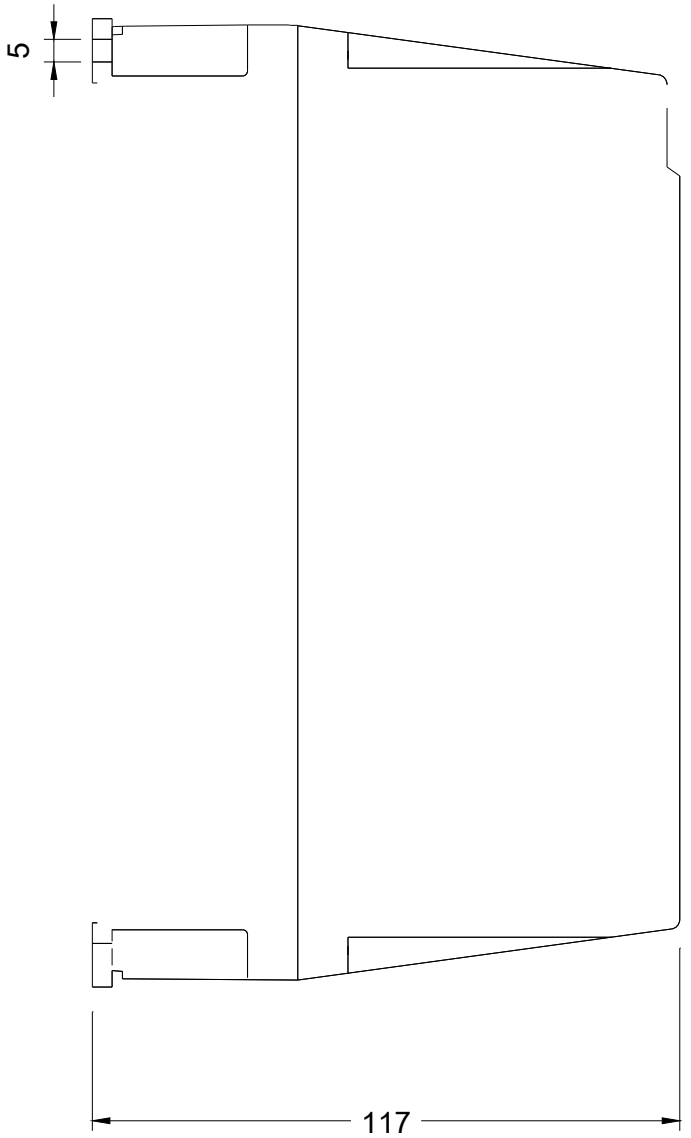
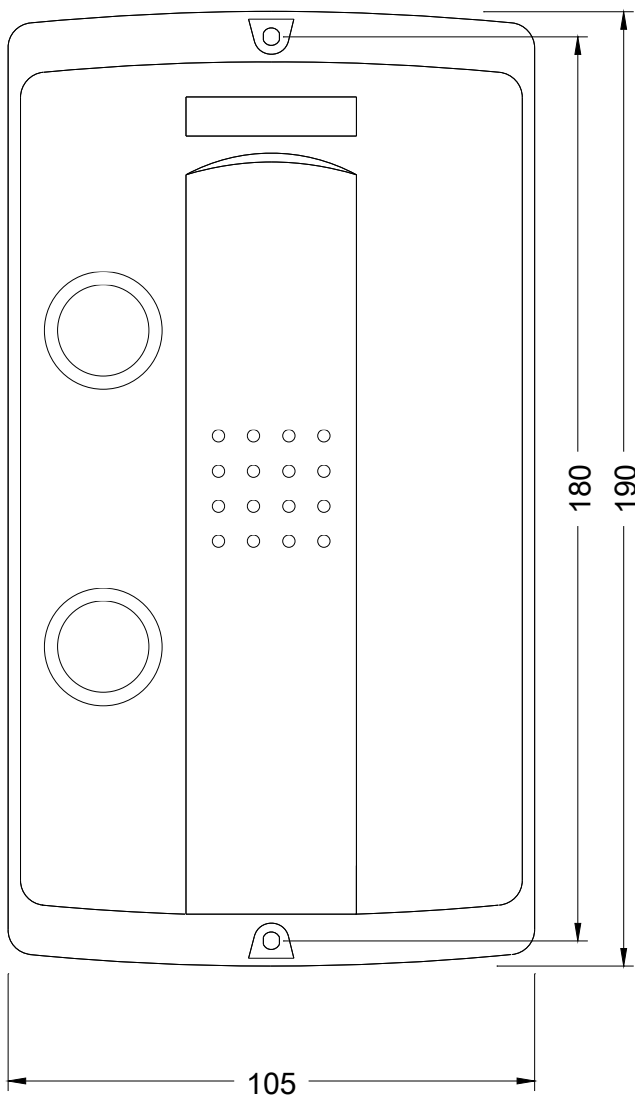

last modified:

08/03/2018