

Ω ISO - Low voltage insulators

Ω ISO

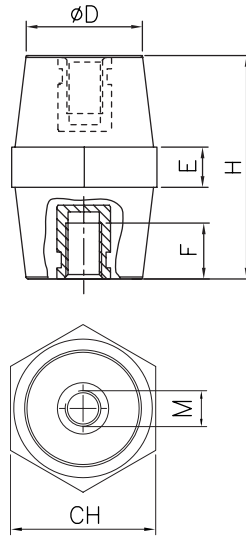

TECHNICAL FEATURES

Insulation:

Polyamide 66 reinforced with 30% fiberglass
Halogen Free
Self-extinguishing: V0-UL94
Glow wire test: 960° C
Color: Black

Threaded inserts:

Galvanized steel

Finished product:

Rated voltage: 1000 V AC/1500 V DC
Working temperature: - 40 + 130° C





file n° 300607

R.T. = Tensile strength

R.C. = Compressive strength

R.F. = Flexural strength

Code	Reference		Weight (Kg)	H (mm)	CH (mm)	Type	D (mm)	E (mm)	M	F (mm)	 (Nm)	R.T. (daN)	R.C. (daN)	R.F. (daN)
ISO2000	ISO 15M4 UL	50	0,005	15	14	○	12	3	M4	5	3	150	1500	100
ISO2005	ISO 20M4 UL	50	0,011	20	17	○	15	4	M4	5	3	200	2000	100
ISO2007	ISO 20M5 UL	50	0,011						M5	5	6	200	2000	150
ISO2010	ISO 20M6 UL	50	0,011						M6	5	8	250	2000	200
ISO2015	ISO 25M5 UL	50	0,013	25	20	○	15	5	M5	8	6	400	2500	200
ISO2020	ISO 25M6 UL	50	0,012						M6	8	10	400	2500	200
ISO2025	ISO 30M6 UL	50	0,038	30	30	○	26	6	M6	9	10	800	7500	500
ISO2030	ISO 30M8 UL	50	0,035						M8	9	25	800	7500	500
ISO2035	ISO 35M6 UL	50	0,049						35	32	○	28	7	M6
ISO2040	ISO 35M8 UL	50	0,050	M8	11	25	900	6500						570
ISO2045	ISO 35M10 UL	50	0,058	M10	11	50	900	6500						570
ISO2046	ISO 35M8W UL	25	0,109	40	40	○	35	10	M8	11	25	1100	11000	650
ISO2048	ISO 35M10W UL	25	0,108						M10	11	50	1100	11000	650
ISO2050	ISO 40M6 UL	25	0,056	40	32	○	28	8	M6	11	10	1300	7500	500
ISO2055	ISO 40M8 UL	25	0,065						M8	11	25	1300	7500	500
ISO2060	ISO 40M10 UL	25	0,063						M10	11	50	1300	7500	500
ISO2061	ISO 40M8W UL	25	0,108	46	46	○	40	12	M8	11	25	1500	12000	600
ISO2063	ISO 40M10W UL	25	0,108						M10	11	50	1500	12000	600
ISO2065	ISO 45M6 UL	25	0,108	45	41	○	33	10	M6	15	10	1600	9000	650
ISO2070	ISO 45M8 UL	25	0,097						M8	15	25	1600	9000	650
ISO2075	ISO 45M10 UL	25	0,097						M10	15	50	1800	9000	700
ISO2076	ISO 45M8W UL	25	0,132	50	50	○	41	10,5	M8	15	25	2000	14000	800
ISO2078	ISO 45M10W UL	25	0,132						M10	15	50	2000	14000	800
ISO2080	ISO 50M6 UL	25	0,094	50	36	○	29	11	M6	15	10	1500	10000	400
ISO2085	ISO 50M8 UL	25	0,096						M8	15	25	1600	10000	450
ISO2090	ISO 50M10 UL	25	0,093						M10	15	50	1800	10000	650
ISO2091	ISO 50M10W UL	25	0,145	50	50	○	40	12	M10	15	50	2000	13000	750
ISO2093	ISO 50M12W UL	25	0,145						M12	15	85	2000	13000	850
ISO2094	ISO 55M10 UL	10	0,185	55	55	○	45	12	M10	15	50	2200	15000	1000
ISO2095	ISO 60M8 UL	10	0,194	60	54	○	42	12	M8	15	25	2200	15000	900
ISO2100	ISO 60M10 UL	10	0,190						M10	15	50	2200	15000	900
ISO2105	ISO 75M12 UL	10	0,203	75	50	○	35	11,5	M12	25	85	2000	12000	750
ISO2110	ISO 75M16 UL	10	0,246						M16	25	200	2000	12000	750
ISO2115	ISO 100M12 UL	10	0,458	100	65	○	50	21	M12	25	85	3000	20000	1000
ISO2117	ISO 100M16 UL	10	0,430						M16	25	200	3000	20000	1000

TEKNOMEGA

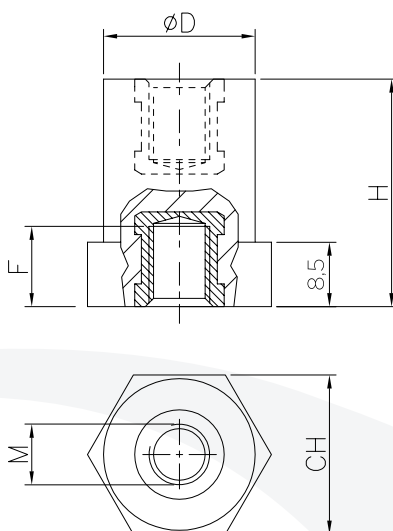

TECHNICAL FEATURES

Insulation:

Polyamide 66 reinforced with 30% fiberglass
 Halogen Free
 Self-extinguishing: V0-UL94
 Glow wire test: 960° C
 Color: Black

Threaded inserts:

Galvanized steel

Finished product:

Rated voltage: 1000 V AC/1500 V DC
 Working temperature: - 40 ÷ 130° C



file n° 300607

R.T. = Tensile strength

R.C. = Compressive strength

R.F. = Flexural strength

Code	Reference		Weight (Kg)	CH (mm)	D (mm)	H (mm)	M	F (mm)		R.T. (daN)	R.C. (daN)	R.F. (daN)
ISO2120	CLN 16M4-20	50	0,014	21	20	16	M4	5	3	200	4200	100
ISO2125	CLN 16M5-20	50	0,014				M5	5	6	300	4200	150
ISO2130	CLN 16M6-20	50	0,014				M6	5	6	350	4200	150
ISO2135	CLN 20M5-20	50	0,015			20	M5	5	6	400	4500	200
ISO2140	CLN 20M6-20	50	0,015				M6	5	8	450	4500	280
ISO2145	CLN 25M4-20	50	0,016			25	M4	5	3	300	4700	150
ISO2150	CLN 25M5-20	50	0,017				M5	5	6	400	4700	200
ISO2155	CLN 25M6-20	50	0,018				M6	5	8	550	4700	350
ISO2160	CLN 25M8-20	50	0,018			30	M8	5	25	550	4700	350
ISO2165	CLN 30M5-20	50	0,027				M5	9	6	700	5000	370
ISO2170	CLN 30M6-20	50	0,026				M6	9	10	700	5000	370
ISO2175	CLN 30M8-20	50	0,024			35	M8	9	25	700	5000	370
ISO2180	CLN 35M5-20	50	0,030				M5	9	6	700	5000	350
ISO2185	CLN 35M6-20	50	0,029				M6	9	10	800	5000	350
ISO2190	CLN 35M8-20	50	0,026			40	M8	9	25	800	5000	350
ISO2195	CLN 40M5-20	50	0,030				M5	9	6	800	5000	300
ISO2200	CLN 40M6-20	50	0,030				M6	9	10	800	5000	300
ISO2205	CLN 40M8-20	50	0,028			45	M8	9	25	800	5000	300
ISO2210	CLN 45M5-20	25	0,033				M5	9	6	800	4700	260
ISO2215	CLN 45M6-20	25	0,031				M6	9	10	800	4700	260
ISO2220	CLN 45M8-20	25	0,030			50	M8	9	25	800	4700	260
ISO2225	CLN 50M5-20	25	0,032				M5	9	6	800	4500	220
ISO2230	CLN 50M6-20	25	0,034				M6	9	10	800	4500	220
ISO2235	CLN 50M8-20	25	0,033			30	30	30	M8	9	25	800
ISO2240	CLN 30M6-30	50	0,039	M6	11				10	1000	7000	500
ISO2245	CLN 30M8-30	50	0,037	M8	11			25	1200	8000	550	
ISO2250	CLN 35M6-30	50	0,041	35	M6			11	10	1100	7500	500
ISO2255	CLN 35M8-30	50	0,039		M8			11	25	1400	8500	550
ISO2256	CLN 40M6-30	25	0,061	40	M6			11	10	1100	7500	450
ISO2257	CLN 40M8-30	25	0,061		M8			11	25	1400	8500	480
ISO2260	CLN 45M6-30	25	0,082	45	M6			15	10	1200	9000	420
ISO2265	CLN 45M8-30	25	0,078		M8			15	25	1600	9000	420
ISO2266	CLN 50M6-30	25	0,087	50	M6			15	10	1200	8000	380
ISO2267	CLN 50M8-30	25	0,083		M8			15	25	1600	8000	380
ISO2270	CLN 55M6-30	25	0,094	55	M6			15	10	1100	7500	350
ISO2275	CLN 55M8-30	25	0,091		M8	15	25	1300	7500	350		
ISO2280	CLN 65M6-30	25	0,104	65	M6	15	10	950	7000	300		
ISO2285	CLN 65M8-30	25	0,104		M8	15	25	950	7000	300		
ISO2290	CLN 70M6-30	25	0,109	70	M6	15	10	900	6500	280		
ISO2295	CLN 70M8-30	25	0,098		M8	15	25	900	6500	280		