



4NO CONTACTOR, AC1: 40A AC 110V 50HZ 4-POLE, 4NO, SZ: S0, SCREW TERMINAL 1NO+1NC INTEGR.

product brand name	SIRIUS
Product designation	3RT2 contactor
General technical data:	
Product expansion function module for communication	No
Insulation voltage	
• Rated value	690 V
maximum permissible voltage for safe isolation between coil and main contacts acc. to EN 60947-1	400 V
Degree of pollution	3
Shock resistance	
• at rectangular impulse	
— with AC	8,3g / 5 ms, 5,3g / 10 ms
• with sine pulse	
— with AC	13,5g / 5 ms, 8,3g / 10 ms
Surge voltage resistance Rated value	6 kV
Mechanical service life (switching cycles)	
• of the contactor typical	10 000 000
• of the contactor with added electronics-compatible auxiliary switch block typical	5 000 000
• of the contactor with added auxiliary switch block typical	10 000 000
Thermal short-time current restricted to 10 s	200 A
Protection class IP	
• on the front	IP20

• of the terminal	IP20
Equipment marking	
• acc. to DIN EN 61346-2	Q
• acc. to DIN EN 81346-2	Q
Main circuit:	
Number of poles for main current circuit	4
Number of NC contacts for main contacts	0
Number of NO contacts for main contacts	4
Operating voltage	
• at AC-3 Rated value maximum	690 V
Operating current	
• at AC-1	
— at 400 V at ambient temperature 40 °C Rated value	40 A
— up to 690 V at ambient temperature 40 °C Rated value	40 A
— up to 690 V at ambient temperature 60 °C Rated value	35 A
• at AC-2 at 400 V Rated value	17 A
• at AC-3	
— at 400 V Rated value	15.5 A
• at AC-4 at 400 V Rated value	15.5 A
Operating current with 1 current path	
• at DC-1	
— at 24 V Rated value	35 A
— at 110 V Rated value	4.5 A
— at 220 V Rated value	1 A
— at 440 V Rated value	0.4 A
• at DC-3 at DC-5	
— at 24 V Rated value	20 A
— at 110 V Rated value	2.5 A
— at 220 V Rated value	1 A
— at 440 V Rated value	0.09 A
Operating current with 2 current paths in series	
• at DC-1	
— at 24 V Rated value	35 A
— at 110 V Rated value	35 A
— at 220 V Rated value	1 A
— at 440 V Rated value	1 A
• at DC-3 at DC-5	
— at 110 V Rated value	15 A
— at 220 V Rated value	3 A

— at 24 V Rated value	35 A
— at 440 V Rated value	0.27 A
Operating current with 3 current paths in series	
• at DC-1	
— at 24 V Rated value	35 A
— at 110 V Rated value	35 A
— at 220 V Rated value	35 A
— at 440 V Rated value	2.9 A
• at DC-3 at DC-5	
— at 110 V Rated value	35 A
— at 220 V Rated value	10 A
— at 24 V Rated value	35 A
— at 440 V Rated value	0.6 A
Operating power	
• at AC-1	
— at 230 V at 60 °C Rated value	13 kW
— at 400 V at 60 °C Rated value	23 kW
Active power loss at AC-3 at 400 V for rated value of the operating current per conductor	1.6 W
Operating frequency	
• at AC-1 maximum	1 000 1/h
• at AC-2 maximum	750 1/h
• at AC-3 maximum	750 1/h
• at AC-4 maximum	250 1/h
No-load switching frequency	
• with AC	5 000 1/h
Control circuit/ Control:	
Type of voltage of the control supply voltage	AC
Control supply voltage with AC	
• at 50 Hz Rated value	110 V
Operating range factor control supply voltage rated value of the magnet coil with AC	
• at 50 Hz	0.8 ... 1.1
• at 60 Hz	0.85 ... 1.1
Apparent pick-up power of the magnet coil with AC	
• at 50 Hz	77 V·A
Inductive power factor with closing power of the coil	
• at 50 Hz	0.82
Apparent holding power of the magnet coil with AC	
• at 50 Hz	9.8 V·A
Inductive power factor with the holding power of the coil	

<ul style="list-style-type: none"> • at 50 Hz 	0.25
Closing delay	
<ul style="list-style-type: none"> • with AC 	8 ... 40 ms
Opening delay	
<ul style="list-style-type: none"> • with AC 	4 ... 16 ms
Arcing time	10 ... 10 ms

Auxiliary circuit:

Number of NC contacts	
<ul style="list-style-type: none"> • for auxiliary contacts <ul style="list-style-type: none"> — instantaneous contact 	1
Number of NO contacts	
<ul style="list-style-type: none"> • for auxiliary contacts <ul style="list-style-type: none"> — instantaneous contact 	1
Product expansion Auxiliary switch	Yes
Operating current at AC-12 maximum	10 A
Operating current at AC-15	
<ul style="list-style-type: none"> • at 230 V Rated value • at 400 V Rated value • at 690 V Rated value 	10 A 3 A 1 A
Operating current at DC-12	
<ul style="list-style-type: none"> • at 60 V Rated value • at 110 V Rated value • at 125 V Rated value • at 220 V Rated value • at 600 V Rated value 	6 A 3 A 2 A 1 A 0.15 A
Operating current at DC-13	
<ul style="list-style-type: none"> • at 24 V Rated value • at 60 V Rated value • at 110 V Rated value • at 125 V Rated value • at 220 V Rated value • at 600 V Rated value 	10 A 2 A 1 A 0.9 A 0.3 A 0.1 A
Contact reliability of the auxiliary contacts	1 faulty switching per 100 million (17 V, 1 mA)

UL/CSA ratings:

Full-load current (FLA) for three-phase AC motor	
<ul style="list-style-type: none"> • at 480 V Rated value • at 600 V Rated value 	14 A 17 A
yielded mechanical performance [hp]	
<ul style="list-style-type: none"> • for single-phase AC motor <ul style="list-style-type: none"> — at 110/120 V Rated value — at 230 V Rated value 	1 hp 3 hp

<ul style="list-style-type: none"> • for three-phase AC motor <ul style="list-style-type: none"> — at 200/208 V Rated value — at 220/230 V Rated value — at 460/480 V Rated value — at 575/600 V Rated value 	<p>3 hp</p> <p>5 hp</p> <p>10 hp</p> <p>15 hp</p>
Contact rating of the auxiliary contacts acc. to UL	A600 / Q600

Short-circuit:

Design of the fuse link <ul style="list-style-type: none"> • for short-circuit protection of the main circuit <ul style="list-style-type: none"> — with type of assignment 1 required — with type of assignment 2 required • for short-circuit protection of the auxiliary switch required 	<p>gL/gG LV HRC 3NA, DIAZED 5SB, NEOZED 5SE: 63 A</p> <p>gL/gG LV HRC 3NA, DIAZED 5SB, NEOZED 5SE: 25 A</p> <p>fuse gL/gG: 10 A</p>
--	---

Installation/ mounting/ dimensions:

mounting position	+/-180° rotation possible on vertical mounting surface; can be tilted forward and backward by +/- 22.5° on vertical mounting surface
Mounting type <ul style="list-style-type: none"> • Side-by-side mounting 	<p>screw and snap-on mounting onto 35 mm standard mounting rail according to DIN EN 50022</p> <p>Yes</p>
Height	85 mm
Width	61 mm
Depth	97 mm
Required spacing <ul style="list-style-type: none"> • with side-by-side mounting <ul style="list-style-type: none"> — forwards — Backwards — upwards — downwards — at the side • for grounded parts <ul style="list-style-type: none"> — forwards — Backwards — upwards — at the side — downwards • for live parts <ul style="list-style-type: none"> — forwards — Backwards — upwards — downwards 	<p>0 mm</p> <p>0 mm</p> <p>0 mm</p> <p>0 mm</p> <p>0 mm</p> <p>0 mm</p> <p>0 mm</p> <p>0 mm</p> <p>0 mm</p> <p>6 mm</p> <p>0 mm</p> <p>0 mm</p> <p>0 mm</p> <p>0 mm</p> <p>0 mm</p> <p>0 mm</p> <p>0 mm</p>

— at the side

6 mm

Connections/ Terminals:

Type of electrical connection	
• for main current circuit	screw-type terminals
• for auxiliary and control current circuit	screw-type terminals
Type of connectable conductor cross-section	
• for main contacts	
— single or multi-stranded	2x (1 ... 2,5 mm ²), 2x (2,5 ... 10 mm ²)
— finely stranded with core end processing	2x (1 ... 2.5 mm ²), 2x (2.5 ... 6 mm ²), 1x 10 mm ²
• for AWG conductors for main contacts	2x (16 ... 12), 2x (14 ... 8)
• for auxiliary contacts	
— single or multi-stranded	2x (0,5 ... 1,5 mm ²), 2x (0,75 ... 2,5 mm ²)
— finely stranded with core end processing	2x (0.5 ... 1.5 mm ²), 2x (0.75 ... 2.5 mm ²)
• for AWG conductors for auxiliary contacts	2x (20 ... 16), 2x (18 ... 14)

Safety related data:

B10 value with high demand rate acc. to SN 31920	1 000 000
Proportion of dangerous failures	
• with low demand rate acc. to SN 31920	40 %
• with high demand rate acc. to SN 31920	73 %
Product function	
• Mirror contact acc. to IEC 60947-4-1	Yes
T1 value for proof test interval or service life acc. to IEC 61508	20 y
Protection against electrical shock	finger-safe

Mechanical data:

Size of contactor	S0
--------------------------	----

Ambient conditions:

Installation altitude at height above sea level maximum	2 000 m
Ambient temperature	
• during operation	-25 ... +60 °C
• during storage	-55 ... +80 °C

Certificates/ approvals:

General Product Approval	EMC	Functional Safety/Safety of Machinery
--------------------------	-----	---------------------------------------



[Type Examination](#)

Declaration of Conformity	Test Certificates	Shipping Approval
---------------------------	-------------------	-------------------



[Type Test Certificates/Test Report](#)

[Special Test Certificate](#)



Shipping Approval	other
-------------------	-------



[Environmental Confirmations](#)

other

[Confirmation](#)



Further information

Information- and Downloadcenter (Catalogs, Brochures,...)

<http://www.siemens.com/industrial-controls/catalogs>

Industry Mall (Online ordering system)

<http://www.siemens.com/industrymall>

Cax online generator

<http://support.automation.siemens.com/WW/CAXorder/default.aspx?lang=en&mlfb=3RT23261AF00>

Service&Support (Manuals, Certificates, Characteristics, FAQs,...)

<https://support.industry.siemens.com/cs/ww/en/ps/3RT23261AF00>

Image database (product images, 2D dimension drawings, 3D models, device circuit diagrams, EPLAN macros, ...)

http://www.automation.siemens.com/bilddb/cax_de.aspx?mlfb=3RT23261AF00&lang=en

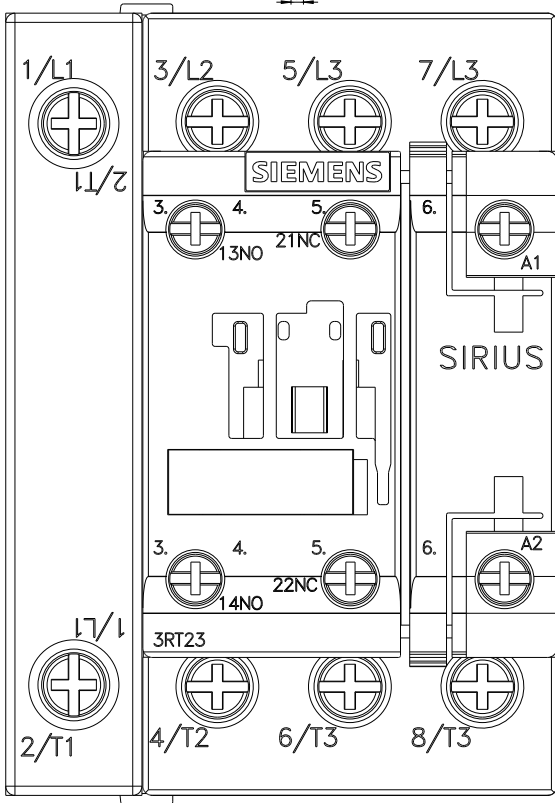
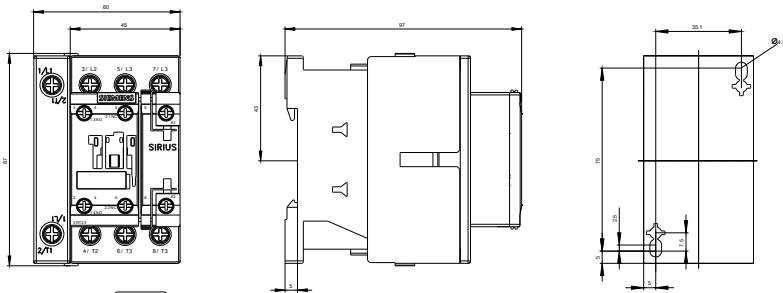

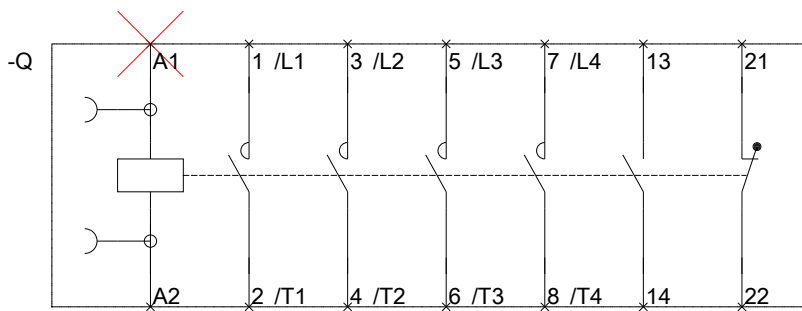

last modified:

14.05.2015