

# dimensions of din-rail equipment

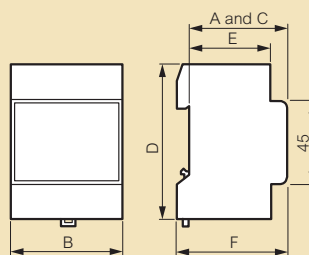
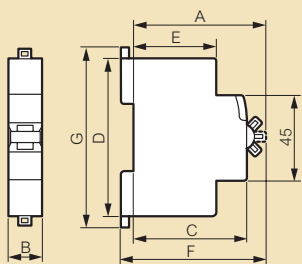

	A		B				C	D	E	F	G
	1-pole	1-pole + N	2-pole	3-pole	4-pole						
<b>Thermal-magnetic MCBs</b>											
<b>RX<sup>3</sup>, DX<sup>3</sup></b>	70		17.7	35.4	53.1	70.5	60	83	44	76	94
<b>1 module per pole</b>											
<b>DX<sup>3</sup></b>	70	26.7		53.4	80.1	106.8	60	100	44	76	103
<b>1.5 module per pole</b>											
<b>Motor MCBs</b>	82.5			44.5			72.2	89	44	87.3	91
<b>Earth leakage modules up to 63 A</b>	70			35.6	53.4	53.4	60	93	44	76	99
<b>from 80 to 125 A</b>	70			71.1	107.2	107.2	60	88	44	76	89
<b>RCBOs</b>	70	17.7	35.6	71.2		124.6	60	83	44	76	94
<b>4-pole RCBOs with 4 modules</b>	70					71.2	60	83	44	76	94
<b>RCDs (RX<sup>3</sup>, LR, DX<sup>3</sup>-ID)</b>											
<b>2-pole</b>	70			35.6			60	83	44	76	94
<b>4-pole</b>	71.5					71.2	60	83	44	77.5	94
<b>Fuse carriers</b>	67	17.7	17.7	35.6	53.4	71.2	60	83	44	73	94
<b>Auxiliary contacts</b>											
<b>Cat.Nos 4 062 58/60/62</b>	70			8.7			60	83	44	76	83
<b>Cat.No 4 062 66</b>	70			17.7			60	83	44	76	83
<b>Control auxiliaries</b>	70			17.7			60	83	44	76	83
<b>Remote control Cat.No 073 73</b>	74			54			74	83	44	80.5	89
<b>STOP &amp; GO</b>	74			54			74	83	44	80.5	102
<b>DX<sup>3</sup>-IS remote trip head isolating switches</b>											
<b>40-63 A</b>	71.7			35.4	53.1	70.8	60.9	83	44.2	77.9	95.35
<b>100-125 A</b>	73				80.1	106.8	60.3	95	47	79.2	127.5
<b>DX<sup>3</sup>-IS isolating switches</b>											
<b>4 064 31/32/34/36/38/39/57/59/77/79</b>	70.2			17.8	35.6	35.6	60.9	83	44.2	76.4	94.8
<b>4 064 00/01/03/04/06/11/12/23/40/41/60/61/80/81</b>	70.2	17.7		35.4	53.1	70.8	60.9	83	44.2	76.4	94.8
<b>4 064 49/50/69/70/89/90</b>	70.2	17.7		35.4	53.1	70.8	60.9	83	44.2	76.4	94.8
<b>Changeover switches</b>											
<b>Cat.Nos 0 043 82/85</b>	68			17.7			60	83	44	74	94
<b>Cat.Nos 0 043 83/86</b>	68			35.6			60	83	44	74	94
<b>Push-buttons/control switches</b>	68			17.7			60	83	44	74	94
<b>Indicators</b>	63			17.7			60	83	44	69	94
<b>Pulse operated latching relays</b>	64	17.8		17.8		35.6	61	83	44	70	95
<b>Light sensitive switches</b>											
<b>Cat.Nos 0 037 21, 4 126 23</b>	60			35.6			60	85	37.5	66	70
<b>Sockets outlets</b>	60			44.5			60	83	44	66	92
<b>Buzzers/bells</b>	60			17.5			60	76	44	66	85
<b>Time lag switch 0 047 02/04</b>	60			17.8			60	94	44	66	94
<b>Time delay relays</b>	60			17.7			60	83	44	66	94
<b>Remote control dimmers</b>											
<b>Cat.Nos 0 036 58/59/80</b>	60			36			60	83	44	66	94
<b>Cat.No 0 036 60</b>	60			72			60	83	44	66	94
<b>Cat.No 0 036 71</b>	60			108			60	83	44	66	94
<b>Voltage surge protectors</b>											
<b>0 030 00</b>	73	35.4					73	150	44	80	150
<b>0 030 22/23</b>	64	35.6			106.8	142.4	64	90	44	71.5	97
<b>0 039 10</b>	60			35.6	53.4	71.2	60	86	44	68	91
<b>0 039 20 to 23</b>	60	17.7		35.6	53.4	71.2	60	86	44	68	91
<b>0 039 30 to 33</b>	60	17.7		35.6	53.4	71.2	60	86	44	68	91
<b>0 039 40/41/43</b>	60	17.7		35.6		71.2	60	86	44	68	91
<b>0 038 28/29</b>	60	17.7					60	86	44	68	91

Description	A	B	C	D	E	F
<b>Programmable time switches</b>						
<b>0 037 05</b>	60	17.8	60	83	44	66
<b>4 127 80/90/94</b>	60	17.8	60	83	44	66
<b>4 127 95, 4 128 12/13</b>	60	53	60	83	44	66
<b>4 126 31/33/41</b>	60	35.6	60	83	44	66
<b>4 126 54/57</b>	60	35.6	60	83	44	66
<b>0 047 70</b>	60	90	60	83	44	66
<b>Voltmeters - Ammeters</b>	60	70	60	83	44	66
<b>Contactors - 1 module 16 and 25 A</b>	62	17.8	60	83	44	67.5
<b>Contactors 25, 40 and 63 A</b>						
<b>2 modules</b>	60	35.6	61	83	44	67
<b>3 modules</b>	60	54	61	83	44	67
<b>Contactors 100 A 6 modules</b>	60	90	60	83	44	66
<b>Auxiliaries for contactors and pulse operated latching relays</b>	60	9	60	83	44	66
<b>Transformers and power supplies</b>						
<b>0 042 10/30/31</b>	60	72	60	83	44	66
<b>4 130 91</b>	60	35.8	60	83.5	44	66
<b>4 130 92/93/96</b>	60	71.5	60	83.5	44	66
<b>4 130 98</b>	60	89	60	94	44	66
<b>0 047 91/92</b>	60	105	60	95	44	66
<b>4 131 05/06/07/08</b>	60	89	60	95	44	66
<b>0 047 93</b>	60	70	60	95	44	66
<b>Electrical energy metering</b>						
<b>0 046 73/74</b>	60	72	60	81	44	66
<b>0 046 81/72</b>	60	35.5	60	89	44	66
<b>Central measuring unit</b>						
<b>0 046 75/76</b>	64	105	64	89.5	44	69
<b>Residual current relay</b>						
<b>0 260 88</b>	60	35.5	60	89	44	66